

**Features**

- SUBMINIATURE PACKAGE.
- WIDE VIEWING ANGLE.
- Z-BEND LEAD.
- LONG LIFE-SOLID STATE RELIABILITY.
- LOW PACKAGE PROFILE.
- PACKAGE : 1000PCS / REEL.
- MOISTURE SENSITIVITY LEVEL : LEVEL 3.
- RoHS COMPLIANT.



Notes:

1. All dimensions are in millimeters (inches).
2. Tolerance is  $\pm 0.25(0.01")$  unless otherwise noted.
- 3.Specifications are subject to change without notice.

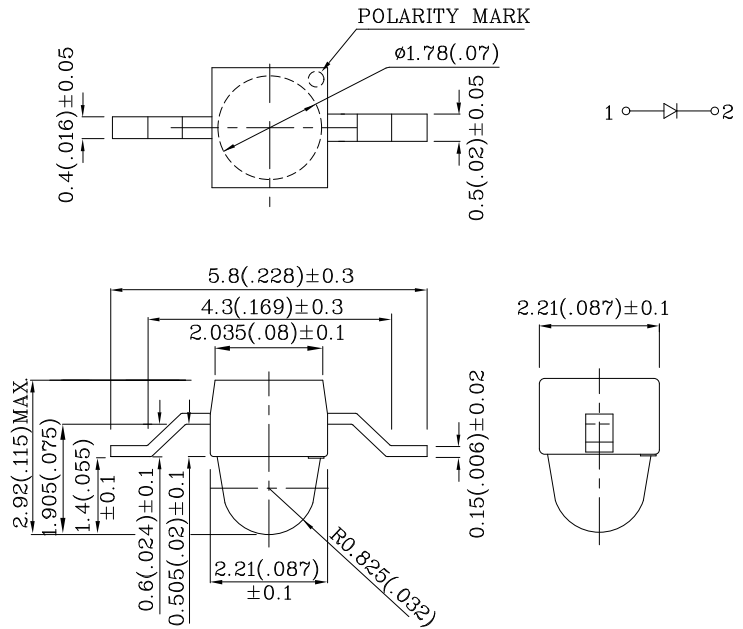

| Absolute Maximum Ratings<br>(TA=25°C)                          |      | UY<br>(GaAsP/GaP) | Unit |
|--|------|-------------------|------|
| Reverse Voltage  | VR   | 5                 | V    |
| Forward Current  | IF   | 30                | mA   |
| Forward Current (Peak)<br>1/10 Duty Cycle<br>0.1ms Pulse Width | iFS  | 140               | mA   |
| Power Dissipation  | PT   | 75                | mW   |
| Operating Temperature  | TA   | -40 ~ +85         | °C   |
| Storage Temperature  | Tstg | -40 ~ +85         |      |

| Operating Characteristics<br>(TA=25°C)                          |                 | UY<br>(GaAsP/GaP) | Unit |
|---|-----------------|-------------------|------|
| Forward Voltage (Typ.)<br>(IF=20mA)                             | VF              | 2.1               | V    |
| Forward Voltage (Max.)<br>(IF=20mA)                             | VF              | 2.5               | V    |
| Reverse Current (Max.)<br>(VR=5V)                               | IR              | 10                | uA   |
| Wavelength of Peak<br>Emission (Typ.)<br>(IF=20mA)              | $\lambda P$     | 590               | nm   |
| Wavelength of Dominant<br>Emission (Typ.)<br>(IF=20mA)          | $\lambda D$     | 588               | nm   |
| Spectral Line Full Width<br>At Half-Maximum (Typ.)<br>(IF=20mA) | $\Delta\lambda$ | 35                | nm   |
| Capacitance (Typ.)<br>(VF=0V, f=1MHz)                           | C               | 20                | pF   |

| Part<br>Number | Emitting<br>Color | Emitting<br>Material | Lens-color  | Luminous<br>Intensity<br>(IF=20mA)<br>mcd |      | Wavelength<br>nm<br>$\lambda P$ | Viewing<br>Angle<br>$2 \theta 1/2$ |
|----------------|-------------------|----------------------|-------------|---|------|---------------------------------|------------------------------------|
|                |                   |                      |             | min.                                      | typ. |                                 |                                    |
| XZUY64W-9      | Yellow            | GaAsP/GaP            | Water Clear | 10  | 29   | 590                             | 20°                                |

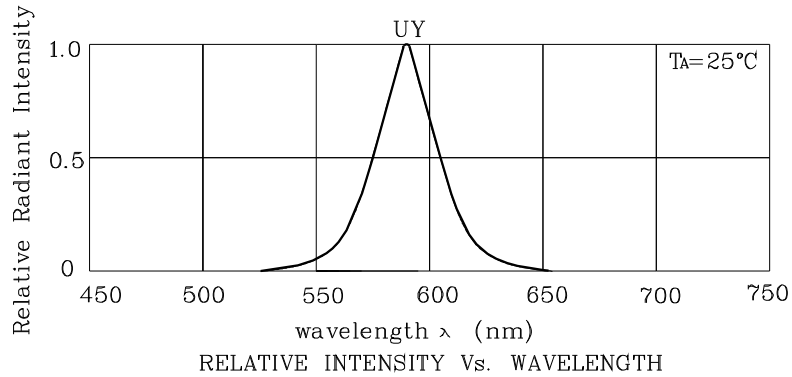

❖ UY

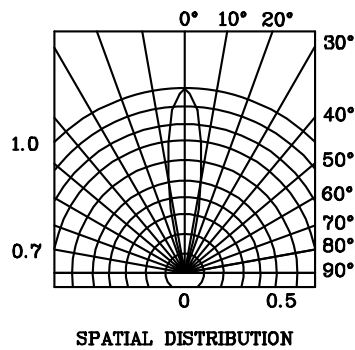
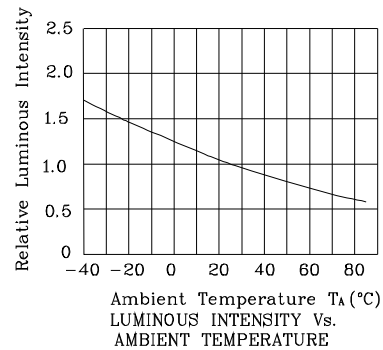
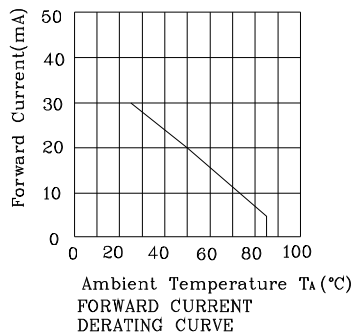
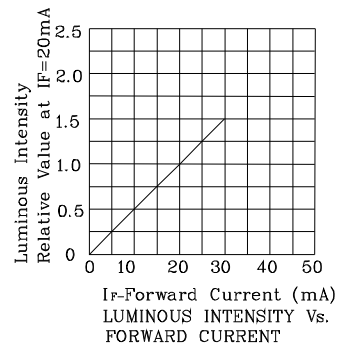
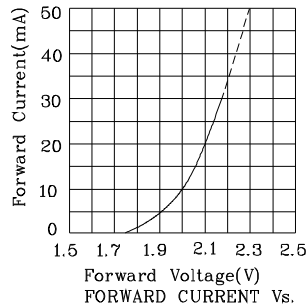

Reflow Soldering Profile For Lead-free SMT Process.

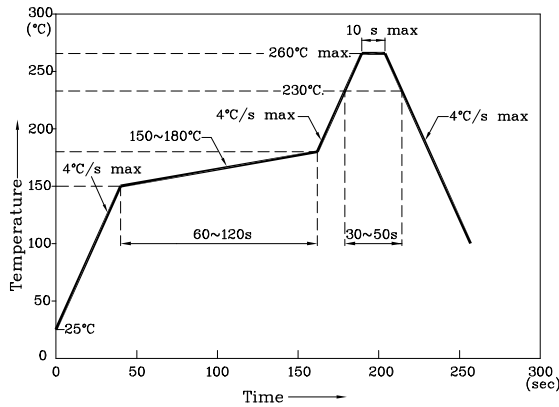

NOTES:

1. Maximum soldering temperature should not exceed 260°C.
2. Recommended reflow temperature: 145°C-260°C.
3. Do not put stress to the epoxy resin during high temperatures conditions.

❖ Recommended Soldering Pattern  
(Units : mm; Tolerance:± 0.1)

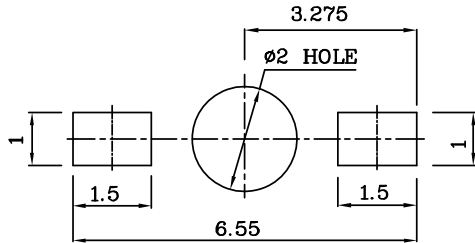

❖ The device has a single mounting surface. The device must be mounted according to the specifications.

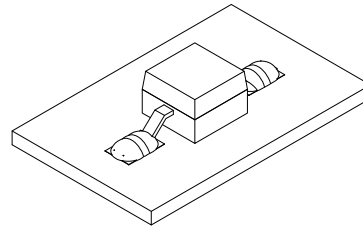

❖ Tape Specification (Units : mm)

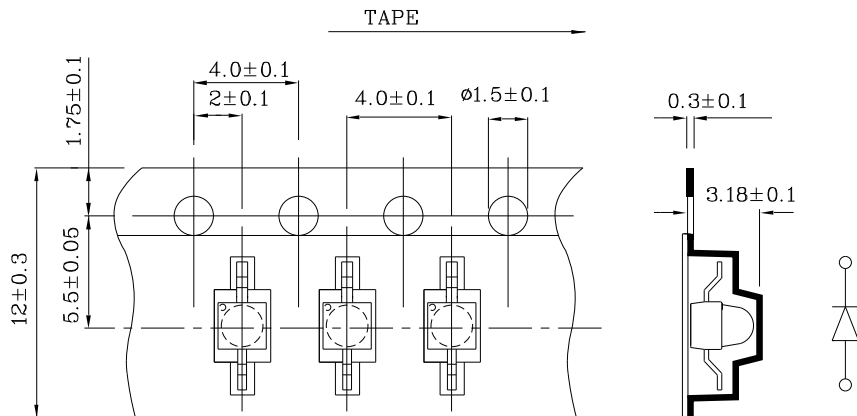

Remarks:



If special sorting is required (e.g. binning based on forward voltage, Luminous intensity / luminous flux, or wavelength), the typical accuracy of the sorting process is as follows:



1. Wavelength: +/-1nm
2. Luminous intensity / luminous flux: +/-15%
3. Forward Voltage: +/-0.1V

Note: Accuracy may depend on the sorting parameters.

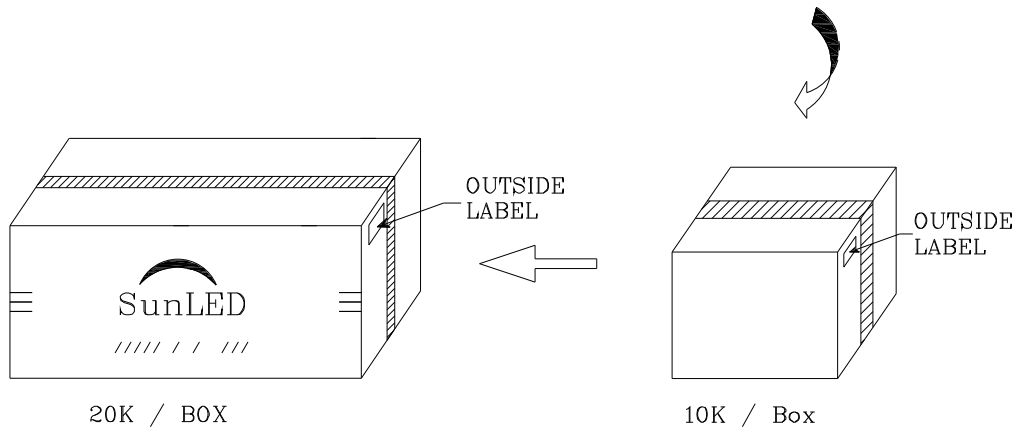
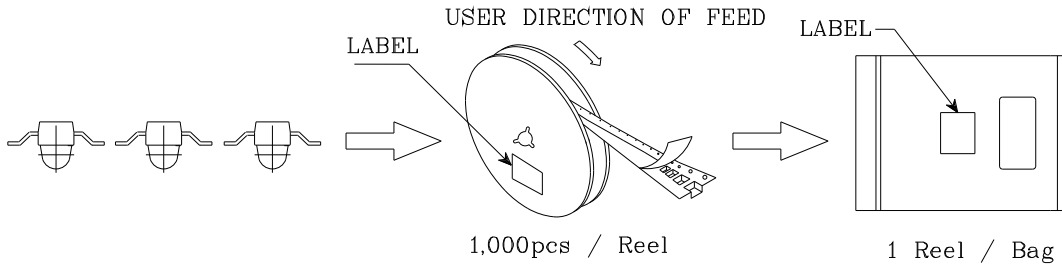
**PACKING & LABEL SPECIFICATIONS**

**XZUY64W-9**

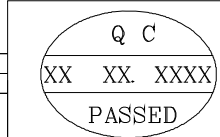
|  |           |
|--|-----------|
|                              |           |
| P/NO : XZxx64x-9   |           |
| QTY : 1,000 pcs  | CODE: XXX |
| S/N : XX   |           |
| LOT NO:  |           |
| <br>XXXXXXXXXXXXXXXXXXXXXXXX |           |
| RoHS Compliant   |           |