

### Main

|                               |  |
|-------------------------------|--|
| Range of product              | Harmony XB4                            |
| Product or component type     | Complete emergency stop push-button    |
| Device short name             | XB4                                    |
| Bezel material                | Chromium plated metal                  |
| Fixing collar material        | Zamak                                  |
| Mounting diameter             | 0.87 in (22 mm)                        |
| Sale per indivisible quantity | 1                                      |
| Dust zone                     | Zone 21 - 22                           |
| Gas zone                      | Zone 1 - 2                             |
| Type of operator              | Trigger action and mechanical latching |
| Reset                         | Push-pull                              |
| Operator profile              | Red mushroom Ø 40 mm                   |
| Contacts type and composition | 1 NO + 1 NC                            |

### Complementary

|   |  |
|---|--|
| Maximum Width                               | 1.82 in (46.2 mm)  |
| Height                                      | 1.18 in (30 mm)  |
| Depth                                       | 3.80 in (96.5 mm)  |
| Net Weight                                  | 0.31 lb(US) (0.142 kg)   |
| Device mounting                             | Fixing hole 0.89 in (22.5 mm) +/- 0.2 mm EN/IEC 60947-1  |
| Fixing center                               | >= 30 x 40 mm support panel) 0.04...0.24 in (1...6 mm)   |
| Embedding depth                             | 2.28 in (58 mm)  |
| Marking                                     | II 2 GD<br>Ex tb IIIC Db<br>Ex db eb IIC Gb  |
| Shape of signaling unit head                | Round  |
| Contact operation                           | Slow-break   |
| Contacts usage                              | Standard   |
| Positive opening                            | With conforming to EN/IEC 60947-5-1 appendix K   |
| Mechanical durability                       | 5000000 cycles   |
| Connections - terminals                     | Screw clamp terminals, 2 x 1.5 mm <sup>2</sup> with cable end EN/IEC 60947-1<br>Screw clamp terminals, 1 x 2.5 mm <sup>2</sup> without cable end EN/IEC 60947-1  |
| Tightening torque                           | 7.08...10.62 lbf.in (0.8...1.2 N.m) EN 60947-1   |
| [Ith] conventional free air thermal current | 10 A EN/IEC 60947-5-1  |
| [Ui] rated insulation voltage               | 415 V  |
| [Ie] rated operational current              | 1.9 A 380 V, AC, A600 EN/IEC 60947-5-1<br>3 A 240 V, AC, A600 EN/IEC 60947-5-1<br>6 A 120 V, AC, A600 EN/IEC 60947-5-1<br>0.27 A 250 V, DC, Q300 EN/IEC 60947-5-1<br>0.55 A 125 V, DC, Q300 EN/IEC 60947-5-1<br>2.87 A 24 V, DC, Q300 EN/IEC 60947-5-1 |

## Environment

|                                       |   |
|---------------------------------------|---|
| Protective treatment                  | TH  |
| Ambient air temperature for storage   | -40...158 °F (-40...70 °C)  |
| Ambient air temperature for operation | -4...149 °F (-20...65 °C)   |
| IP degree of protection               | IP65 IEC 60529  |
| Standards                             | EN/IEC 60079-0:2009<br>EN/IEC 60079-1:2009<br>EN/IEC 60079-7:2009<br>EN/IEC 60079-31:2009<br>UL 60079-0<br>UL 60079-1<br>UL 60079-31<br>ANSI/ISA 12.12.01<br>CSA C22.2 No 213 |
| Product certifications                | INERIS 04ATEX9004U  |

## Ordering and shipping details

|                       |                                   |
|-----------------------|-----------------------------------|
| Category              | 22465 - PUSHBUTTONS, 22MM HAZ LOC |
| Discount Schedule     | CS2                               |
| GTIN                  | 03606489486051                    |
| Nbr. of units in pkg. | 1                                 |
| Package weight(Lbs)   | 1 lb(US) (0.45 kg)                |
| Returnability         | Yes                               |

## Packing Units

|                        |                  |
|------------------------|------------------|
| Unit Type of Package 1 | PCE              |
| Package 1 Height       | 3.78 in (9.6 cm) |
| Package 1 width        | 1.18 in (3 cm)   |
| Package 1 Length       | 1.81 in (4.6 cm) |

## Offer Sustainability

|                            |   |
|----------------------------|---|
| Sustainable offer status   | Green Premium product   |
| California proposition 65  | WARNING: This product can expose you to chemicals including: Di-isodecyl phthalate (DIDP), which is known to the State of California to cause birth defects or other reproductive harm. For more information go to <a href="http://www.P65Warnings.ca.gov">www.P65Warnings.ca.gov</a> |
| REACH Regulation           | <a href="#">REACH Declaration</a>   |
| REACH free of SVHC         | Yes   |
| EU RoHS Directive          | Pro-active compliance (Product out of EU RoHS legal scope) <a href="#">EU RoHS Declaration</a>  |
| Toxic heavy metal free     | Yes   |
| Mercury free               | Yes   |
| RoHS exemption information | <a href="#">Yes</a>   |
| China RoHS Regulation      | <a href="#">China RoHS Declaration</a>  |
| Environmental Disclosure   | <a href="#">Product Environmental Profile</a>   |
| Circularity Profile        | <a href="#">End Of Life Information</a>   |
| WEEE                       | The product must be disposed on European Union markets following specific waste collection and never end up in rubbish bins.  |

Dimensions

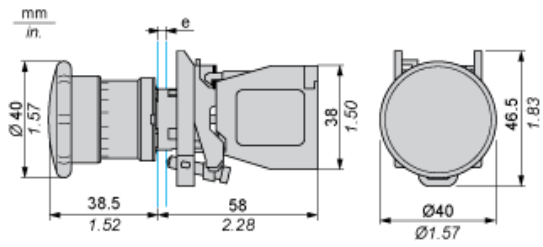

e : support thickness: 1 to 6 mm / 0.04 to 0.24 in.

---

Panel Cut-out for Pushbuttons, Switches and Pilot Lights (Finished Holes, Ready for Installation)

---

Connection by Screw Clamp Terminals

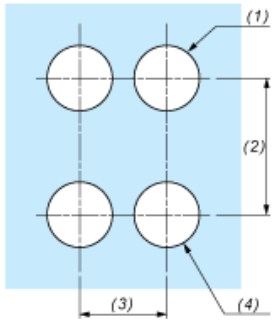

- (1) Diameter on finished panel or support
- (2) 40 mm min. / 1.57 in. min.
- (3) 30 mm min. / 1.18 in. min.
- (4)  $\varnothing 22.5 \text{ mm} / 0.89 \text{ in. recommended } (\varnothing 22.3 \text{ mm }_0^{+0.4} / 0.88 \text{ in. }_0^{+0.016})$