

# SHJ CONNECTOR

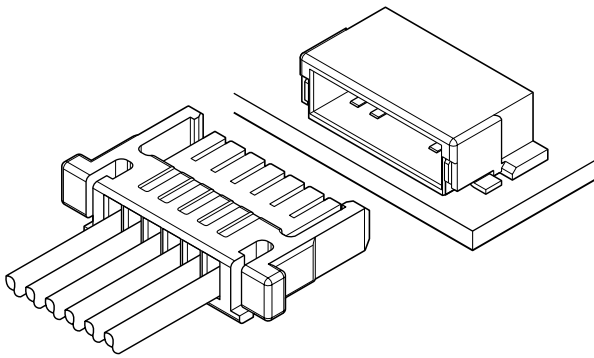

1.0mm pitch/Disconnectable Crimp style connectors



**This is a wire to board connector with secure locking device used for power supply of LED.**

- Low profile design
- Secure locking structure
- Halogen-free

## Specifications

- Current rating: 1.0 A AC, DC (AWG #28)
- Voltage rating: 125 V AC, DC
- Temperature range: -25°C to +85°C  
(including temperature rise in applying electrical current)
- Contact resistance: Initial value/ 20 mΩ max.  
After environmental tests/ 40 mΩ max.
- Insulation resistance: 100 MΩ min.
- Withstanding voltage: 500 VAC/minute
- Applicable wire: Conductor size/ AWG #32 to #28  
Insulation O.D./ 0.54 to 0.8 mm

\* Refer to "General Instruction and Notice when using Terminals and Connectors" at the end of this catalog.

\* Contact JST for details.

\* Compliant with RoHS.

## Standards

Recognized E 60389

## PC board layout and Assembly layout

### Top entry type

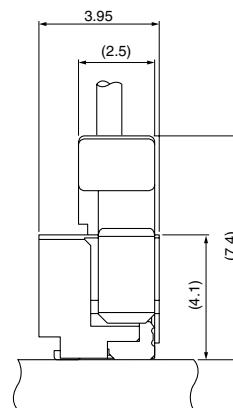
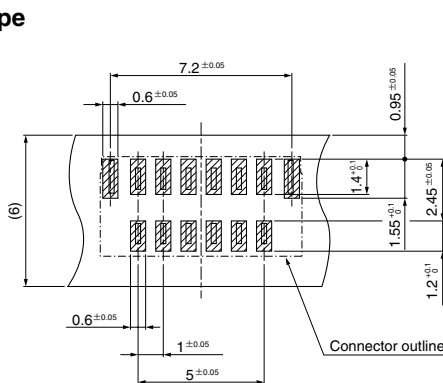

### Side entry type

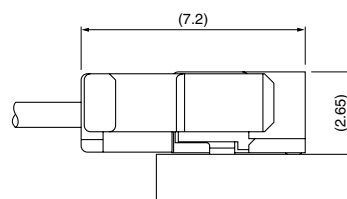
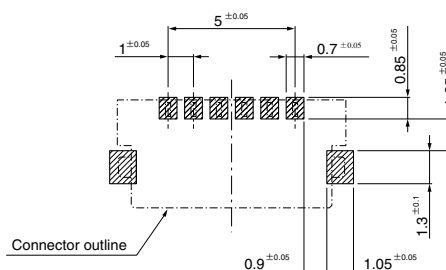

Note: 1. The above figure is the figure viewed from the connector mounting side.  
2. Tolerances are non-cumulative: ±0.05 mm for all centers.  
The dimensions above should serve as a guideline. Contact JST for details.

# SHJ CONNECTOR

## Contact

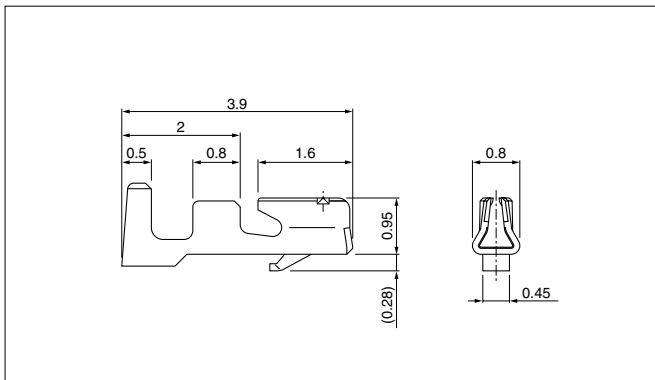

Model No.	Applicable wire		Insulation O.D. (mm)	Q'ty/reel
	mm <sup>2</sup>	AWG#		
<b>SSHJ-003T-P0.2</b>	0.032~0.08	32~28	0.54~0.8	28,000

### Material and Finish

Phosphor bronze, tin-plated (reflow treatment)

### RoHS compliance

Contact	Crimping machine	Applicator		
		Crimp applicator	Dies	Crimp applicator with dies
<b>SSHJ-003T-P0.2</b>	AP-K2N	MKS-L-10-3	MK/SSH/L-003-02	APLMK SSH/L003-02

Note: SHJ connector can be crimped by our genuine dies for the existing SH connector contact.

## Housing

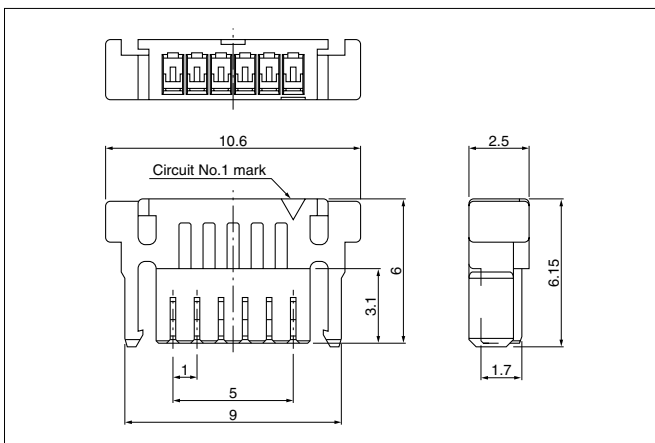

Circuits	Model No.	Q'ty/bag
6	<b>SHJP-06V-S(HF)</b>	1,000

### Material

PBT, UL94V-0, natural (white)

### RoHS compliance

## Header

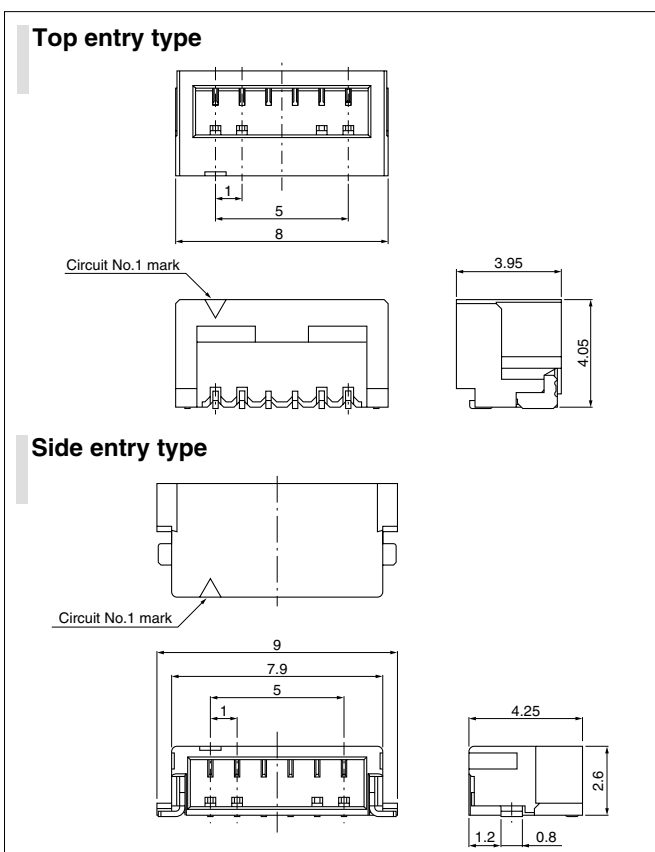

Circuits	Model No.		Q'ty/reel	
	Top entry type	Side entry type	Top type	Side type
6	<b>BM06B-SHJS-TB(HF)</b>	<b>SM06B-SHJH-TF(HF)</b>	2,500	3,500

### Material and Finish

Base contact: Brass, tin-plated (reflow treatment)  
 Base housing (Top entry type): PA 4T, natural  
 Base housing (Side entry type): PA 6T, gray  
 Solder tab: Brass, tin-plated (reflow treatment)

### RoHS compliance

Note: The product listed above are supplied on embossed-tape.