



ALL RIGHTS RESERVED. NO PORTION OF THIS PUBLICATION, WHETHER IN WHOLE OR IN PART CAN BE REPRODUCED WITHOUT THE EXPRESS WRITTEN CONSENT OF SPC TECHNOLOGY.

SPC-F005.DWG

REVISIONS

DOC. NO. SPC-F005 * Effective: 7/8/02 * DCP No: 1398

DCP #	REV	DESCRIPTION	DRAWN	DATE	CHECKD	DATE	APPRVD	DATE
1878	A	RELEASED	EO	8/7/06	JWM	8/7/06	HO	



Technical Data

Material:

- Pin (outer sleeve): Brass, machined, CuZn38Pb2
- Clip (contact 4 finger): Beryllium copper, heat treated or PHBZ
- Plating (outer sleeve): 2µm/80 µ" Nickel, gold Flash
- Plating Clip (contact): 2µm/80 µ" Nickel, gold Flash
- Insulator Body (black): Glass filled thermoplastic polyester UL94V-0

Electrical:

- Current Rating: 3 Amps/contact max.
- Contact Resistance: 4m/contact
- Insulation Resistance: 10,000 Megohm at 500VAC
- Rated Voltage: 100 VRMS/150VDC

Mechanical:

- Operating Temperature: -40°C to +105°C
(Continuous) -67°F to +105°F

- Average insertion force with steel pin of: £X0.43mm/0.017" < 250g
- Average withdrawal force with steel pin of: £X0.43mm/0.017" > 50g
- Mechanical Life: min. 200 Cycles

Environmental Data:

- Solderability (IEC 60068-2-20. Ta): 235°C, 2 sec
- Resistance to soldering heat (IEC 60068-2-20. Tb): Through hole mount components: 260°C, 10 sec.

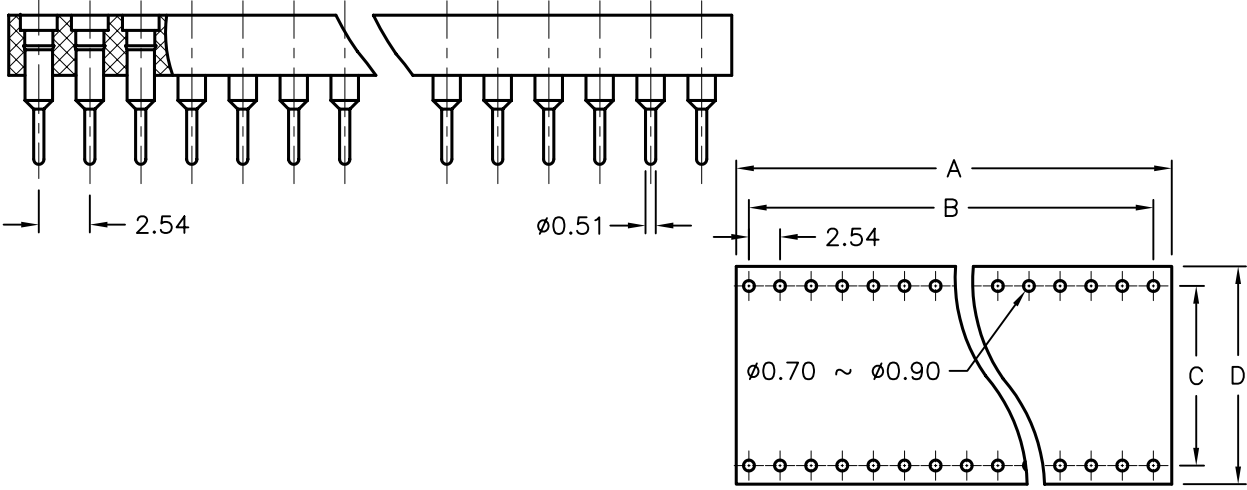
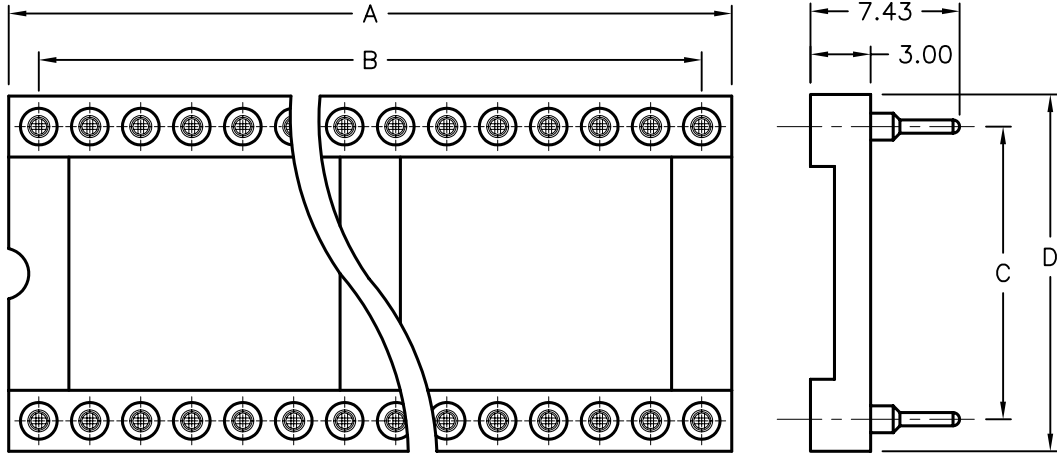

P.C.B. LAYOUT

SPC Type No.	Number Of Pins	Dimensions			
		A	B	C	D
SPC15559	6	7.62	5.08	7.62	10.16
SPC15511	8	10.16	7.62		
SPC15513	14	17.78	15.24		
SPC15516	16	20.32	17.78		
SPC15518	18	22.86	20.32	15.24	17.78
SPC15520	20	25.40	22.86		
SPC15522	24	30.48	27.94		
SPC15523	28	35.56	33.02		
SPC15561	32	40.64	38.10		
SPC15524	40	50.80	48.26		
SPC15534	48	60.96	58.42	22.86	25.40
SPC15535	64	81.28	78.74		

DISCLAIMER:
ALL STATEMENTS AND TECHNICAL INFORMATION CONTAINED HEREIN ARE BASED UPON INFORMATION AND/OR TESTS WE BELIEVE TO BE ACCURATE AND RELIABLE. SINCE CONDITIONS OF USE ARE BEYOND OUR CONTROL, THE USER SHALL DETERMINE THE SUITABILITY OF THE PRODUCT FOR THE INTENDED USE AND ASSUME ALL RISK AND LIABILITY WHATSOEVER IN CONNECTION THEREWITH.

TOLERANCES:
UNLESS OTHERWISE SPECIFIED,
X. ±0.50
X.X ±0.30
X.XX ±0.10
X' ±1"

DRAWN BY:	DATE:
EKLAS ODISH	8/7/06
CHECKED BY:	DATE:
JEFF MCVICKER	8/7/06
APPROVED BY:	DATE:
HISHAM ODISH	8/7/06

DRAWING TITLE:
PCB IC Socket, Solder Tail, Gold Sleeve, Gold Clip

SIZE	DWG. NO.	ELECTRONIC FILE	REV
A	TA-779	TA-779.DWG	A
SCALE: NTS	U.O.M.: Millimeters	SHEET: 1 OF 1	