

TACT Switch™ 6mm Square Low-profile Double Action (Surface Mount Type)

SKRN Series



0.9mm low-profile switch with double action.

- Detector
- Push
- Slide
- Rotary
- Encoders
- Power

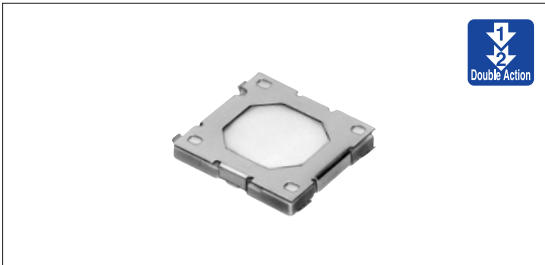

- Dual-in-line Package Type
- TACT Switch™
- Custom-Products

Product Line

Product No.	Operating force	Operating direction	Travel (mm)	Rating (max.)	Rating (min.)	Operating life (5mA 5V DC)	Initial contact resistance	Variety	Minimum order unit (pcs.)
SKRNPAE010	1st 0.78N 2nd 2.45N	Vertical	1st 0.25 All 0.4	50mA 12V DC	10μA 1V DC	30,000cycles	100mΩ max.	Without guide bosses	5,000
SKRNPBE010								With guide bosses	
SKRNPCE010								Without guide bosses	
SKRNPDE010	1st 0.78N 2nd 1.57N					With guide bosses			
SKRNPPE010	1st 0.59N 2nd 1.57N					Without guide bosses			
SKRNPME010						With guide bosses			

- Sharp Feeling
- Soft Feeling
- Snap-in Type
- Surface Mount Type
- Radial Type

Packing Specifications

Taping

Unit:mm

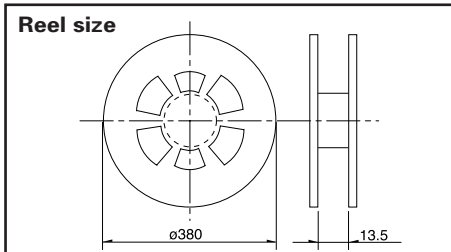

Number of packages (pcs.)			Tape width (mm)	Export package measurements (mm)
1 reel	1 case /Japan	1 case /export packing		
5,000	50,000	50,000	12	401×401×214

Dimensions

Unit:mm

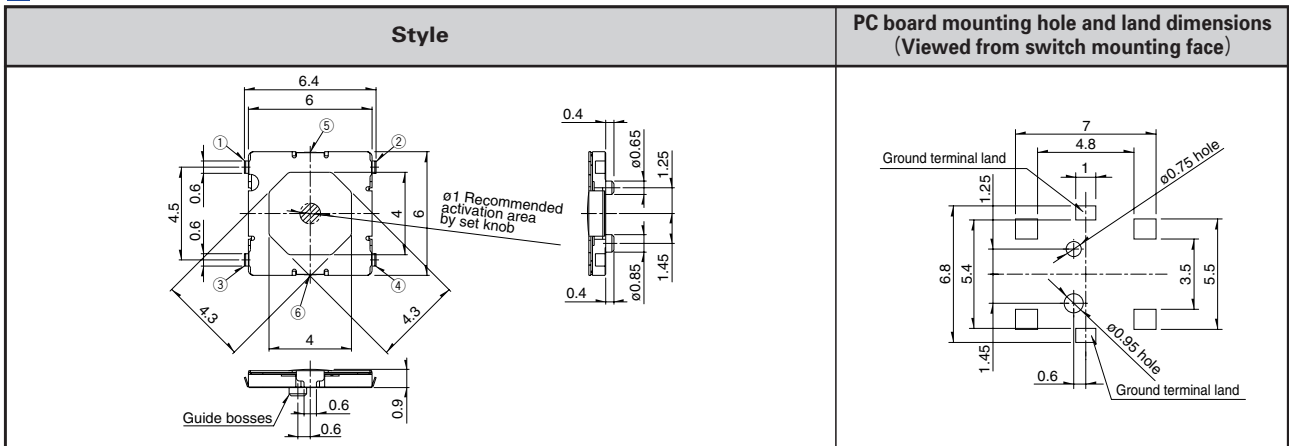

Circuit Arrangement

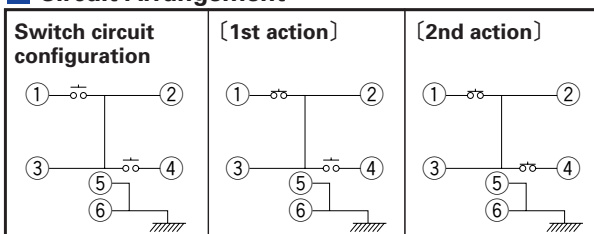









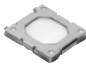

Notes

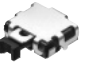
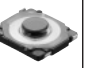
1. Please place purchase orders per minimum order unit N (integer).
2. For φ 330mm diameter reel requirements, please contact us.

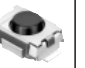
Refer to P.328 for soldering conditions.

List of Varieties

Sharp Feeling Type

Series	SKRN	SKSE	SPEE	SKSF	SKSG	SKRK	SKRP	SKQM	SKQY	SKRA	SKHM	
Photo												
Type	Surface mount											
Features	Double action	Horizontal type Double action		Compact size Low-profile	High operation force Compact size	Compact size Low-profile	High operation force Compact size	Compact size		Middle travel	—	
Operating direction	Vertical	●	—		●	●	●	●	●	●	●	
	Horizontal	—	●	●	—							
Dimensions (mm)	W	□6	5.9	4	2.8	3	3.9	4.2	6	6.1	□6.2	6.2
	D		2.87	5	2.4	2.7	2.9	3.2	3.5	3.7		6.5
	H	0.9	3	1.22	0.65	1.4	1.5	2.5	4.3	2.5	3.4	3.1
Operation force coverage	1N	See the relevant pages for respective product descriptions			↕		↕	↕	↕	↕	↕	↕
	5N					↕		↕	↕	↕	↕	↕
Ground terminal	●	—							●	—	●	
Operating temperature range	-30°C to +85°C		-10°C to +60°C		-30°C to +85°C							
Electrical performance	Insulation resistance	100MΩ min. 100V DC		10MΩ min. 100V DC		100MΩ min. 100V DC						
	Voltage proof	250V AC for 1min. SKSE : 100V AC for 1min.		100V AC for 1min.		250V AC for 1min.						
Durability	Vibration	10 to 55 to 10Hz/min., the amplitude is 1.5mm for all the frequencies, in the 3 direction of X, Y and Z for 2hours respectively										
	Lifetime	Shall be in accordance with individual specifications.										
Environmental performance	Cold	-30±2°C for 96h		-40±2°C for 96h		-30±2°C for 96h						
	Dry heat	80±2°C for 96h		85±2°C for 96h		80±2°C for 96h						
	Damp heat	60±2°C, 90 to 95%RH for 96h		40±2°C, 90 to 95%RH for 96h		60±2°C, 90 to 95%RH for 96h						
Page	301	302	107	303	304	305	306	307	308	309	310	

W : Width. The most outer dimension excluding terminal portion.
 D : Depth. The most outer dimension excluding terminal portion.
 H : Height. The minimum dimension if there are variances.

- TACT Switch™ Soldering Conditions328
- TACT Switch™ Cautions329
- Product Line of Knob for TACT Switch™330

Note

The automotive operating temperature range to be individually discussed upon request.

- Detector
- Push
- Slide
- Rotary
- Encoders
- Power
- Dual-in-line Package Type
- TACT Switch™
- Custom-Products

- Sharp Feeling
- Soft Feeling
- Snap-in Type
- Surface Mount Type
- Radial Type

Soldering Conditions

Condition for Reflow

Available for Surface Mount Type.

1. Heating method: Double heating method with infrared heater.
2. Temperature measurement: Thermocouple 0.1 to 0.2 ϕ CA (K) or CC (T) at solder joints (copper foil surface). A heat resistive tape should be used to fix thermocouple.
3. Temperature profile

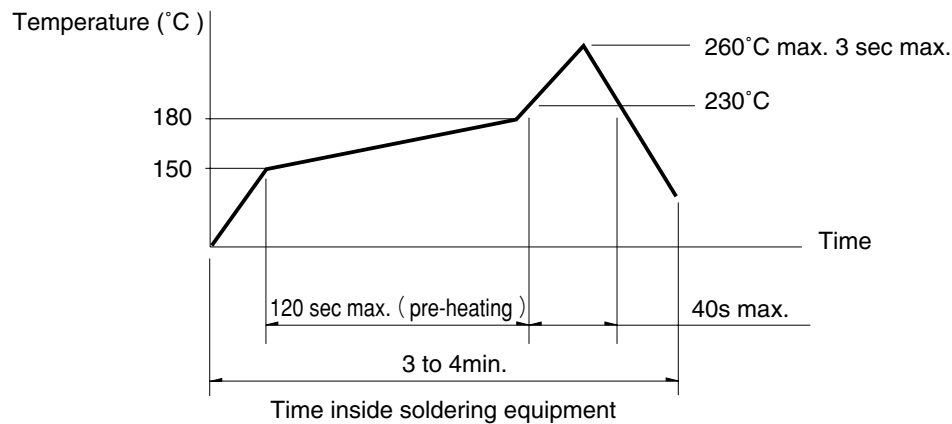

Notes

1. The above temperature shall be measured of the top of switch. There are cases where the PC board's temperature greatly differs from that of the switch, depending on the material, size, thickness of PC boards and others. The above-stated conditions shall also apply to switch surface temperatures.
2. Soldering conditions differ depending on reflow soldering machines. Prior verification of soldering condition is highly recommended.

Conditions for Auto-dip

Available for Snap-in Type and Radial Type
(Except SKHJ, SKHL, SKQJ, SKQK, SKEG series)

Items	Condition
Flux built-up	Mounting surface should not be exposed to flux
Preheating temperature	Ambient temperature of the soldered surface of PC board. 100°C max.
Preheating time	60s max.
Soldering temperature	260°C max.
Duration of immersion	5s max.
Number of soldering	2times max.

Notes

1. Consult with us for availability of TACT Switch™ washing.
2. Prevent flux penetration from the top side of the TACT Switch™.
3. Switch terminals and a PC board should not be coated with flux prior to soldering.
4. The second soldering should be done after the switch is stable with normal temperature.
5. Use the flux with a specific gravity of min 0.81.
(EC-19S-8 by TAMURA Corporation, or equivalents.)

Manual Soldering (Except SKRT Series)

Items	Condition
Soldering temperature	350°C max.
Duration of soldering	3s max.
Capacity of soldering iron	60W max.

Detector

Push

Slide

Rotary

Encoders

Power

Dual-in-line
Package Type

TACT Switch™

Custom-
ProductsSharp
FeelingSoft
FeelingSnap-in
TypeSurface
Mount TypeRadial
Type