

Flush-type connector - SACC-E-M 8MS-3CON-M8/0,5 - 1500334

Please be informed that the data shown in this PDF Document is generated from our Online Catalog. Please find the complete data in the user's documentation. Our General Terms of Use for Downloads are valid (<http://phoenixcontact.com/download>)



Sensor/actuator flush-type plug, 3-pos., M8, front/screw mounting, with M8 thread, with 0.5 m TPE litz wire, 3 x 0.25 mm²



Key Commercial Data

| | |
|--------------------------------------|----------|
| Packing unit | 1 pc |
| Weight per Piece (excluding packing) | 10.2 g |
| Custom tariff number | 85366990 |
| Country of origin | Germany |

Technical data

Dimensions

| | |
|-----------------|-------|
| Length of cable | 0.5 m |
|-----------------|-------|

Ambient conditions

| | |
|---------------------------------|----------------------------------|
| Ambient temperature (operation) | -25 °C ... 85 °C (Plug / socket) |
| Degree of protection | IP67 |

General

| | |
|-----------------------|------------------------------|
| Rated current at 40°C | 4 A |
| Rated voltage | 50 V AC 60 V DC |
| Rated surge voltage | 1.5 kV |
| Number of positions | 3 |
| Insulation resistance | ≥ 100 MΩ |
| Coding | A - standard |
| Standards/regulations | M8 connector IEC 61076-2-104 |
| Status display | No |
| Overvoltage category | II |

Flush-type connector - SACC-E-M 8MS-3CON-M8/0,5 - 1500334

Technical data

General

| | |
|---------------------|-------------------------|
| Degree of pollution | 3 |
| Connection method | Individual wires |
| Mounting type | Front mounting M8 x 0.5 |

Material

| | |
|--|---------------------|
| Flammability rating according to UL 94 | HB |
| Contact material | Cu alloy |
| Contact surface material | Au |
| Contact carrier material | PA 66 |
| Material, knurls | Nickel-plated brass |
| Sealing material | FKM |

Cable

| | |
|------------------------------------|--|
| Cable type | PVC litz wire |
| Conductor cross section | 0.25 mm ² |
| AWG signal line | 24 |
| Conductor structure signal line | 7x 0.20 mm |
| Core diameter including insulation | 1.5 mm ±0.1 mm |
| Thickness, insulation | 0.21 mm |
| Wire colors | brown, blue, black |
| Material conductor insulation | PVC/UL |
| Conductor material | Tin-plated Cu litz wires |
| Insulation resistance | ≥ 20 MΩ*km |
| Conductor resistance | ≥ 80 Ω/km |
| Nominal voltage, cable | 300 V |
| Test voltage, cable | 2000 V AC |
| Ambient temperature (operation) | -40 °C ... 105 °C (cable, fixed installation) |
| | -10 °C ... 105 °C (cable, flexible installation) |

Standards and Regulations

| | |
|--|-----------------|
| Standard designation | M8 connector |
| Standards/regulations | IEC 61076-2-104 |
| Connection in acc. with standard | CUL |
| Flammability rating according to UL 94 | HB |

Classifications

eCl@ss

| | |
|------------|----------|
| eCl@ss 4.0 | 27140815 |
|------------|----------|

Flush-type connector - SACC-E-M 8MS-3CON-M8/0,5 - 1500334

Classifications

eCl@ss

| | |
|------------|----------|
| eCl@ss 4.1 | 27140815 |
| eCl@ss 5.0 | 27143423 |
| eCl@ss 5.1 | 27143423 |
| eCl@ss 6.0 | 27143423 |
| eCl@ss 7.0 | 27449001 |
| eCl@ss 8.0 | 27440103 |
| eCl@ss 9.0 | 27440103 |

ETIM

| | |
|----------|----------|
| ETIM 2.0 | EC001297 |
| ETIM 3.0 | EC002061 |
| ETIM 4.0 | EC002061 |
| ETIM 5.0 | EC002061 |

UNSPSC

| | |
|---------------|----------|
| UNSPSC 6.01 | 31251501 |
| UNSPSC 7.0901 | 31251501 |
| UNSPSC 11 | 31251501 |
| UNSPSC 12.01 | 31251501 |
| UNSPSC 13.2 | 31251501 |

Approvals

Approvals

Approvals

UL Recognized / cUL Recognized / EAC / EAC / EAC / cULus Recognized

Ex Approvals

Approvals submitted

Approval details

Flush-type connector - SACC-E-M 8MS-3CON-M8/0,5 - 1500334

Approvals

| | |
|--------------------------------|-------|
| UL Recognized | |
| Nominal current I _N | 4 A |
| Nominal voltage U _N | 125 V |

| | |
|--------------------------------|-------|
| cUL Recognized | |
| Nominal current I _N | 4 A |
| Nominal voltage U _N | 125 V |

EAC

EAC

EAC

| |
|------------------|
| cULus Recognized |
|------------------|

Drawings

Dimensional drawing

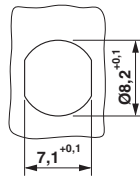

Schematic diagram

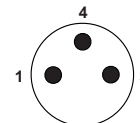

Pin assignment M8 plug, 3-pos., view male side

Flush-type connector - SACC-E-M 8MS-3CON-M8/0,5 - 1500334

Dimensional drawing

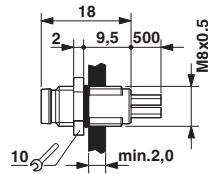

M8 flush-type plug

Phoenix Contact 2016 © - all rights reserved
<http://www.phoenixcontact.com>