



## Brad® mPm® Field Attachable DIN Valve Connectors

Conform to EN 175301-803 (ex DIN 43650)

The Brad mPm® range of connectors is used extensively to provide electrical connection in a wide range of applications. The most common application for mPm DIN connectors is in conjunction with pneumatic, hydraulic or electromagnetic devices, including solenoid valves. Other applications include, for example, pressure transducers, proximity switches, level sensors, limit switches and low energy motors.

Molex manufactures an extensive and comprehensive range of connectors with standard options including for example LED illuminated devices as well as VDR, diodes or transil diodes (with or without illuminated device) to offer protection against overvoltage peaks. Brad DIN mPm connectors offer protection from dust and water (IP65 or IP67 on specific request) when correctly installed with screw and gasket which are supplied together with the connector.



**IP67 rated DIN valve connector with improved strain relief. Cable retention force increased up to 20% over internal nut style. Enlarged cable range that covers the internal thread connectors cable range. Conforms to EN 175301-803**

## Specifications

### ELECTRICAL

Current: max. 10.0A  
 Contact Resistance: ≤15milliohms max.  
 Insulation Resistance:  
 100Megohms min.  
 Max. Conductor: 0.75mm<sup>2</sup> / 18AWG

### MECHANICAL

Insertion and Withdrawal Force:  
 2+GND ≤ 60N

### CERTIFICATION

UL recognized, *cURus* marked, file E218123 (product available upon request or specific part number)

### PHYSICAL

Durability: min. 50 cycles  
 Contact Area: Silver  
 Solder Tail Area: Silver  
 Operating Temperature with:  
 Nitrile Rubber (NBR) Gasket: -40° +90°C  
 Silicone Gasket: -40° +125°C  
 Cable Diameter Range: 3.00+5.50mm  
 Live Contact Distance: 8.00mm

### ENVIRONMENTAL

IP67 Sealing Protection

## Brad® mPm® Field Attachable DIN Valve Connectors

**121204** Form C, Ext. Thread,  
Non-Electronic

**121210** Form C, Ext. Thread,  
Electronic

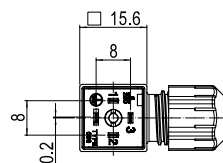
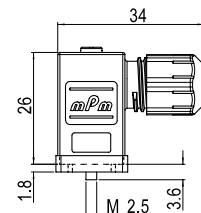
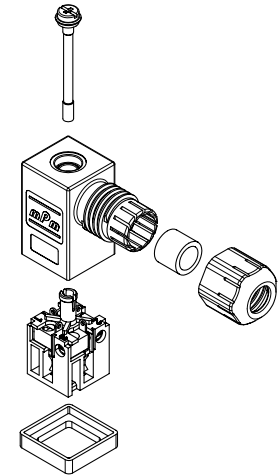

### Non Electronic

**C25 2 00 N 0 T \*\***

**SERIE** ————  
**C25**=External Thread Form C

**POLES** ————  
**2**=2Poles+Ground **3**=3Poles+Ground

**THREAD** ————  
**00**=External Thread

**COVER COLOR** ————  
**N**=Black Cover **G**=Gray Cover  
**W**=V0 Black Cover (only with UL listed connectors)

**GROUND POSITION** ————  
**0**=Unmounted **2**=H12 **3**=H3 **6**=H6 **9**=H9

**SCREW & GASKET** ————  
**T**=Profile NBR Gasket & IP67 Screw, **U**=Profile Silicone Gasket & IP67 Screw

**PACKAGING STYLE** ————  
**no digit**=Single Bag Unmounted, **SN**=Bulk Pack Mounted, **CN**=Bulk Pack Unmounted

### Electronic

**S25 2 00 T C4 2 0 T \*\***

**SERIE** ————  
**S25**=External Thread Form C

**POLES** ————  
**2**=2Poles+Ground

**THREAD** ————  
**00**=External Thread

**COVER COLOR** ————  
**N**=Black Cover **G**=Gray Cover **T**=Transparent

**CIRCUIT** ————  
 see page 29

**VOLTAGE & LED COLOR** ————  
 see page 29

**GROUND POSITION** ————  
**0**=Unmounted **2**=H12 **3**=H3 **6**=H6 **9**=H9

**SCREW & GASKET** ————  
**T**=Profile NBR Gasket & IP67 Screw, **U**=Profile Silicone Gasket & IP67 Screw

**PACKAGING STYLE** ————  
**no digit**=Single Bag Unmounted, **SN**=Bulk Pack Mounted, **CN**=Bulk Pack Unmounted

**Note:** UL listed part number identified by adding suffix SA at the end of the nomenclature in conjunction with UL material (W for black and T for transparent) e.g. C28200W2RSNSA

**Build your connector using the intelligent part number system and contact your local sales representative to identify the proper EDP number to use in your purchase orders**

Packaging Type		Poles	Circuit	Voltage	LED Color	Engineering No.	Standard Order No.
Single Bag	Unmounted	2+Ground	NO	250V AC/300V DC	NO	C25200N0T	121204-0001
Bulk Pack	Mounted		NO	250V AC/300V DC	NO	C25200N2TSN	121204-0010
Single Bag	Unmounted		C4	24V AC/DC	yellow	S25200TC4H0T	121210-0042
Bulk Pack	Mounted		C4	24V AC/DC	yellow	S25200TC4H2TSN	121210-0342
Single Bag	Unmounted		C4	230V AC/DC	yellow	S25200TC4M0T	121210-0045
Bulk Pack	Mounted		C4	230V AC/DC	yellow	S25200TC4M2TSN	121210-0345