

# Radial Lead RF Chokes

## Special Features

- High current capacity
- Ferrite bobbin core
- Low core loss at frequency
- High reliability, efficiency
- Fixed lead spacing
- Operating temperature -30 to +100°C

## Notes

\* Current to cause maximum 10% of inductance drop, or 40°C temperature rise

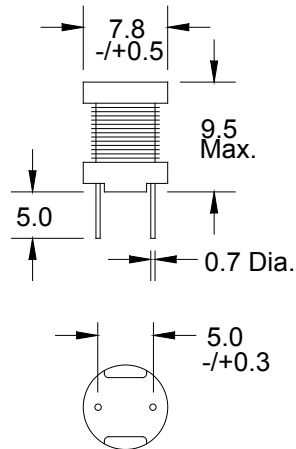

Dimensions: mm

| RL895 Series |                |            |                 |             |
|--------------|----------------|------------|-----------------|-------------|
| Part Number  | L (μH)<br>±20% | Test Freq. | DCR (Ω)<br>Max. | I, DC* (mA) |
| RL895-100M   | 10             | 2.52 MHz   | 0.04            | 2600        |
| RL895-120M   | 12             | 2.52 MHz   | 0.04            | 2600        |
|              | ±10%           |            |                 |             |
| RL895-150K   | 15             | 2.52 MHz   | 0.05            | 2100        |
| RL895-180K   | 18             | 2.52 MHz   | 0.05            | 2000        |
| RL895-220K   | 22             | 2.52 MHz   | 0.06            | 1700        |
| RL895-270K   | 27             | 2.52 MHz   | 0.06            | 1600        |
| RL895-330K   | 33             | 2.52 MHz   | 0.07            | 1400        |
| RL895-390K   | 39             | 2.52 MHz   | 0.08            | 1400        |
| RL895-470K   | 47             | 2.52 MHz   | 0.10            | 1300        |
| RL895-560K   | 56             | 2.52 MHz   | 0.11            | 1200        |
| RL895-680K   | 68             | 2.52 MHz   | 0.14            | 1100        |
| RL895-820K   | 82             | 2.52 MHz   | 0.16            | 1000        |
| RL895-101K   | 100            | 1 KHz      | 0.19            | 900         |
| RL895-121K   | 120            | 1 KHz      | 0.22            | 820         |
| RL895-151K   | 150            | 1 KHz      | 0.27            | 740         |
| RL895-181K   | 180            | 1 KHz      | 0.31            | 710         |
| RL895-221K   | 220            | 1 KHz      | 0.38            | 640         |
| RL895-271K   | 270            | 1 KHz      | 0.53            | 570         |
| RL895-331K   | 330            | 1 KHz      | 0.61            | 510         |
| RL895-391K   | 390            | 1 KHz      | 0.69            | 480         |
| RL895-471K   | 470            | 1 KHz      | 0.89            | 430         |
| RL895-561K   | 560            | 1 KHz      | 1.01            | 400         |
| RL895-681K   | 680            | 1 KHz      | 1.18            | 350         |
| RL895-821K   | 820            | 1 KHz      | 1.57            | 320         |
| RL895-102K   | 1000           | 1 KHz      | 1.84            | 300         |
| RL895-122K   | 1200           | 1 KHz      | 2.10            | 270         |
| RL895-152K   | 1500           | 1 KHz      | 2.80            | 230         |
| RL895-182K   | 1800           | 1 KHz      | 3.21            | 210         |
| RL895-222K   | 2200           | 1 KHz      | 4.21            | 190         |
| RL895-272K   | 2700           | 1 KHz      | 4.94            | 170         |
| RL895-332K   | 3300           | 1 KHz      | 6.16            | 150         |
| RL895-392K   | 3900           | 1 KHz      | 6.84            | 140         |
| RL895-472K   | 4700           | 1 KHz      | 7.89            | 130         |
| RL895-562K   | 5600           | 1 KHz      | 11.5            | 120         |
| RL895-682K   | 6800           | 1 KHz      | 13.2            | 110         |
| RL895-822K   | 8200           | 1 KHz      | 15.3            | 100         |
| RL895-103K   | 10,000         | 1 KHz      | 22.0            | 89          |
| RL895-123K   | 12,000         | 1 KHz      | 25.0            | 73          |
| RL895-153K   | 15,000         | 1 KHz      | 29.1            | 68          |
| RL895-183K   | 18,000         | 1 KHz      | 38.9            | 66          |
| RL895-223K   | 22,000         | 1 KHz      | 44.9            | 59          |
| RL895-273K   | 27,000         | 1 KHz      | 55.2            | 52          |
| RL895-333K   | 33,000         | 1 KHz      | 64.2            | 48          |
| RL895-393K   | 39,000         | 1 KHz      | 74.2            | 42          |
| RL895-473K   | 47,000         | 1 KHz      | 96.4            | 38          |

Also available as RoHS compliant.