

Delay On Make (Relay Output)

Q1T Series

FEATURES

- Time delays to 10 hours standard
- Solid state digital timing
- 100% functionally tested
- 20:1 maximum to minimum timing ratio
- Sealed SPDT output contacts
- Compact size
- Superior transient protection
- Epoxy encapsulated
- Flame-retardant and solvent-resistant polyester thermoplastic housing
- Trimpot on-board with sealed cermet element
-  File #E65038

Operating Logic: Upon application of voltage to the input terminals L1, L2, the time delay is initiated. At the end of the preset time delay, the relay coil is energized and the contacts transfer. Reset is accomplished by removing voltage from the input terminals.

LOGIC FUNCTION DIAGRAM

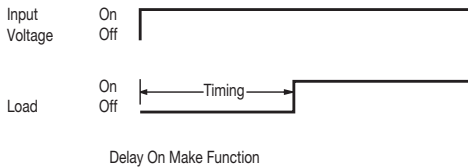

SPECIFICATIONS

TIME DELAY

Adjustment: On-board Trimpot
Range: 50 ms to 10 hours in 9 ranges
Repeatability: ±.5% max. (0.25% typical) at constant temperature
Accuracy: Max. time +10%, -0%; Minimum time -30%, +0%
Reset Time: .25 seconds max., by removal of the input voltage

INPUT

Operating Voltage: 12 VDC, 24 VAC/DC, 120 VAC/DC ±10%
Power Consumption: 3.5 VA max.
Frequency: 50/60 Hz

OUTPUT

Type: Relay contacts, SPDT (1 form C)
Rating: 8 A max. resistive at 250 VAC and 30 VDC; 100 mA at 5 VDC min. load current
Life:
 Mechanical: 10,000,000 cycles
 Electrical: 100,000 min. at full load

PROTECTION

Transient Voltage: 1000 P.I.V. components used
Isolation Resistance: 100 megohms min. between terminals and case
Dielectric Breakdown: 3000 VAC, RMS, terminals to mounting; 1500 VAC, RMS, input to output

MECHANICAL

Termination: .25" x .032" male fast-on terminals
Mounting: Surface mount with one #8 screw

ENVIRONMENTAL

Storage Temperature: -40°C to 70°C
Operating Temperature: -40°C to 70°C
Humidity: 95% relative

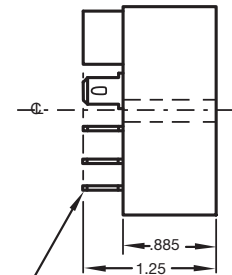
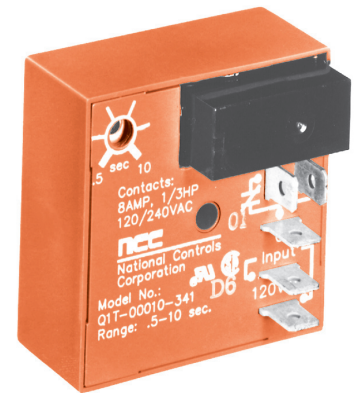

.25 X .032 MALE FAST-ON TERMINALS (5 PL.)

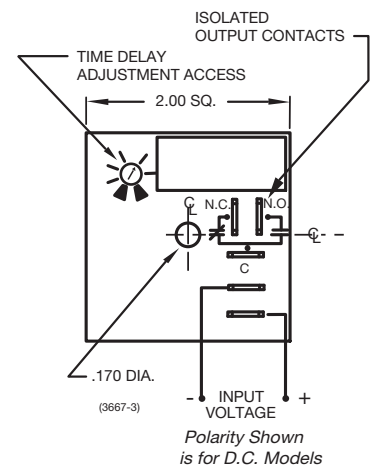

ORDERING INFORMATION

TIME RANGE	12 VDC ±10%	24 VAC/DC ±10%	120 VAC/DC ±10%
.05 to 1 sec.	—	—	Q1T-00001-341
.25 to 5 sec.	—	—	Q1T-00005-341
.5 to 10 sec.	—	Q1T-00010-347	Q1T-00010-341
3 to 60 sec.	Q1T-00060-346	—	Q1T-00060-341
15 to 300 sec.	Q1T-00300-346	—	Q1T-00300-341
30 to 600 sec.	—	—	Q1T-00600-341
180 to 3600 sec.	—	—	Q1T-03600-341
.25 to 5 hrs.	—	—	Q1T-18000-341
.5 to 10 hrs.	—	—	Q1T-36000-341

Consult factory for any special requirements not listed in catalog (minimum order requirement may apply).