

PART NAME

VALU/LINE SERIES

PART No.

HC-14097 THRU HC-14099  
NHC-14150 THRU NHC-14157

PART No.	DIM. 'A'	DIM. 'B'	DIM. 'C'	DIM. 'D'	DIM. 'E'	DIM. 'F'
HC-14097	1.750	8.000	7.750	0.250	1.250	1.000
HC-14098	1.750	13.000	12.750	0.250	1.250	1.000
HC-14099	3.500	8.000	7.750	0.875	1.750	2.750

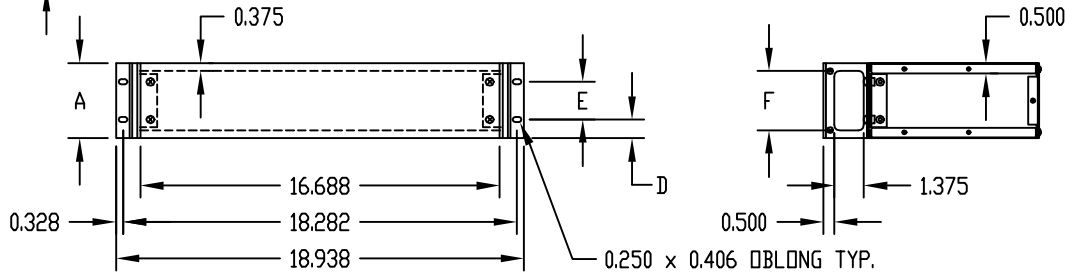
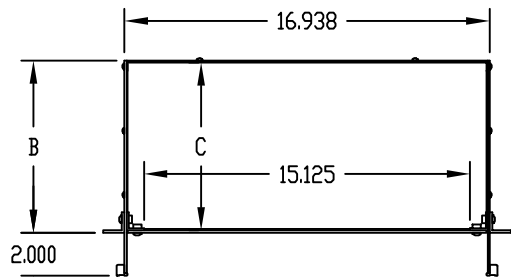

UNITS ARE SHIPPED UNASSEMBLED  
 OPTIONAL OUTER BRACKETS FOR MOUNTING IN  
 STANDARD E.I.A. 19" CABINETS (SUPPLIED)  
 (EXCEPT ON UNITS  
 OPTIONAL SELF-ADHESIVE RUBBER FEET (SUPPLIED)  
 LOAD RATING: 25 LBS. MAX.

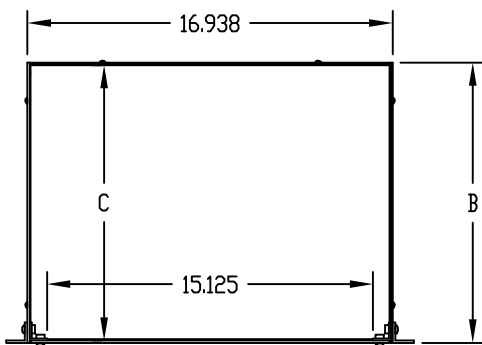

PART No.	DIM. 'A'	DIM. 'B'	DIM. 'C'	DIM. 'D'	DIM. 'E'
NHC-14151	1.750	8.000	7.750	0.250	1.250
NHC-14152	1.750	13.000	12.750	0.250	1.250
NHC-14154	3.500	8.000	7.750	0.875	1.750
NHC-14155	3.500	13.000	12.750	0.875	1.750
NHC-14156	5.250	13.000	12.750	1.500	2.250
NHC-14157	7.000	13.000	12.750	1.500	4.000

MATERIAL:  
 FRONT PANEL \_\_\_\_\_ 0.125 THK. ALUMINUM  
 OUTER BRACKET \_\_\_\_\_ 11 GA. STEEL  
 INNER BRACKET & SIDE \_\_\_\_\_ 0.090 THK. ALUMINUM  
 BACK & COVER \_\_\_\_\_ 0.050 THK. ALUMINUM  
 HANDLE \_\_\_\_\_ ALUMINUM EXTRUSION

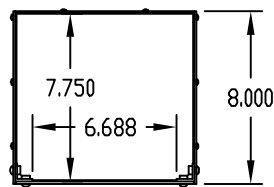
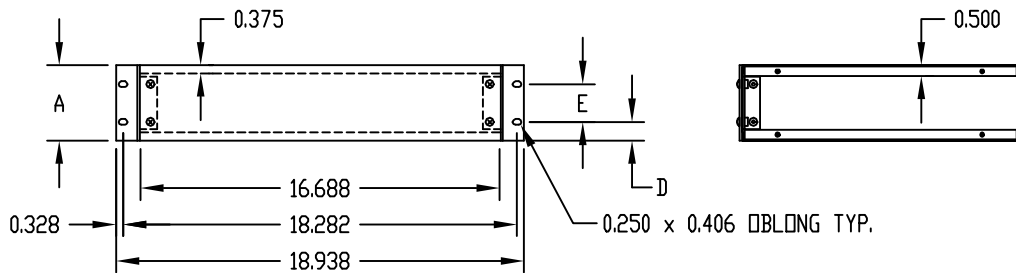

PART No.	DIM. 'A'
NHC-14150	1.750
NHC-14153	3.500

FINISH:  
 BACK & COVER \_\_\_\_\_ SMOOTH WHITE  
 SIDE & OUTER BRACKET \_\_\_\_\_ WHITE TEXTURE  
 FRONT PANEL & INNER BRACKET \_\_\_\_\_ NATURAL  
 HANDLE \_\_\_\_\_ BRUSHED, ETCHED & CLEAR ANODIZED  
 FEET \_\_\_\_\_ BLACK

