

COMBICON Plugs and Headers as a „high current“ (HC) Version for Currents up to 16 A, 5.0 or 5.08 mm Pitch

Tuning for the MSTB classic

The proven COMBICON MSTB plug connector is now available as a "high current" (HC) version for currents up to 16 A. On top of the familiar MSTB features, a double steel spring guarantees extra safety for higher power transmission.

The HC family is available with 2 to 12 positions and in pitches of 5.0 and 5.08 mm. Only the MSTB 2,5 HC headers provided are allowed to be used for carrying the higher current load of 16 A.

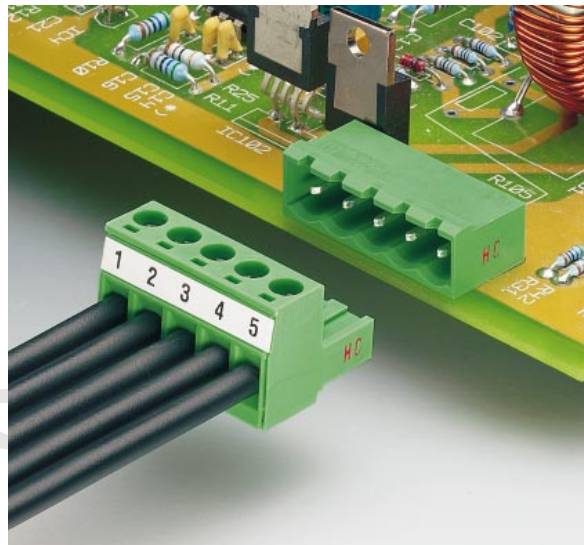

MSTB 2,5 HC/...-ST(-5,08) 5.0 or 5.08 mm Pitch

The designation "HC" is printed in red to provide clear identification of "high current" plugs and headers.

Only the MSTB 2,5 HC headers provided are allowed to be used for carrying the higher current load of 16 A.

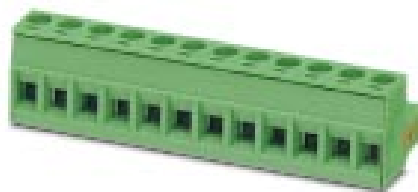

Note:

Only actuate COMBICON plug connectors when under no load condition. If for operating reasons small loads must be switched, experimental values are available upon request.

Description	No. of pos.	Dim. a [mm]	Type	Order No.	Pcs./Pkt.
COMBICON HC plugs, 5.0 mm pitch					
color: green	2	5	MSTB 2,5 HC/2-ST	19 11 85 5	50
	3	10	MSTB 2,5 HC/3-ST	19 11 86 8	
	4	15	MSTB 2,5 HC/4-ST	19 11 87 1	
	5	20	MSTB 2,5 HC/5-ST	19 11 88 4	
	6	25	MSTB 2,5 HC/6-ST	19 11 89 7	
	7	30	MSTB 2,5 HC/7-ST	19 11 90 7	
	8	35	MSTB 2,5 HC/8-ST	19 11 91 0	
	9	40	MSTB 2,5 HC/9-ST	19 11 92 3	
	10	45	MSTB 2,5 HC/10-ST	19 11 93 6	
	11	50	MSTB 2,5 HC/11-ST	19 11 94 9	
	12	55	MSTB 2,5 HC/12-ST	19 11 95 2	
COMBICON HC plugs, 5.08 mm pitch					
color: green	2	5.08	MSTB 2,5 HC/2-ST-5,08	19 11 96 5	50
	3	10.16	MSTB 2,5 HC/3-ST-5,08	19 11 97 8	
	4	15.24	MSTB 2,5 HC/4-ST-5,08	19 11 98 1	
	5	20.32	MSTB 2,5 HC/5-ST-5,08	19 11 99 4	
	6	25.40	MSTB 2,5 HC/6-ST-5,08	19 12 00 3	
	7	30.48	MSTB 2,5 HC/7-ST-5,08	19 12 01 6	
	8	35.56	MSTB 2,5 HC/8-ST-5,08	19 12 02 9	
	9	40.64	MSTB 2,5 HC/9-ST-5,08	19 12 03 2	
	10	45.72	MSTB 2,5 HC/10-ST-5,08	19 12 04 5	
	11	50.80	MSTB 2,5 HC/11-ST-5,08	19 12 05 8	
	12	55.88	MSTB 2,5 HC/12-ST-5,08	19 12 06 1	
(1) Coding profile, is inserted into the groove on the plug, red insulating material			CP-MSTB	17 34 63 4	
(2) Marker card, with 12 pcs. 10-section marker strips, white, self-adhesive, for 120 terminal blocks			SK 5/3,8 or SK 5,08/3,8 (see COMBICON catalog)		

Technical data

Dimensions		see description on page 13		
Pitch	[mm]	5 / 5.08		
Hole diameter	[mm]	-		
Pin dimensions	[mm]x[mm]	-		
Technical data in accordance with IEC/ DIN VDE				
Insulating material group	-	I		
Surge voltage category / contamination class	-/-	III / 3	III / 2	II / 2
Rated voltage	[V]	250	320	630
Rated surge voltage	[kV]	4	4	4
Nominal current / cross section	[A]/[mm²]	16 / 2.5		
Maximum load current / cross section	[A]/[mm²]	16 / 2.5		
Capacity connection				
Solid / stranded / conductor sizes	[mm²]/[mm²]/AWG	0.2 - 2.5 / 0.2 - 2.5 / 24 - 12		
Stranded with ferrule without / with plastic sleeve	[mm²]	0.25 - 2.5 / 0.25 - 2.5		
Multiple connection (2 conductors with same cross section)				
Solid / stranded	[mm²]	0.2 - 1 / 0.2 - 1.5		
Stranded with ferrule with plastic sleeve	[mm²]	0.25 - 1		
Stranded with TWIN ferrule with plastic sleeve	[mm²]	0.5 - 1.5		
Stripping length	[mm]	7		
Internal cylindrical gauge (IEC 60 947-1)		A 3		
Thread		M 3		
Torque	[Nm]	0.5 - 0.6		
Insulating material		PA		
Inflammability class in acc. with UL 94		V0		

MSTB 2,5 HC/...-STF(-5,08) with Srew Flange 5.0 or 5.08 mm Pitch

The designation "HC" is printed in red to provide clear identification of "high current" plugs and headers.

Only the MSTB 2,5 HC headers provided are allowed to be used for carrying the higher current load of 16 A.

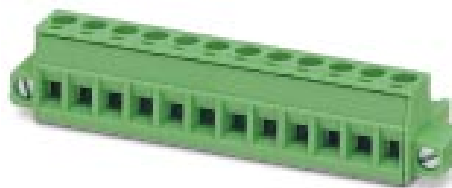

Note:

Only actuate COMBICON plug connectors when under no load condition. If for operating reasons small loads must be switched, experimental values are available upon request.

Description	No. of pos.	Dim. a [mm]	Type	Order No.	Pcs./Pkt.
COMBICON HC plugs, 5.0 mm pitch, with screw flange, color: green	2	5	MSTB 2,5 HC/2-STF	19 12 07 4	50
	3	10	MSTB 2,5 HC/3-STF	19 12 08 7	
	4	15	MSTB 2,5 HC/4-STF	19 12 09 0	
	5	20	MSTB 2,5 HC/5-STF	19 12 10 0	
	6	25	MSTB 2,5 HC/6-STF	19 12 11 3	
	7	30	MSTB 2,5 HC/7-STF	19 12 12 6	
	8	35	MSTB 2,5 HC/8-STF	19 12 13 9	
	9	40	MSTB 2,5 HC/9-STF	19 12 14 2	
	10	45	MSTB 2,5 HC/10-STF	19 12 15 5	
	11	50	MSTB 2,5 HC/11-STF	19 12 16 8	
	12	55	MSTB 2,5 HC/12-STF	19 12 17 1	
	COMBICON HC plugs, 5.08 mm pitch, with screw flange, color: green	2	5.08	MSTB 2,5 HC/2-STF-5,08	
3		10.16	MSTB 2,5 HC/3-STF-5,08	19 12 19 7	
4		15.24	MSTB 2,5 HC/4-STF-5,08	19 12 20 7	
5		20.32	MSTB 2,5 HC/5-STF-5,08	19 12 21 0	
6		25.40	MSTB 2,5 HC/6-STF-5,08	19 12 22 3	
7		30.48	MSTB 2,5 HC/7-STF-5,08	19 12 23 6	
8		35.56	MSTB 2,5 HC/8-STF-5,08	19 12 24 9	
9		40.64	MSTB 2,5 HC/9-STF-5,08	19 12 25 2	
10		45.72	MSTB 2,5 HC/10-STF-5,08	19 12 26 5	
11		50.80	MSTB 2,5 HC/11-STF-5,08	19 12 27 8	
12		55.88	MSTB 2,5 HC/12-STF-5,08	19 12 28 1	
(1) Coding profile , is inserted into the groove on the plug, red insulating material				CP-MSTB	17 34 63 4
(2) Marker card , with 12 pcs. 10-section marker strips, white, self-adhesive, for 120 terminal blocks			SK 5/3,8 or SK 5,08/3,8 (see COMBICON catalog)		

Technical data

Dimensions		see description on page 13		
Pitch	[mm]	5 / 5.08		
Hole diameter	[mm]	-		
Pin dimensions	[mm]x[mm]	-		
Technical data in accordance with IEC/ DIN VDE				
Insulating material group	-	I		
Surge voltage category / contamination class	-/-	III / 3	III / 2	II / 2
Rated voltage	[V]	250	320	630
Rated surge voltage	[kV]	4	4	4
Nominal current / cross section	[A]/[mm²]	16 / 2.5		
Maximum load current / cross section	[A]/[mm²]	16 / 2.5		
Capacity connection				
Solid / stranded / conductor sizes	[mm²]/[mm²]/AWG	0.2 - 2.5 / 0.2 - 2.5 / 24 - 12		
Stranded with ferrule without / with plastic sleeve	[mm²]	0.25 - 2.5 / 0.25 - 2.5		
Multiple connection (2 conductors with same cross section)				
Solid / stranded	[mm²]	0.2 - 1 / 0.2 - 1.5		
Stranded with ferrule with plastic sleeve	[mm²]	0.25 - 1		
Stranded with TWIN ferrule with plastic sleeve	[mm²]	0.5 - 1.5		
Stripping length	[mm]	7		
Internal cylindrical gauge (IEC 60 947-1)		A 3		
Thread		M 3		
Torque	[Nm]	0.5 - 0.6		
Insulating material		PA		
Inflammability class in acc. with UL 94		V0		

MSTBT 2,5 HC/...-ST 5.0 mm Pitch

The designation "HC" is printed in red to provide clear identification of "high current" plugs and headers.

Only the MSTB 2,5 HC headers provided are allowed to be used for carrying the higher current load of 16 A.



Note:

Only actuate COMBICON plug connectors when under no load condition. If for operating reasons small loads must be switched, experimental values are available upon request.

Description	No. of pos.	Dim. a [mm]	Type	Order No.	Pcs./Pkt.
COMBICON HC plugs, 5.0 mm pitch, color: green	2	5	MSTBT 2,5 HC/2-ST	19 26 35 8	50
	3	10	MSTBT 2,5 HC/3-ST	19 26 24 8	
	4	15	MSTBT 2,5 HC/4-ST	19 26 25 1	
	5	20	MSTBT 2,5 HC/5-ST	19 26 26 4	
	6	25	MSTBT 2,5 HC/6-ST	19 26 27 7	
	7	30	MSTBT 2,5 HC/7-ST	19 26 28 0	
	8	35	MSTBT 2,5 HC/8-ST	19 26 29 3	
	9	40	MSTBT 2,5 HC/9-ST	19 26 30 3	
	10	45	MSTBT 2,5 HC/10-ST	19 26 31 6	
	11	50	MSTBT 2,5 HC/11-ST	19 26 32 9	
	12	55	MSTBT 2,5 HC/12-ST	19 26 33 2	
(1) Coding profile , is inserted into the groove on the plug, red insulating material			CP-MSTB	17 34 63 4	
(2) Marker card , with 12 pcs. 10-section marker strips, white, self-adhesive, for 120 terminal blocks			SK 5/3,8 (see COMBICON catalog)		

Technical data

Dimensions		see description on page 13		
Pitch	[mm]	5		
Hole diameter	[mm]	-		
Pin dimensions	[mm]x[mm]	-		
Technical data in accordance with IEC/ DIN VDE				
Insulating material group	-	I		
Surge voltage category / contamination class	-/-	III / 3	III / 2	II / 2
Rated voltage	[V]	250	320	630
Rated surge voltage	[kV]	4	4	4
Nominal current / cross section	[A]/[mm ²]	16 / 2.5		
Maximum load current / cross section	[A]/[mm ²]	16 / 2.5		
Capacity connection				
Solid / stranded / conductor sizes	[mm ²]/[mm ²]/AWG	0.2 - 2.5 / 0.2 - 2.5 / 24 - 12		
Stranded with ferrule without / with plastic sleeve	[mm ²]	0.25 - 2.5 / 0.25 - 2.5		
Multiple connection (2 conductors with same cross section)				
Solid / stranded	[mm ²]	0.2 - 1 / 0.2 - 1.5		
Stranded with ferrule with plastic sleeve	[mm ²]	0.25 - 1		
Stranded with TWIN ferrule with plastic sleeve	[mm ²]	0.5 - 1.5		
Stripping length	[mm]	7		
Internal cylindrical gauge (IEC 60 947-1)		A 3		
Thread		M 3		
Torque	[Nm]	0.5 - 0.6		
Insulating material		PA		
Inflammability class in acc. with UL 94		V0		

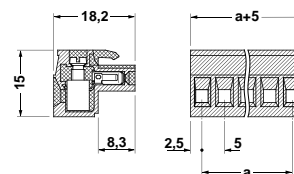

MVSTBR 2,5 HC/...-ST(-5,08) Vertical Plugs 5.0 or 5.08 mm Pitch

The designation "HC" is printed in red to provide clear identification of "high current" plugs and headers.

Only the MSTB 2,5 HC headers provided are allowed to be used for carrying the higher current load of 16 A.



Note:

Only actuate COMBICON plug connectors when under no load condition. If for operating reasons small loads must be switched, experimental values are available upon request.

Description	No. of pos.	Dim. a [mm]	Type	Order No.	Pcs./Pkt.
COMBICON HC plugs, 5.0 mm pitch, plug-in direction vertical to the conductor axis, connection point facing the smooth wall (R) of the header, color: green	2	5	MVSTBR 2,5 HC/2-ST	19 12 29 4	50
	3	10	MVSTBR 2,5 HC/3-ST	19 12 30 4	
	4	15	MVSTBR 2,5 HC/4-ST	19 12 31 7	
	5	20	MVSTBR 2,5 HC/5-ST	19 12 32 0	
	6	25	MVSTBR 2,5 HC/6-ST	19 12 33 3	
	7	30	MVSTBR 2,5 HC/7-ST	19 12 34 6	
	8	35	MVSTBR 2,5 HC/8-ST	19 12 35 9	
	9	40	MVSTBR 2,5 HC/9-ST	19 12 36 2	
	10	45	MVSTBR 2,5 HC/10-ST	19 12 37 5	
	11	50	MVSTBR 2,5 HC/11-ST	19 12 38 8	
	12	55	MVSTBR 2,5 HC/12-ST	19 12 39 1	
	COMBICON HC plugs, 5.08 mm pitch, plug-in direction vertical to the conductor axis, connection point facing the smooth wall (R) of the header, color: green	2	5.08	MVSTBR 2,5 HC/2-ST-5,08	
3		10.16	MVSTBR 2,5 HC/3-ST-5,08	19 12 41 4	
4		15.24	MVSTBR 2,5 HC/4-ST-5,08	19 12 42 7	
5		20.32	MVSTBR 2,5 HC/5-ST-5,08	19 12 43 0	
6		25.40	MVSTBR 2,5 HC/6-ST-5,08	19 12 44 3	
7		30.48	MVSTBR 2,5 HC/7-ST-5,08	19 12 45 6	
8		35.56	MVSTBR 2,5 HC/8-ST-5,08	19 12 46 9	
9		40.64	MVSTBR 2,5 HC/9-ST-5,08	19 12 47 2	
10		45.72	MVSTBR 2,5 HC/10-ST-5,08	19 12 48 5	
11		50.80	MVSTBR 2,5 HC/11-ST-5,08	19 12 49 8	
12		55.88	MVSTBR 2,5 HC/12-ST-5,08	19 12 50 8	
(1) Coding profile , is inserted into the groove on the plug, red insulating material				CP-MSTB	17 34 63 4
(2) Marker card , with 12 pcs. 10-section marker strips, white, self-adhesive, for 120 terminal blocks			SK 5/3,8 or SK 5,08/3,8 (see COMBICON catalog)		

Technical data

Dimensions		see description on page 13		
Pitch	[mm]	5 / 5.08		
Hole diameter	[mm]	-		
Pin dimensions	[mm]x[mm]	-		
Technical data in accordance with IEC/ DIN VDE				
Insulating material group	-	I		
Surge voltage category / contamination class	-/-	III / 3	III / 2	II / 2
Rated voltage	[V]	250	320	630
Rated surge voltage	[kV]	4	4	4
Nominal current / cross section	[A]/[mm ²]	16 / 2.5		
Maximum load current / cross section	[A]/[mm ²]	16 / 2.5		
Capacity connection				
Solid / stranded / conductor sizes	[mm ²]/[mm ²]/AWG	0.2 - 2.5 / 0.2 - 2.5 / 24 - 12		
Stranded with ferrule without / with plastic sleeve	[mm ²]	0.25 - 2.5 / 0.25 - 2.5		
Multiple connection (2 conductors with same cross section)				
Solid / stranded	[mm ²]	0.2 - 1 / 0.2 - 1.5		
Stranded with ferrule with plastic sleeve	[mm ²]	0.25 - 1		
Stranded with TWIN ferrule with plastic sleeve	[mm ²]	0.5 - 1.5		
Stripping length	[mm]	7		
Internal cylindrical gauge (IEC 60 947-1)		A 3		
Thread		M 3		
Torque	[Nm]	0.5 - 0.6		
Insulating material		PA		
Inflammability class in acc. with UL 94		V0		

MVSTBR 2,5 HC/...-STF(-5,08) Vertical Plugs with Screw Flange 5.0 or 5.08 mm Pitch

The designation "HC" is printed in red to provide clear identification of "high current" plugs and headers.

Only the MSTB 2,5 HC headers provided are allowed to be used for carrying the higher current load of 16 A.



Note:

Only actuate COMBICON plug connectors when under no load condition. If for operating reasons small loads must be switched, experimental values are available upon request.

Description	No. of pos.	Dim. a [mm]	Type	Order No.	Pcs./Pkt.
COMBICON HC plugs, 5.0 mm pitch, with screw flange, color: green, connection point facing the smooth wall (R) of the header	2	5	MVSTBR 2,5 HC/2-STF	19 12 51 1	50
	3	10	MVSTBR 2,5 HC/3-STF	19 12 52 4	
	4	15	MVSTBR 2,5 HC/4-STF	19 12 53 7	
	5	20	MVSTBR 2,5 HC/5-STF	19 12 54 0	
	6	25	MVSTBR 2,5 HC/6-STF	19 12 55 3	
	7	30	MVSTBR 2,5 HC/7-STF	19 12 56 6	
	8	35	MVSTBR 2,5 HC/8-STF	19 12 57 9	
	9	40	MVSTBR 2,5 HC/9-STF	19 12 58 2	
	10	45	MVSTBR 2,5 HC/10-STF	19 12 59 5	
	11	50	MVSTBR 2,5 HC/11-STF	19 12 60 5	
	12	55	MVSTBR 2,5 HC/12-STF	19 12 61 8	
	COMBICON HC plugs, 5.08 mm pitch, with screw flange, color: green, connection point facing the smooth wall (R) of the header	2	5.08	MVSTBR 2,5 HC/2-STF-5,08	
3		10.16	MVSTBR 2,5 HC/3-STF-5,08	19 12 63 4	
4		15.24	MVSTBR 2,5 HC/4-STF-5,08	19 12 64 7	
5		20.32	MVSTBR 2,5 HC/5-STF-5,08	19 12 65 0	
6		25.40	MVSTBR 2,5 HC/6-STF-5,08	19 12 66 3	
7		30.48	MVSTBR 2,5 HC/7-STF-5,08	19 12 67 6	
8		35.56	MVSTBR 2,5 HC/8-STF-5,08	19 12 68 9	
9		40.64	MVSTBR 2,5 HC/9-STF-5,08	19 12 69 2	
10		45.72	MVSTBR 2,5 HC/10-STF-5,08	19 12 70 2	
11		50.80	MVSTBR 2,5 HC/11-STF-5,08	19 12 71 5	
12		55.88	MVSTBR 2,5 HC/12-STF-5,08	19 12 72 8	
(1) Coding profile , is inserted into the groove on the plug, red insulating material				CP-MSTB	17 34 63 4
(2) Marker card , with 12 pcs. 10-section marker strips, white, self-adhesive, for 120 terminal blocks			SK 5/3,8 or SK 5,08/3,8 (see COMBICON catalog)		

Technical data

Dimensions		see description page 13		
Pitch	[mm]	5 / 5.08		
Hole diameter	[mm]	-		
Pin dimensions	[mm]x[mm]	-		
Technical data in accordance with IEC/ DIN VDE				
Insulating material group	-	I		
Surge voltage category / contamination class	-/-	III / 3	III / 2	II / 2
Rated voltage	[V]	250	320	630
Rated surge voltage	[kV]	4	4	4
Nominal current / cross section	[A]/[mm²]	16 / 2.5		
Maximum load current / cross section	[A]/[mm²]	16 / 2.5		
Capacity connection				
Solid / stranded / conductor sizes	[mm²]/[mm²]/AWG	0.2 - 2.5 / 0.2 - 2.5 / 24 - 12		
Stranded with ferrule without / with plastic sleeve	[mm]	0.25 - 2.5 / 0.25 - 2.5		
Multiple connection (2 conductors with same cross section)				
Solid / stranded	[mm²]	0.2 - 1 / 0.2 - 1.5		
Stranded with ferrule with plastic sleeve	[mm²]	0.25 - 1		
Stranded with TWIN ferrule with plastic sleeve	[mm²]	0.5 - 1.5		
Stripping length	[mm]	7		
Internal cylindrical gauge (IEC 60 947-1)		A 3		
Thread		M 3		
Torque	[Nm]	0.5 - 0.6		
Insulating material		PA		
Inflammability class in acc. with UL 94		V0		

MVSTBW 2,5 HC/...-ST(-5,08) Vertical Plugs 5.0 or 5.08 mm Pitch

The designation "HC" is printed in red to provide clear identification of "high current" plugs and headers.

Only the MSTB 2,5 HC headers provided are allowed to be used for carrying the higher current load of 16 A.

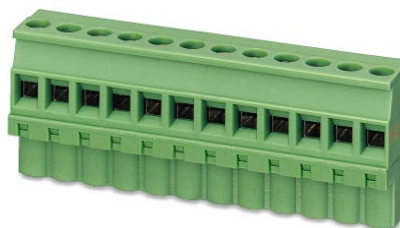

Note:

Only actuate COMBICON plug connectors when under no load condition. If for operating reasons small loads must be switched, experimental values are available upon request.

Description	No. of pos.	Dim. a [mm]	Type	Order No.	Pcs./Pkt.
COMBICON HC plugs, 5.0 mm pitch, plug-in direction vertical to the conductor axis, connection point facing the rippled wall (W) of the header, color: green	2	5	MVSTBW 2,5 HC/2-ST	19 12 73 1	50
	3	10	MVSTBW 2,5 HC/3-ST	19 12 74 4	
	4	15	MVSTBW 2,5 HC/4-ST	19 12 75 7	
	5	20	MVSTBW 2,5 HC/5-ST	19 12 76 0	
	6	25	MVSTBW 2,5 HC/6-ST	19 12 77 3	
	7	30	MVSTBW 2,5 HC/7-ST	19 12 78 6	
	8	35	MVSTBW 2,5 HC/8-ST	19 12 79 9	
	9	40	MVSTBW 2,5 HC/9-ST	19 12 80 9	
	10	45	MVSTBW 2,5 HC/10-ST	19 12 81 2	
	11	50	MVSTBW 2,5 HC/11-ST	19 12 82 5	
	12	55	MVSTBW 2,5 HC/12-ST	19 12 83 8	
	COMBICON HC plugs, 5.08 mm pitch, plug-in direction vertical to the conductor axis, connection point facing the rippled wall (W) of the header, color: green	2	5.08	MVSTBW 2,5 HC/2-ST-5,08	
3		10.16	MVSTBW 2,5 HC/3-ST-5,08	19 12 85 4	
4		15.24	MVSTBW 2,5 HC/4-ST-5,08	19 12 86 7	
5		20.32	MVSTBW 2,5 HC/5-ST-5,08	19 12 87 0	
6		25.40	MVSTBW 2,5 HC/6-ST-5,08	19 12 88 3	
7		30.48	MVSTBW 2,5 HC/7-ST-5,08	19 12 89 6	
8		35.56	MVSTBW 2,5 HC/8-ST-5,08	19 12 90 6	
9		40.64	MVSTBW 2,5 HC/9-ST-5,08	19 12 91 9	
10		45.72	MVSTBW 2,5 HC/10-ST-5,08	19 12 92 2	
11		50.80	MVSTBW 2,5 HC/11-ST-5,08	19 12 93 5	
12		55.88	MVSTBW 2,5 HC/12-ST-5,08	19 12 94 8	
(1) Coding profile , is inserted into the groove on the plug, red insulating material				CP-MSTB	17 34 63 4
(2) Marker card , with 12 pcs. 10-section marker strips, white, self-adhesive, for 120 terminal blocks			SK 5/3,8 or SK 5,08/3,8 (see COMBICON catalog)		

Technical data

Dimensions		see description on page 13		
Pitch	[mm]	5 / 5.08		
Hole diameter	[mm]	-		
Pin dimensions	[mm]x[mm]	-		
Technical data in accordance with IEC/ DIN VDE				
Insulating material group	-	I		
Surge voltage category / contamination class	-/-	III / 3	III / 2	II / 2
Rated voltage	[V]	250	320	630
Rated surge voltage	[kV]	4	4	4
Nominal current / cross section	[A]/[mm²]	16 / 2.5		
Maximum load current / cross section	[A]/[mm²]	16 / 2.5		
Capacity connection				
Solid / stranded / conductor sizes	[mm²]/[mm²]/AWG	0.2 - 2.5 / 0.2 - 2.5 / 24 - 12		
Stranded with ferrule without / with plastic sleeve	[mm²]	0.25 - 2.5 / 0.25 - 2.5		
Multiple connection (2 conductors with same cross section)				
Solid / stranded	[mm²]	0.2 - 1 / 0.2 - 1.5		
Stranded with ferrule with plastic sleeve	[mm²]	0.25 - 1		
Stranded with TWIN ferrule with plastic sleeve	[mm²]	0.5 - 1.5		
Stripping length	[mm]	7		
Internal cylindrical gauge (IEC 60 947-1)		A 3		
Thread		M 3		
Torque	[Nm]	0.5 - 0.6		
Insulating material		PA		
Inflammability class in acc. with UL 94		V0		

MVSTBW 2,5 HC/...-STF(-5,08) Vertical Plugs with Screw Flange 5.0 or 5.08 mm Pitch

The designation "HC" is printed in red to provide clear identification of "high current" plugs and headers.

Only the MSTB 2,5 HC headers provided are allowed to be used for carrying the higher current load of 16 A.



Note:

Only actuate COMBICON plug connectors when under no load condition. If for operating reasons small loads must be switched, experimental values are available upon request.

Description	No. of pos.	Dim. a [mm]	Type	Order No.	Pcs./Pkt.
COMBICON HC plugs, 5.0 mm pitch, with screw flange, color: green, connection point facing the rippled wall (W) of the header	2	5	MVSTBW 2,5 HC/2-STF	19 12 95 1	50
	3	10	MVSTBW 2,5 HC/3-STF	19 12 96 4	
	4	15	MVSTBW 2,5 HC/4-STF	19 12 97 7	
	5	20	MVSTBW 2,5 HC/5-STF	19 12 98 0	
	6	25	MVSTBW 2,5 HC/6-STF	19 12 99 3	
	7	30	MVSTBW 2,5 HC/7-STF	19 13 00 2	
	8	35	MVSTBW 2,5 HC/8-STF	19 13 01 5	
	9	40	MVSTBW 2,5 HC/9-STF	19 13 02 8	
	10	45	MVSTBW 2,5 HC/10-STF	19 13 03 1	
	11	50	MVSTBW 2,5 HC/11-STF	19 13 04 4	
	12	55	MVSTBW 2,5 HC/12-STF	19 13 05 7	
	COMBICON HC plugs, 5.08 mm pitch, with screw flange, color: green, connection point facing the rippled wall (W) of the header	2	5.08	MVSTBW 2,5 HC/2-STF-5,08	
3		10.16	MVSTBW 2,5 HC/3-STF-5,08	19 13 07 3	
4		15.24	MVSTBW 2,5 HC/4-STF-5,08	19 13 08 6	
5		20.32	MVSTBW 2,5 HC/5-STF-5,08	19 13 09 9	
6		25.40	MVSTBW 2,5 HC/6-STF-5,08	19 13 10 9	
7		30.48	MVSTBW 2,5 HC/7-STF-5,08	19 13 11 2	
8		35.56	MVSTBW 2,5 HC/8-STF-5,08	19 13 12 5	
9		40.64	MVSTBW 2,5 HC/9-STF-5,08	19 13 13 8	
10		45.72	MVSTBW 2,5 HC/10-STF-5,08	19 13 14 1	
11		50.80	MVSTBW 2,5 HC/11-STF-5,08	19 13 15 4	
12		55.88	MVSTBW 2,5 HC/12-STF-5,08	19 13 16 7	
(1) Coding profile , is inserted into the groove on the plug, red insulating material				CP-MSTB	17 34 63 4
(2) Marker card , with 12 pcs. 10-section marker strips, white, self-adhesive, for 120 terminal blocks			SK 5/3,8 or SK 5,08/3,8 (see COMBICON catalog)		

Technical data

Dimensions		see description on page 13		
Pitch	[mm]	5 / 5.08		
Hole diameter	[mm]	-		
Pin dimensions	[mm]x[mm]	-		
Technical data in accordance with IEC/ DIN VDE				
Insulating material group	-	I		
Surge voltage category / contamination class	-/-	III / 3	III / 2	II / 2
Rated voltage	[V]	250	320	630
Rated surge voltage	[kV]	4	4	4
Nominal current / cross section	[A]/[mm²]	16 / 2.5		
Maximum load current / cross section	[A]/[mm²]	16 / 2.5		
Capacity connection				
Solid / stranded / conductor sizes	[mm²]/[mm²]/AWG	0.2 - 2.5 / 0.2 - 2.5 / 24 - 12		
Stranded with ferrule without / with plastic sleeve	[mm²]	0.25 - 2.5 / 0.25 - 2.5		
Multiple connection (2 conductors with same cross section)				
Solid / stranded	[mm²]	0.2 - 1 / 0.2 - 1.5		
Stranded with ferrule with plastic sleeve	[mm²]	0.25 - 1		
Stranded with TWIN ferrule with plastic sleeve	[mm²]	0.5 - 1.5		
Stripping length	[mm]	7		
Internal cylindrical gauge (IEC 60 947-1)		A 3		
Thread		M 3		
Torque	[Nm]	0.5 - 0.6		
Insulating material		PA		
Inflammability class in acc. with UL 94		V0		

MSTBA 2,5 HC/...-G(-5,08) 5.0 or 5.08 mm Pitch

The designation "HC" is printed in red to provide clear identification of "high current" plugs and headers.

Only the MSTB 2,5 HC headers provided are allowed to be used for carrying the higher current load of 16 A.

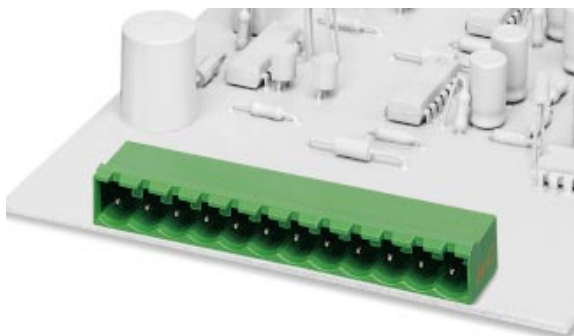

Note:

Only actuate COMBICON plug connectors when under no load condition. If for operating reasons small loads must be switched, experimental values are available upon request.

Description	No. of pos.	Dim. a [mm]	Type	Order No.	Pcs./Pkt.	
COMBICON HC headers, 5.0 mm pitch, plug-in direction parallel to the p.c.b., color: green						
	2	5	MSTBA 2,5 HC/2-G	19 23 75 9	50	
	3	10	MSTBA 2,5 HC/3-G	19 23 76 2		
	4	15	MSTBA 2,5 HC/4-G	19 23 77 5		
	5	20	MSTBA 2,5 HC/5-G	19 23 78 8		
	6	25	MSTBA 2,5 HC/6-G	19 23 79 1		
	7	30	MSTBA 2,5 HC/7-G	19 23 80 1		
	8	35	MSTBA 2,5 HC/8-G	19 23 81 4		
	9	40	MSTBA 2,5 HC/9-G	19 23 82 7		
	10	45	MSTBA 2,5 HC/10-G	19 23 83 0		
	11	50	MSTBA 2,5 HC/11-G	19 23 84 3		
	12	55	MSTBA 2,5 HC/12-G	19 23 85 6		
COMBICON HC headers, 5.08 mm pitch, plug-in direction parallel to the p.c.b., color: green						
	2	5.08	MSTBA 2,5 HC/2-G-5,08	19 23 86 9	50	
	3	10.16	MSTBA 2,5 HC/3-G-5,08	19 23 87 2		
	4	15.24	MSTBA 2,5 HC/4-G-5,08	19 23 88 5		
	5	20.32	MSTBA 2,5 HC/5-G-5,08	19 23 89 8		
	6	25.40	MSTBA 2,5 HC/6-G-5,08	19 23 90 8		
	7	30.48	MSTBA 2,5 HC/7-G-5,08	19 23 91 1		
	8	35.56	MSTBA 2,5 HC/8-G-5,08	19 23 92 4		
	9	40.64	MSTBA 2,5 HC/9-G-5,08	19 23 93 7		
	10	45.72	MSTBA 2,5 HC/10-G-5,08	19 23 94 0		
	11	50.80	MSTBA 2,5 HC/11-G-5,08	19 12 95 3		
	12	55.88	MSTBA 2,5 HC/12-G-5,08	19 12 96 6		
(1) Coding section , inserted into the recess in the header, red insulating material 						
				CR-MSTB	17 34 40 1	100
(2) Marker card , with 12 pcs. 10-section marker strips, white, self-adhesive, for 120 terminal blocks						
				SK 5/3,8 or SK 5,08/3,8 (see COMBICON catalog)		

Technical data

Dimensions		see description			
Pitch	[mm]	5 / 5.08			
Hole diameter	[mm]	1.4			
Pin dimensions	[mm]x[mm]	1 x 1			
Technical data in accordance with IEC/ DIN VDE					
Insulating material group	-	IIIa			
Surge voltage category / contamination class	-/-	III / 3	III / 2	II / 2	
Rated voltage	[V]	250	320	400	
Rated surge voltage	[kV]	4	4	4	
Nominal current / cross section	[A]/[mm²]	16 / -			
Maximum load current / cross section	[A]/[mm²]	16 / -			
Insulating material					
Inflammability class in acc. with UL 94		PBT V0			

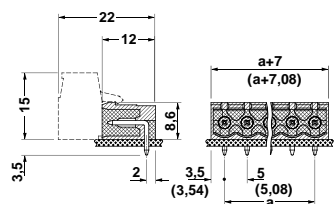
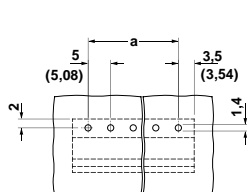

MSTBVA 2,5 HC/...-G(-5,08) 5.0 or 5.08 mm Pitch

The designation "HC" is printed in red to provide clear identification of "high current" plugs and headers.

Only the MSTB 2,5 HC headers provided are allowed to be used for carrying the higher current load of 16 A.

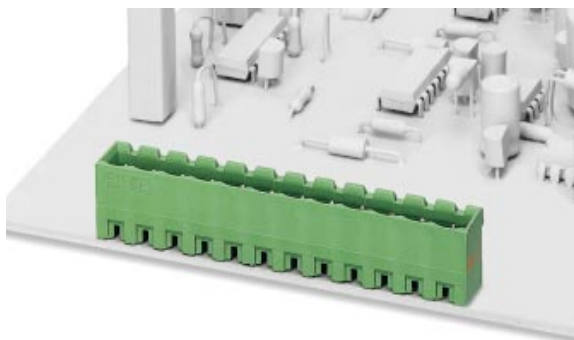

Note:

Only actuate COMBICON plug connectors when under no load condition. If for operating reasons small loads must be switched, experimental values are available upon request.

Description	No. of pos.	Dim. a [mm]	Type	Order No.	Pcs./Pkt.
COMBICON HC headers vertical, 5.0 mm pitch, color: green, plug-in direction vertical to the p.c.b.	2	5	MSTBVA 2,5 HC/2-G	19 24 19 8	50
	3	10	MSTBVA 2,5 HC/3-G	19 24 20 8	
	4	15	MSTBVA 2,5 HC/4-G	19 24 21 1	
	5	20	MSTBVA 2,5 HC/5-G	19 24 22 4	
	6	25	MSTBVA 2,5 HC/6-G	19 24 23 7	
	7	30	MSTBVA 2,5 HC/7-G	19 24 24 0	
	8	35	MSTBVA 2,5 HC/8-G	19 24 25 3	
	9	40	MSTBVA 2,5 HC/9-G	19 24 26 6	
	10	45	MSTBVA 2,5 HC/10-G	19 24 27 9	
	11	50	MSTBVA 2,5 HC/11-G	19 24 28 2	
	12	55	MSTBVA 2,5 HC/12-G	19 24 29 5	
	COMBICON HC headers vertical, 5.08 mm pitch, color: green, plug-in direction vertical to the p.c.b.	2	5.08	MSTBVA 2,5 HC/2-G-5,08	
3		10.16	MSTBVA 2,5 HC/3-G-5,08	19 24 31 8	
4		15.24	MSTBVA 2,5 HC/4-G-5,08	19 24 32 1	
5		20.32	MSTBVA 2,5 HC/5-G-5,08	19 24 33 4	
6		25.40	MSTBVA 2,5 HC/6-G-5,08	19 24 34 7	
7		30.48	MSTBVA 2,5 HC/7-G-5,08	19 24 35 0	
8		35.56	MSTBVA 2,5 HC/8-G-5,08	19 24 36 3	
9		40.64	MSTBVA 2,5 HC/9-G-5,08	19 24 37 6	
10		45.72	MSTBVA 2,5 HC/10-G-5,08	19 24 38 9	
11		50.80	MSTBVA 2,5 HC/11-G-5,08	19 24 39 2	
12		55.88	MSTBVA 2,5 HC/12-G-5,08	19 24 40 2	
(1) Coding section , inserted into the recess in the header, red insulating material 				CR-MSTB	17 34 40 1
(2) Marker card , with 12 pcs. 10-section marker strips, white, self-adhesive, for 120 terminal blocks			SK 5/3,8 or SK 5,08/3,8 (see COMBICON catalog)		

Technical data

Dimensions			
Pitch	[mm]		see description
Hole diameter	[mm]		5 / 5.08
Pin dimensions	[mm]x[mm]		1.4
Technical data in accordance with IEC/ DIN VDE			1 x 1
Insulating material group	-		I
Surge voltage category / contamination class	-/-	III / 3	III / 2
Rated voltage	[V]	250	320
Rated surge voltage	[kV]	4	4
Nominal current / cross section	[A]/[mm²]		16 / -
Maximum load current / cross section	[A]/[mm²]		16 / -
Insulating material			PA
Inflammability class in acc. with UL 94			V0

Dimensions			
Pitch	[mm]		see description
Hole diameter	[mm]		5 / 5.08
Pin dimensions	[mm]x[mm]		1.4
Technical data in accordance with IEC/ DIN VDE			1 x 1
Insulating material group	-		I
Surge voltage category / contamination class	-/-	III / 3	III / 2
Rated voltage	[V]	250	320
Rated surge voltage	[kV]	4	4
Nominal current / cross section	[A]/[mm²]		16 / -
Maximum load current / cross section	[A]/[mm²]		16 / -
Insulating material			PA
Inflammability class in acc. with UL 94			V0

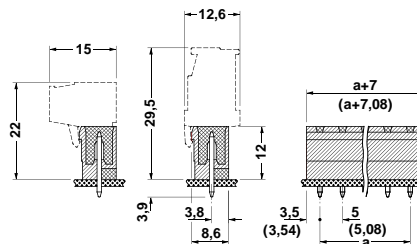
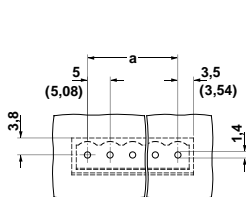

MSTB 2,5 HC/...-GF(-5,08) with Screw Flange 5.0 or 5.08 mm Pitch

The designation "HC" is printed in red to provide clear identification of "high current" plugs and headers.

Only the MSTB 2,5 HC headers provided are allowed to be used for carrying the higher current load of 16 A.

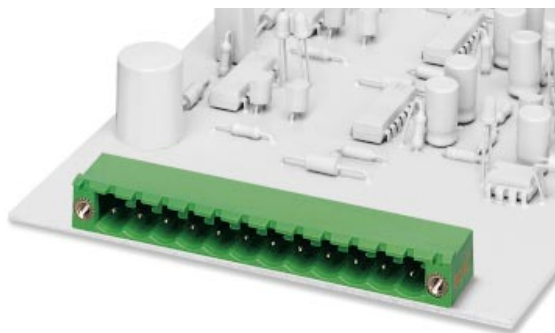

Note:

Only actuate COMBICON plug connectors when under no load condition. If for operating reasons small loads must be switched, experimental values are available upon request.

Description	No. of pos.	Dim. a [mm]	Type	Order No.	Pcs./Pkt.
COMBICON HC headers, 5.0 mm pitch, color: green, with threaded flange, plug-in direction parallel to the p.c.b.					
	2	5	MSTB 2,5 HC/2-GF	19 23 97 9	50
	3	10	MSTB 2,5 HC/3-GF	19 23 98 2	
	4	15	MSTB 2,5 HC/4-GF	19 23 99 5	
	5	20	MSTB 2,5 HC/5-GF	19 24 00 4	
	6	25	MSTB 2,5 HC/6-GF	19 24 01 7	
	7	30	MSTB 2,5 HC/7-GF	19 24 02 0	
	8	35	MSTB 2,5 HC/8-GF	19 24 03 3	
	9	40	MSTB 2,5 HC/9-GF	19 24 04 6	
	10	45	MSTB 2,5 HC/10-GF	19 24 05 9	
	11	50	MSTB 2,5 HC/11-GF	19 24 06 2	
	12	55	MSTB 2,5 HC/12-GF	19 24 07 5	
COMBICON HC headers, 5.08 mm pitch, color: green, with threaded flange plug-in direction parallel to the p.c.b.					
	2	5.08	MSTB 2,5 HC/2-GF-5,08	19 24 08 8	50
	3	10.16	MSTB 2,5 HC/3-GF-5,08	19 24 09 1	
	4	15.24	MSTB 2,5 HC/4-GF-5,08	19 24 10 1	
	5	20.32	MSTB 2,5 HC/5-GF-5,08	19 24 11 4	
	6	25.40	MSTB 2,5 HC/6-GF-5,08	19 24 12 7	
	7	30.48	MSTB 2,5 HC/7-GF-5,08	19 24 13 0	
	8	35.56	MSTB 2,5 HC/8-GF-5,08	19 24 14 3	
	9	40.64	MSTB 2,5 HC/9-GF-5,08	19 24 15 6	
	10	45.72	MSTB 2,5 HC/10-GF-5,08	19 24 16 9	
	11	50.80	MSTB 2,5 HC/11-GF-5,08	19 24 17 2	
	12	55.88	MSTB 2,5 HC/12-GF-5,08	19 24 18 5	
(1) Coding section , inserted into the recess in the header, red insulating material 			CR-MSTB	17 34 40 1	
(2) Marker card , with 12 pcs. 10-section marker strips, white, self-adhesive, for 120 terminal blocks			SK 5/3,8 or SK 5,08/3,8 (see COMBICON catalog)		

Technical data

Dimensions		see description		
Pitch	[mm]	5 / 5.08		
Hole diameter	[mm]	1.4		
Pin dimensions	[mm]x[mm]	1 x 1		
Technical data in accordance with IEC/ DIN VDE				
Insulating material group	-	IIIa		
Surge voltage category / contamination class	-/-	III / 3	III / 2	II / 2
Rated voltage	[V]	250	320	400
Rated surge voltage	[kV]	4	4	4
Nominal current / cross section	[A]/[mm²]	16 / -		
Maximum load current / cross section	[A]/[mm²]	16 / -		
Insulating material		PBT		
Inflammability class in acc. with UL 94		V0		

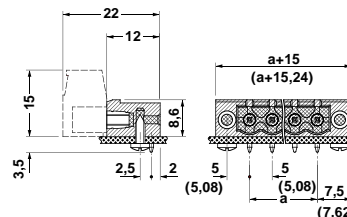
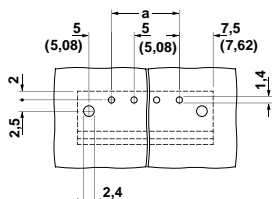

MSTBV 2,5 HC/...-GF(-5,08) with Screw Flange 5.0 or 5.08 mm Pitch

The designation "HC" is printed in red to provide clear identification of "high current" plugs and headers.

Only the MSTB 2,5 HC headers provided are allowed to be used for carrying the higher current load of 16 A.

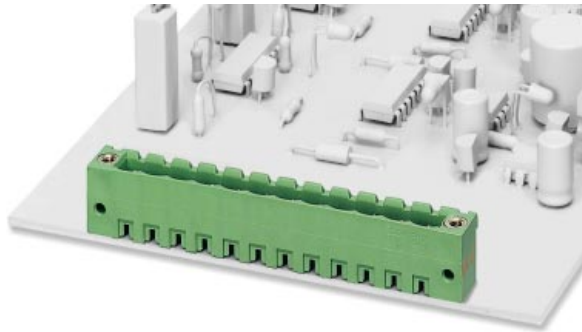

Note:

Only actuate COMBICON plug connectors when under no load condition. If for operating reasons small loads must be switched, experimental values are available upon request.

Description	No. of pos.	Dim. a [mm]	Type	Order No.	Pcs./Pkt.
COMBICON HC headers vertical, 5.0 mm pitch, color: green, with threaded flange, plug-in direction vertical to the p.c.b.					
	2	5	MSTBV 2,5 HC/2-GF	19 24 41 5	50
	3	10	MSTBV 2,5 HC/3-GF	19 24 42 8	
	4	15	MSTBV 2,5 HC/4-GF	19 24 43 1	
	5	20	MSTBV 2,5 HC/5-GF	19 24 44 4	
	6	25	MSTBV 2,5 HC/6-GF	19 24 45 7	
	7	30	MSTBV 2,5 HC/7-GF	19 24 46 0	
	8	35	MSTBV 2,5 HC/8-GF	19 24 47 3	
	9	40	MSTBV 2,5 HC/9-GF	19 24 48 6	
	10	45	MSTBV 2,5 HC/10-GF	19 24 49 9	
	11	50	MSTBV 2,5 HC/11-GF	19 24 50 9	
	12	55	MSTBV 2,5 HC/12-GF	19 24 51 2	
COMBICON HC headers vertical, 5.08 mm pitch, color: green, with threaded flange, plug-in direction vertical to the p.c.b.					
	2	5.08	MSTBV 2,5 HC/2-GF-5,08	19 24 52 5	50
	3	10.16	MSTBV 2,5 HC/3-GF-5,08	19 24 53 8	
	4	15.24	MSTBV 2,5 HC/4-GF-5,08	19 24 54 1	
	5	20.32	MSTBV 2,5 HC/5-GF-5,08	19 24 55 4	
	6	25.40	MSTBV 2,5 HC/6-GF-5,08	19 24 56 7	
	7	30.48	MSTBV 2,5 HC/7-GF-5,08	19 24 57 0	
	8	35.56	MSTBV 2,5 HC/8-GF-5,08	19 24 58 3	
	9	40.64	MSTBV 2,5 HC/9-GF-5,08	19 24 59 6	
	10	45.72	MSTBV 2,5 HC/10-GF-5,08	19 24 60 6	
	11	50.80	MSTBV 2,5 HC/11-GF-5,08	19 24 61 9	
	12	55.88	MSTBV 2,5 HC/12-GF-5,08	19 24 62 2	
(1) Coding section , inserted into the recess in the header, red insulating material 			CR-MSTB	17 34 40 1	
(2) Marker card , with 12 pcs. 10-section marker strips, white, self-adhesive, for 120 terminal blocks			SK 5/3,8 or SK 5,08/3,8 (see COMBICON catalog)		

Technical data

Dimensions		see description		
Pitch	[mm]	5 / 5.08		
Hole diameter	[mm]	1.4		
Pin dimensions	[mm]x[mm]	1 x 1		
Technical data in accordance with IEC/ DIN VDE				
Insulating material group	-	I		
Surge voltage category / contamination class	-/-	III / 3	III / 2	II / 2
Rated voltage	[V]	250	320	400
Rated surge voltage	[kV]	4	4	4
Nominal current / cross section	[A]/[mm ²]	16 / -		
Maximum load current / cross section	[A]/[mm ²]	16 / -		
Insulating material		PA		
Inflammability class in acc. with UL 94		V0		

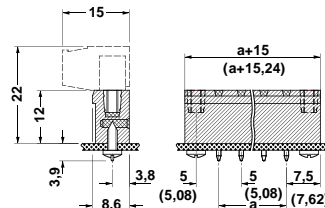
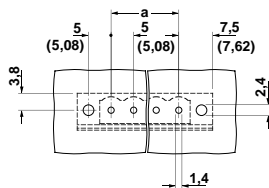

Descriptions

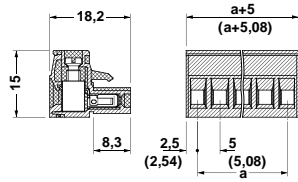

MSTB 2,5 HC/...-ST(-5,08)

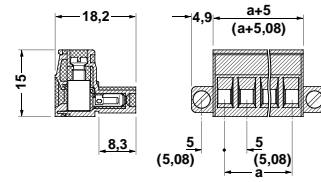

MSTB 2,5 HC/...-STF(-5,08)

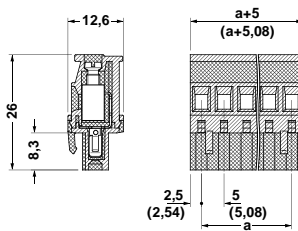

MVSTBR 2,5 HC/...-ST(-5,08)

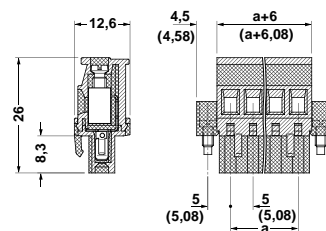

MVSTBR 2,5 HC/...-STF(-5,08)

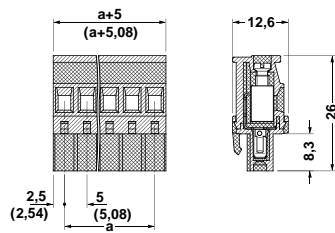

MVSTBW 2,5 HC/...-STF(-5,08)

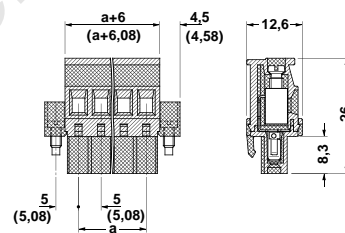

MVSTBW 2,5 HC/...-STF(-5,08)

onlinecomponents.com