

PCB terminal block - MKDSP 25/ 1-15,00-FL - 1932575

Please be informed that the data shown in this PDF Document is generated from our Online Catalog. Please find the complete data in the user's documentation. Our General Terms of Use for Downloads are valid (<http://phoenixcontact.com/download>)



PCB terminal block, Nominal current: 125 A, Nom. voltage: 1000 V, Pitch: 15 mm, Number of positions: 1, Connection method: Screw connection with tension sleeve, Mounting: Wave soldering, Conductor/PCB connection direction: 0 °, Color: green, Avoid placing permanent mechanical loads on the terminal

The figure shows a 1-pos. version of the product

Product Features

- Well-known connection principle allows worldwide use
- Low temperature rise, thanks to maximum contact force
- Allows connection of two conductors
- Quick and convenient testing using integrated test option
- Mounting flanges reduce the mechanical strain on the soldering spots
- Integrated protective guide prevents incorrect insertion of the conductor underneath the tension sleeve



Key Commercial Data

| | |
|--------------------------------------|----------|
| Packing unit | 1 pc |
| Minimum order quantity | 25 pc |
| Weight per Piece (excluding packing) | 22.9 g |
| Custom tariff number | 85369010 |
| Country of origin | Bulgaria |

Technical data

Dimensions

| | |
|-----------------------|--------------|
| Length | 31 mm |
| Pitch | 15.00 mm |
| Constructional height | 39 mm |
| Pin dimensions | 1,2 x 1,2 mm |
| Hole diameter | 1.6 mm |

PCB terminal block - MKDSP 25/ 1-15,00-FL - 1932575

Technical data

General

| | |
|----------------------------------------|-----------------------------------------------------------------------------------|
| Range of articles | MKDSP 25/..-FL |
| Insulating material group | I |
| Rated surge voltage (III/3) | 8 kV |
| Rated surge voltage (III/2) | 8 kV |
| Rated surge voltage (II/2) | 8 kV |
| Rated voltage (III/3) | 1000 V |
| Rated voltage (III/2) | 1000 V |
| Rated voltage (II/2) | 1000 V |
| Connection in acc. with standard | EN-VDE |
| Nominal current I_N | 125 A |
| Nominal cross section | 35 mm ² |
| Maximum load current | 125 A |
| Insulating material | PA |
| Solder pin surface | Sn |
| Flammability rating according to UL 94 | V0 |
| Internal cylindrical gage | B7 |
| Stripping length | 18 mm |
| Number of positions | 1 |
| Screw thread | M5 |
| Tightening torque, min | 2.5 Nm |
| Tightening torque max | 4.5 Nm |
| Note | Tightening torque $\leq 25 \text{ mm}^2$ is 2.5 Nm, $> 25 \text{ mm}^2$ is 4.5 Nm |

Connection data

| | |
|----------------------------------------------------------------------------|---------------------|
| Conductor cross section solid min. | 0.5 mm ² |
| Conductor cross section solid max. | 35 mm ² |
| Conductor cross section flexible min. | 0.5 mm ² |
| Conductor cross section flexible max. | 35 mm ² |
| Conductor cross section flexible, with ferrule without plastic sleeve min. | 1 mm ² |
| Conductor cross section flexible, with ferrule without plastic sleeve max. | 35 mm ² |
| Conductor cross section flexible, with ferrule with plastic sleeve min. | 1.5 mm ² |
| Conductor cross section flexible, with ferrule with plastic sleeve max. | 35 mm ² |
| Conductor cross section AWG min. | 20 |
| Conductor cross section AWG max. | 2 |
| 2 conductors with same cross section, solid min. | 0.5 mm ² |
| 2 conductors with same cross section, solid max. | 6 mm ² |
| 2 conductors with same cross section, stranded min. | 0.5 mm ² |
| 2 conductors with same cross section, stranded max. | 6 mm ² |

PCB terminal block - MKDSP 25/ 1-15,00-FL - 1932575

Technical data

Connection data

| | |
|-----------------------------------------------------------------------------------------|---------------------|
| 2 conductors with same cross section, stranded, ferrules without plastic sleeve, min. | 0.5 mm ² |
| 2 conductors with same cross section, stranded, ferrules without plastic sleeve, max. | 4 mm ² |
| 2 conductors with same cross section, stranded, TWIN ferrules with plastic sleeve, min. | 0.5 mm ² |
| 2 conductors with same cross section, stranded, TWIN ferrules with plastic sleeve, max. | 6 mm ² |

Standards and Regulations

| | |
|----------------------------------------|--------|
| Connection in acc. with standard | EN-VDE |
| | CUL |
| Flammability rating according to UL 94 | V0 |

Classifications

eCl@ss

| | |
|------------|----------|
| eCl@ss 4.0 | 27141109 |
| eCl@ss 4.1 | 27141109 |
| eCl@ss 5.0 | 27141190 |
| eCl@ss 5.1 | 27141190 |
| eCl@ss 6.0 | 27260704 |
| eCl@ss 7.0 | 27440402 |
| eCl@ss 8.0 | 27440401 |
| eCl@ss 9.0 | 27440401 |

ETIM

| | |
|----------|----------|
| ETIM 3.0 | EC001121 |
| ETIM 4.0 | EC002643 |
| ETIM 5.0 | EC002643 |

UNSPSC

| | |
|---------------|----------|
| UNSPSC 6.01 | 30211801 |
| UNSPSC 7.0901 | 39121432 |
| UNSPSC 11 | 39121432 |
| UNSPSC 12.01 | 39121432 |
| UNSPSC 13.2 | 39121432 |

PCB terminal block - MKDSP 25/ 1-15,00-FL - 1932575

Approvals

Approvals

Approvals

SEV / CCA / IEC EE CB Scheme / SEV / EAC / EAC / cULus Recognized

Ex Approvals

Approvals submitted

Approval details

| | |
|--------------------------------|--------|
| SEV | |
| mm ² /AWG/kcmil | 35 |
| Nominal current I _N | 125 A |
| Nominal voltage U _N | 1000 V |

CCA

IECEE CB Scheme 

| | |
|--------------------------------|--------|
| SEV | |
| mm ² /AWG/kcmil | 35 |
| Nominal current I _N | 125 A |
| Nominal voltage U _N | 1000 V |

EAC

EAC

PCB terminal block - MKDSP 25/ 1-15,00-FL - 1932575

Approvals

| | | |
|--------------------------------|-------|-------|
| cULus Recognized | | |
| | B | C |
| mm ² /AWG/kcmil | 20-2 | 20-2 |
| Nominal current I _N | 115 A | 115 A |
| Nominal voltage U _N | 600 V | 600 V |

Drawings

Drilling diagram

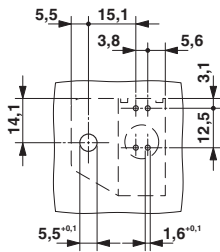

Diagram

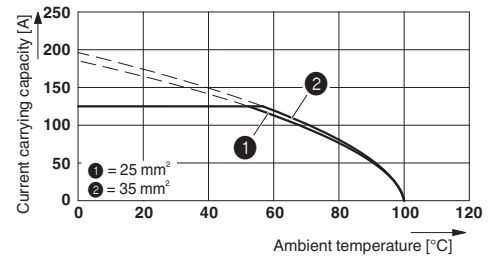

Type: MKDSP 25/...-15,00
 Tested in accordance with DIN EN 60512-5-2:2003-01
 Reduction factor = 1
 No. of positions: 5

Dimensional drawing

