

## Multi-position printed circuit termination blocks for through hole reflow applications

With the modern SMT solder technology, proven housing profiles from the printed circuit terminal block range from Phoenix Contact are today also used in the reflow process without any further geometric adaptations. The high-temperature resistant printed circuit terminal blocks have solder pins from the standard range and, compared to surface connections with SMD components, achieve high mechanical stability in combination with through-contacted holes. To cope with the variety of applications, five different types for the pitches 3.5 or 3.81 mm and 5 or 5.08 mm for connection cross sections up to 4 mm<sup>2</sup> are available. For automatic mounting, customer-specific tapes with free areas for grippers, for example, or packaging in tube magazines are possible. High-temperature resistant printed circuit terminal blocks are available as 2 to 3-position versions. Higher numbers of positions can be supplied on request.

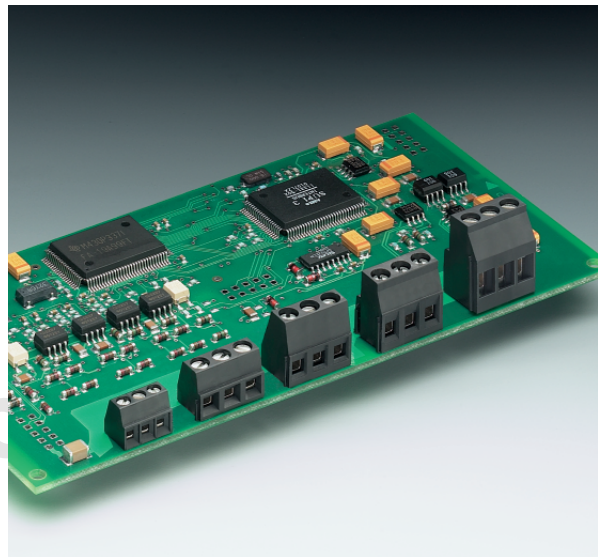

### COMBICON Select

The COMBICON search engine with CAD downloading



COMBICON Select – the printed circuit board connection software supports your workflow from the PCB and housing layout to the ordering process with:

- Systematic and fast selection of products
- Universal Internet aided engineering with extensive CAD downloading
- Easy-to-use e-shopping functions.

<http://select.phoenixcontact.com>

# MKDS 1/... HT BK

## 3.5 or 3.81 mm Pitch

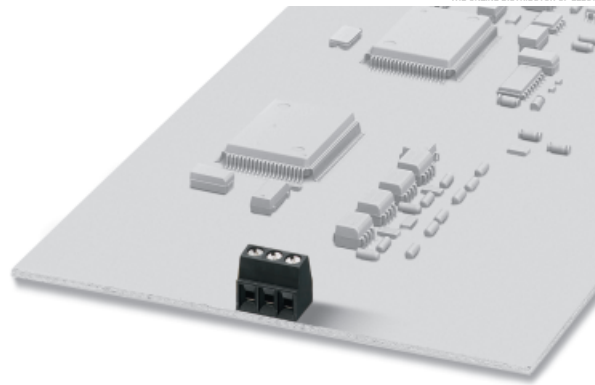

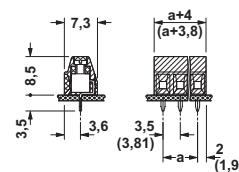
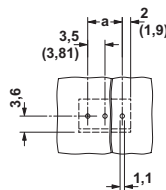

Description	Number of positions	Dim. a [mm]	Type	Order No.	Pcs./Pkt.
<b>Printed circuit screw termination blocks, 3.5 mm pitch, color: black</b>	2 3	3.5 7	<b>MKDS 1/2-3,5 HT BK</b> <b>MKDS 1/3-3,5 HT BK</b>	<b>19 85 80 7</b> <b>19 84 95 0</b>	50
<b>Printed circuit screw termination blocks, 3.81 mm pitch, color: black</b>	2 3	3.81 7.62	<b>MKDS 1/2-3,81 HT BK</b> <b>MKDS 1/3-3,81 HT BK</b>	<b>19 85 82 3</b> <b>19 85 83 6</b>	50
(1) <b>Screwdriver,</b> blade: 0.4 x 2.5 x 75 mm, length: 160 mm			<b>SZS-0,4 x 2,5</b>	<b>12 05 03 7</b>	10
(2) <b>Marker card,</b> with 14 pcs., 10-section marker strips, white, self-adhesive, for 140 terminal blocks			<b>SK 3,5/2,8 or SK 3,81/2,8</b> (see COMBICON catalog)		
<b>Technical data</b>			see description		
Dimensions			3.5 / 3.81		
Pitch		[mm]	1.1		
Hole diameter		[mm]	0.5 x 0.9		
Pin dimensions		[mm]x[mm]			
<b>Technical data in accordance with IEC/ DIN VDE</b>					
Insulating material group		-	III / 3	I	III / 2
Surge voltage category / contamination class		-/-	63	200	200
Rated voltage		[V]	2.5	2.5	2.5
Rated surge voltage		[kV]		10 / 1	
Nominal current / cross section		[A]/[mm <sup>2</sup> ]		12 / 1.5	
Maximum load current / cross section		[A]/[mm <sup>2</sup> ]			
<b>Connection capacity</b>			0.14 - 1.5 / 0.14 - 1 / 26 - 16		
Solid / stranded / conductor sizes		[mm <sup>2</sup> ]/[mm <sup>2</sup> ]/AWG	0.25 / 0.25 - 0.5		
Stranded with ferrule without / with plastic sleeve		[mm <sup>2</sup> ]			
<b>Multiple connection (2 conductors with same cross section)</b>			0.14 - 0.5 / 0.14 - 0.2		
Solid / stranded		[mm <sup>2</sup> ]	-		
Stranded with ferrules without plastic sleeve		[mm <sup>2</sup> ]	-		
Stranded with TWIN ferrule with plastic sleeve		[mm <sup>2</sup> ]	5		
<b>Stripping length</b>		[mm]	-		
<b>Internal cylindrical gauge (IEC 60 947-1)</b>		-	M 2		
<b>Thread</b>		-	0.22 - 0.25		
<b>Torque</b>		-	PA		
<b>Insulating material</b>		-	V0		
<b>Inflammability class in acc. with UL 94</b>		-			

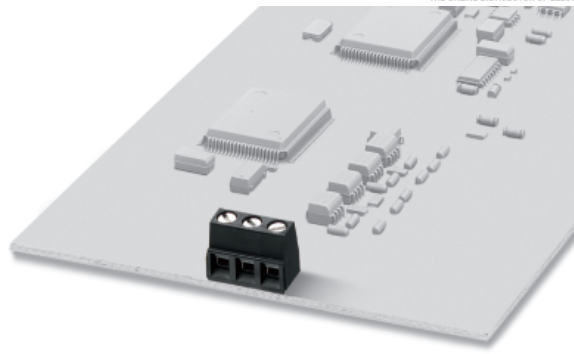

# MKDSN 1,5/...HT BK

## 5.0 or 5.08 mm Pitch



Description	Number of positions	Dim. a [mm]	Type	Order No.	Pcs./Pkt.
<b>Printed circuit screw termination blocks, 5.0 mm pitch, color: black</b>	2 3	5 10	<b>MKDSN 1,5/2 HT BK</b> <b>MKDSN 1,5/3 HT BK</b>	<b>19 85 84 9</b> <b>19 85 85 2</b>	50
<b>Printed circuit screw termination blocks, 5.08 mm pitch, color: black</b>	2 3	5.08 10.16	<b>MKDSN 1,5/2-5,08 HT BK</b> <b>MKDSN 1,5/3-5,08 HT BK</b>	<b>19 85 86 5</b> <b>19 85 87 8</b>	50
(1) <b>Screwdriver,</b> blade: 0.6 x 3.5 x 100 mm, length: 180 mm			<b>SZS 0,6 x 3,5</b>	<b>12 05 05 3</b>	10
(2) <b>Marker card,</b> with 12 pcs., 10-section marker strips, white, self-adhesive, for 120 terminal blocks			<b>SK 5/3,8 or SK 5,08/3,8</b> (see COMBICON catalog)		
<b>Technical data</b>			see description		
Dimensions			5 / 5.08		
Pitch		[mm]	1.3		
Hole diameter		[mm]	0.5 x 1		
Pin dimensions		[mm]x[mm]			
<b>Technical data in accordance with IEC/ DIN VDE</b>					
Insulating material group		-	III / 3	I	II / 2
Surge voltage category / contamination class		-/-	200	320	320
Rated voltage		[V]	4	4	4
Rated surge voltage		[kV]		13.5 / 1.5	
Nominal current / cross section		[A]/[mm <sup>2</sup> ]		13.5 / 1.5	
Maximum load current / cross section		[A]/[mm <sup>2</sup> ]		13.5 / 1.5	
<b>Connection capacity</b>					
Solid / stranded / conductor sizes		[mm <sup>2</sup> ]/[mm <sup>2</sup> ]/AWG	0.14 - 1.5 / 0.14 - 1.5 / 26 - 16		
Stranded with ferrule without / with plastic sleeve		[mm <sup>2</sup> ]	0.25 - 1.0 / 0.25 - 1.5		
<b>Multiple connection (2 conductors with same cross section)</b>					
Solid / stranded		[mm <sup>2</sup> ]	0.14 - 0.75 / 0.14 - 0.75		
Stranded with ferrules without plastic sleeve		[mm <sup>2</sup> ]	0.25 - 0.5		
Stranded with TWIN ferrule with plastic sleeve		[mm <sup>2</sup> ]	0.5 - 1		
<b>Stripping length</b>		[mm]	6		
<b>Internal cylindrical gauge (IEC 60 947-1)</b>		-	A 1		
<b>Thread</b>		-	M 3		
<b>Torque</b>		-	0.5 - 0.6		
<b>Insulating material</b>		-	PA		
<b>Inflammability class in acc. with UL 94</b>		-	V0		

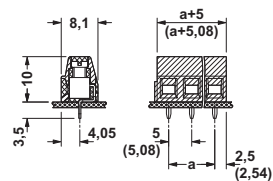
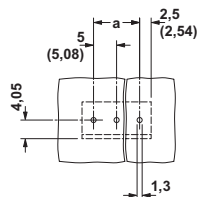

# MKDS 1,5/...HT BK 5.0 or 5.08 mm Pitch

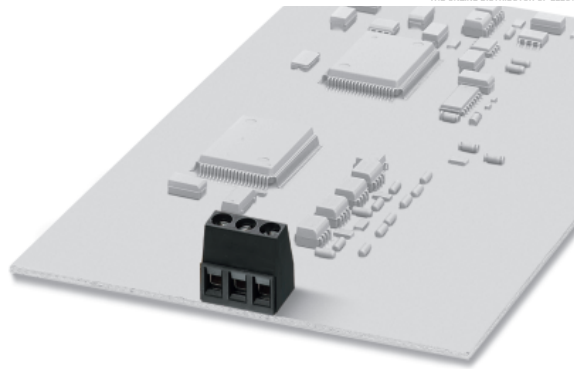

Description	Number of positions	Dim. a [mm]	Type	Order No.	Pcs./Pkt.
<b>Printed circuit screw termination blocks, 5.0 mm pitch, color: black</b>	2 3	5 10	<b>MKDS 1,5/2 HT BK</b> <b>MKDS 1,5/3 HT BK</b>	<b>19 85 88 1</b> <b>19 85 89 4</b>	50
<b>Printed circuit screw termination blocks, 5.08 mm pitch, color: black</b>	2 3	5.08 10.16	<b>MKDS 1,5/2-5,08 HT BK</b> <b>MKDS 1,5/3-5,08 HT BK</b>	<b>19 85 90 4</b> <b>19 85 91 7</b>	50
(1) <b>Screwdriver,</b> blade: 0.6 x 3.5 x 100 mm, length: 180 mm			<b>SZS 0,6 x 3,5</b>	<b>12 05 05 3</b>	10
(2) <b>Marker card,</b> with 12 pcs., 10-section marker strips, white, self-adhesive, for 120 terminal blocks			<b>SK 5/3,8 or SK 5,08/3,8</b> (see COMBICON catalog)		
<b>Technical data</b>			see description		
Dimensions			5 / 5.08		
Pitch		[mm]	1.3		
Hole diameter		[mm]	0.9 x 0.9		
Pin dimensions		[mm]x[mm]			
<b>Technical data in accordance with IEC/ DIN VDE</b>					
Insulating material group		-	III / 3	I	II / 2
Surge voltage category / contamination class		-/-	200	320	320
Rated voltage		[V]	4	4	4
Rated surge voltage		[kV]		17.5 / 1.5	
Nominal current / cross section		[A]/[mm <sup>2</sup> ]		24 / 2.5	
Maximum load current / cross section		[A]/[mm <sup>2</sup> ]			
<b>Connection capacity</b>			0.14 - 2.5 / 0.14 - 1.5 / 26 - 14		
Solid / stranded / conductor sizes		[mm <sup>2</sup> ]/[mm <sup>2</sup> ]/AWG	0.25 - 1.5 / 0.25 - 1.5		
Stranded with ferrule without / with plastic sleeve		[mm <sup>2</sup> ]			
<b>Multiple connection (2 conductors with same cross section)</b>			0.14 - 1 / 0.14 - 0.75		
Solid / stranded		[mm <sup>2</sup> ]	0.25 - 0.5		
Stranded with ferrules without plastic sleeve		[mm <sup>2</sup> ]	0.5 - 1		
Stranded with TWIN ferrule with plastic sleeve		[mm <sup>2</sup> ]	7		
<b>Stripping length</b>		[mm]	A 1		
<b>Internal cylindrical gauge (IEC 60 947-1)</b>		-	M 3		
<b>Thread</b>		-	0.5 - 0.6		
<b>Torque</b>		-	PA		
<b>Insulating material</b>		-	V0		
<b>Inflammability class in acc. with UL 94</b>		-			

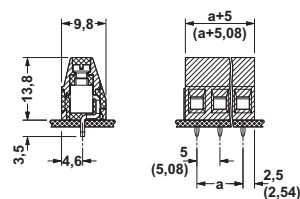
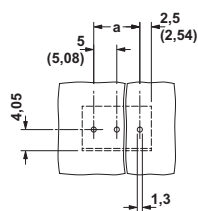

# MKDSN 2,5/...HT BK 5.0 or 5.08 mm Pitch

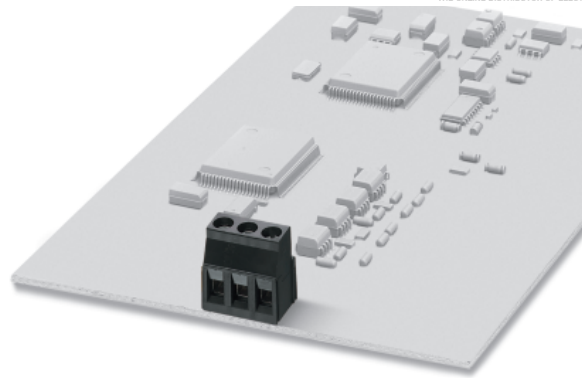

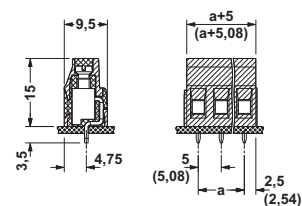
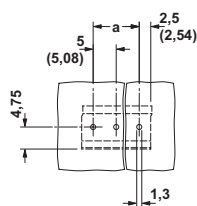

Description	Number of positions	Dim. a [mm]	Type	Order No.	Pcs./Pkt.
<b>Printed circuit screw termination blocks, 5.0 mm pitch, color: black</b>	2 3	5 10	<b>MKDSN 2,5/2 HT BK</b> <b>MKDSN 2,5/3 HT BK</b>	<b>19 85 92 0</b> <b>19 85 93 3</b>	50
<b>Printed circuit screw termination blocks, 5.08 mm pitch, color: black</b>	2 3	5.08 10.16	<b>MKDSN 2,5/2-5,08 HT BK</b> <b>MKDSN 2,5/3-5,08 HT BK</b>	<b>19 85 94 6</b> <b>19 85 95 9</b>	50
(1) <b>Screwdriver</b> , blade: 0.6 x 3.5 x 100 mm, length: 180 mm			<b>SZS 0,6 x 3,5</b>	<b>12 05 05 3</b>	10
(2) <b>Marker card</b> , with 12 pcs., 10-section marker strips, white, self-adhesive, for 120 terminal blocks			<b>SK 5/3,8 or SK 5,08/3,8</b> (see COMBICON catalog)		
<b>Technical data</b>			see description		
Dimensions			5 / 5.08		
Pitch		[mm]	1.3		
Hole diameter		[mm]	0.8 x 0.9		
Pin dimensions		[mm]x[mm]			
<b>Technical data in accordance with IEC/ DIN VDE</b>					
Insulating material group		-	III / 3	I	II / 2
Surge voltage category / contamination class		-/-	200	320	320
Rated voltage		[V]	4	4	4
Rated surge voltage		[kV]		16 / 2.5	
Nominal current / cross section		[A]/[mm²]		16 / 2.5	
Maximum load current / cross section		[A]/[mm²]			
<b>Connection capacity</b>			0.2 - 2.5 / 0.2 - 2.5 / 24 - 14		
Solid / stranded / conductor sizes		[mm²]/[mm²]/AWG	0.25 - 2.5 / 0.25 - 2.5		
Stranded with ferrule without / with plastic sleeve		[mm²]			
<b>Multiple connection (2 conductors with same cross section)</b>			0.2 - 0.75 / 0.2 - 0.75		
Solid / stranded		[mm²]	0.25 - 0.75		
Stranded with ferrules without plastic sleeve		[mm²]	0.5 - 1.5		
Stranded with TWIN ferrule with plastic sleeve		[mm²]	6.5		
<b>Stripping length</b>		[mm]	A 3		
<b>Internal cylindrical gauge (IEC 60 947-1)</b>		-	M 3		
<b>Thread</b>		-	0.5 - 0.6		
<b>Torque</b>		-	PA		
<b>Insulating material</b>		-	V0		
<b>Inflammability class in acc. with UL 94</b>		-			

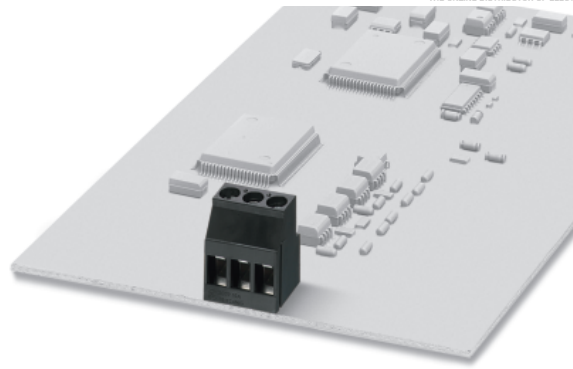

# MKDS 3/... HT BK

## 5.0 or 5.08 mm Pitch



Description	Number of positions	Dim. a [mm]	Type	Order No.	Pcs./Pkt.
<b>Printed circuit screw termination blocks, 5.0 mm pitch, color: black</b>	2 3	5 10	<b>MKDS 3/2 HT BK</b> <b>MKDS 3/3 HT BK</b>	<b>19 85 96 2</b> <b>19 85 97 5</b>	50
<b>Printed circuit screw termination blocks, 5.08 mm pitch, color: black</b>	2 3	5.08 10.16	<b>MKDS 3/2-5,08 HT BK</b> <b>MKDS 3/3-5,08 HT BK</b>	<b>19 85 98 8</b> <b>19 85 99 1</b>	50
(1) <b>Screwdriver</b> , blade: 0.6 x 3.5 x 100 mm, length: 180 mm			<b>SZS 0,6 x 3,5</b>	<b>12 05 05 3</b>	10
(2) <b>Marker card</b> , with 12 pcs., 10-section marker strips, white, self-adhesive, for 120 terminal blocks			<b>SK 5/3,8 or SK 5,08/3,8</b> (see COMBICON catalog)		
<b>Technical data</b>			see description		
Dimensions			5 / 5.08		
Pitch		[mm]	1.3		
Hole diameter		[mm]	0.9 x 0.9		
Pin dimensions		[mm]x[mm]			
<b>Technical data in accordance with IEC/ DIN VDE</b>					
Insulating material group		-	III / 3	I	II / 2
Surge voltage category / contamination class		-/-	III / 2	320	320
Rated voltage		[V]	200	4	4
Rated surge voltage		[kV]	4	24 / 2.5	28 / 4
Nominal current / cross section		[A]/[mm <sup>2</sup> ]			
Maximum load current / cross section		[A]/[mm <sup>2</sup> ]			
<b>Connection capacity</b>			0.2 - 4 / 0.2 - 2.5 / 24 - 12		
Solid / stranded / conductor sizes		[mm <sup>2</sup> ]/[mm <sup>2</sup> ]/AWG	0.25 - 2.5 / 0.25 - 1.5		
Stranded with ferrule without / with plastic sleeve		[mm <sup>2</sup> ]			
<b>Multiple connection (2 conductors with same cross section)</b>			0.2 - 1.5 / 0.2 - 1.5		
Solid / stranded		[mm <sup>2</sup> ]	0.25 - 0.75		
Stranded with ferrules without plastic sleeve		[mm <sup>2</sup> ]	0.5 - 1.5		
Stranded with TWIN ferrule with plastic sleeve		[mm <sup>2</sup> ]	7		
<b>Stripping length</b>		[mm]	A 3		
<b>Internal cylindrical gauge (IEC 60 947-1)</b>		-	M 3		
<b>Thread</b>		-	0.5 - 0.6		
<b>Torque</b>		-	PA		
<b>Insulating material</b>		-	V0		
<b>Inflammability class in acc. with UL 94</b>		-			

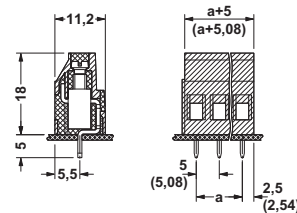
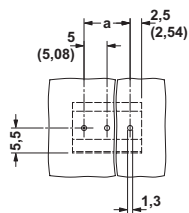

http://www.phoenixcontact.com  
© Phoenix Contact 15.03.03 TNR: 5152717-00