

Motor Pigtail Connectors

Quick, reliable change-out of electric motors with no bolting, taping or loose connections.
One Line to One Load (two wire)

C o m p r e s s i o n

- Complete line of motor lead disconnects for 600V and 5 kV applications, covering wire range from #16 through 4/0 AWG
- Fast, snap-together assembly offers maximum labor savings
- No need for nuts, bolts and washers or insulating tape – simply slide on reusable boot
- Total assembly fits into tight motor housings
- Quick disconnect – no knife cutting of melted tape, eliminating the risk of accidental cutting of wire insulation, resulting motor downtime an installer exposure
- Meet or exceed electrical and mechanical performance of bolted connections
- Constructed of high-conductivity copper with tin-plating
- Female disconnects equipped with beryllium copper interface band for dependable connections

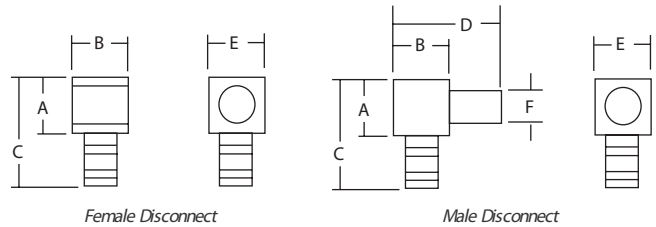

CAT. NO. Certified to 600V		Wire Size	Body Size	Color Code	Boot insulation	Dimensions in. (mm)						Strip Length (in.)
Female Disconnect	Male Disconnect					A	B	C	D	E	F	
MD1614F-0	MD1614M-0	16-14 AWG	0	Blue	MDBOOT-0	0.25 (6.4)	0.25 (6.4)	0.63 (16.0)	0.52 (13.2)	0.25 (6.4)	0.13 (3.2)	3/8
MD1614F-1	MD1614M-1	16-14 AWG	1	Blue	MDBOOT-1	0.38 (9.7)	0.38 (9.7)	0.78 (19.8)	0.75 (19.1)	0.38 (9.7)	0.25 (6.4)	3/8
MD1210F-1	MD1210M-1	12-10 AWG	1	Yellow	MDBOOT-1	0.38 (9.7)	0.35 (8.9)	0.78 (19.8)	0.75 (19.1)	0.38 (9.7)	0.25 (6.4)	3/8
MD1210F-2	MD1210M-2	12-10 AWG	2	Yellow	MDBOOT-2	0.50 (12.7)	0.50 (12.7)	0.90 (22.9)	1.00 (25.4)	0.50 (12.7)	0.37 (9.4)	3/8
MD8F-1	MD8M-1	8 AWG	1	Red	MDBOOT-1	0.38 (9.7)	0.38 (9.7)	0.82 (20.8)	0.75 (19.1)	0.38 (9.7)	0.25 (6.4)	7/16
MD8F-2	MD8M-2	8 AWG	2	Red	MDBOOT-2	0.50 (12.7)	0.50 (12.7)	0.95 (24.1)	1.00 (25.4)	0.50 (12.7)	0.37 (9.4)	7/16
MD6F-1	MD6M-1	6 AWG	1	Blue	MDBOOT-1	0.38 (9.7)	0.38 (9.7)	0.88 (22.4)	0.75 (19.1)	0.38 (9.7)	0.25 (6.4)	1/2
MD6F-2	MD6M-2	6 AWG	2	Blue	MDBOOT-2	0.50 (12.7)	0.50 (12.7)	1.02 (30.5)	1.00 (25.4)	0.50 (12.7)	0.37 (9.4)	1/2
MD4F-2	MD4M-2	4 AWG	2	Grey	MDBOOT-2	0.50 (12.7)	0.50 (12.7)	1.03 (40.6)	1.00 (25.4)	0.50 (12.7)	0.37 (9.4)	1/2
MD2F-2	MD2M-2	2 AWG	2	Brown	MDBOOT-2	0.50 (12.7)	0.50 (12.7)	1.09 (48.3)	1.00 (25.4)	0.50 (12.7)	0.37 (9.4)	17/32
MD2F-3	MD2M-3	2 AWG	3	Brown	MDBOOT-3	0.88 (22.4)	0.88 (22.4)	1.46 (37.1)	1.75 (44.5)	0.88 (22.4)	0.50 (12.7)	17/32
MD1F-2	MD1M-2	1 AWG	2	Green	MDBOOT-2	0.50 (12.7)	0.50 (12.7)	1.23 (31.2)	1.00 (25.4)	0.50 (12.7)	0.37 (9.4)	9/16
MD1F-3	MD1M-3	1 AWG	3	Green	MDBOOT-3	0.88 (22.4)	0.88 (22.4)	1.56 (39.6)	1.75 (44.5)	0.88 (22.4)	0.50 (12.7)	9/16
MD10F-3	MD10M-3	1/0 AWG	3	Pink	MDBOOT-3	0.88 (22.4)	0.88 (22.4)	1.56 (39.6)	1.75 (44.5)	0.88 (22.4)	0.50 (12.7)	9/16
MD20F-3	MD20M-3	2/0 AWG	3	Black	MDBOOT-3	0.88 (22.4)	0.88 (22.4)	1.59 (40.4)	1.75 (44.5)	0.88 (22.4)	0.50 (12.7)	5/8
MD30F-3	MD30M-3	3/0 AWG	3	Orange	MDBOOT-3	0.88 (22.4)	0.88 (22.4)	1.71 (43.4)	1.75 (44.5)	0.88 (22.4)	0.50 (12.7)	11/16
MD40F-3	MD40M-3	4/0 AWG	3	Purple	MDBOOT-3	0.88 (22.4)	0.88 (22.4)	1.81 (46.0)	1.75 (44.5)	0.88 (22.4)	0.50 (12.7)	3/4
MD40F-4	MD40M-4	4/0 AWG	4	Purple	MDBOOT-4	1.25 (31.8)	1.25 (31.8)	2.89 (73.4)	2.69 (68.3)	1.25 (31.8)	0.81 (22.4)	-
MD250F-4	MD250M-4	250 kcmil	4	Yellow	MDBOOT-4	1.25 (31.8)	1.25 (31.8)	2.89 (73.4)	2.69 (68.3)	1.25 (31.8)	0.81 (22.4)	-
MD350F-4	MD350M-4	350 kcmil	4	Red	MDBOOT-4	1.25 (31.8)	1.25 (31.8)	2.89 (73.4)	2.69 (68.3)	1.25 (31.8)	0.81 (22.4)	-
MD500F-4	MD500M-4	500 kcmil	4	Brown	MDBOOT-4	1.25 (31.8)	1.25 (31.8)	2.89 (73.4)	2.69 (68.3)	1.25 (31.8)	0.81 (22.4)	-

Kits: page 66
 Tooling: pp. 110-139
 Die Selector Chart: pp. 140-147

Motor Pigtail Connectors

One Line to One Load (2 Wire)

(Continued)

Quick, easy installation!

- 1 Choose appropriate Color-Keyed® disconnect for conductor size to be terminated. Note color of bands on disconnect barrel.
- 2 Select proper installing die by matching die color to disconnect barrel color bands.
- 3 Install die in T&B tool, insert stripped wire into barrel of disconnect and compress between color bands. Repeat for mating half.
- 4 Snap the two halves together and slip on insulator over mated connection. Secure insulator with TY-Rap® cable ties provided with the insulators.

Material: High-Conductivity Copper

Finish: Tin

Insulator: Thermoplastic Elastomer

Contact Material: Beryllium Copper



600V Version



5 kV Version



C o m p r e s s i o n

CAT. NO. Certified to 600V		WT112M WT111M WT2000 ERG2002	TBM25S TBM20S	Installing Tools					
				TBM6, TBM6S, TBM6ORS		TBM5 TBM5S	TBM8 TBM8S	Hydraulic Tools and TBM50S Hand Tool	
				Upper Die	Lower Die	Die Set	Die Set	Die Code	Color
Female Disconnect	Male Disconnect								
MD1614F-0	MD1614M-0	X	-	-	-	-	-	-	-
MD1614F-1	MD1614M-1	X	-	-	-	-	-	-	-
MD1210F-1	MD1210M-1	X	-	-	-	-	-	-	-
MD1210F-2	MD1210M-2	X	-	-	-	-	-	-	-
MD8F-1	MD8M-1	-	X	13475	13477	13454	13461	21	Red
MD8F-2	MD8M-2	-	X	13475	13477	13454	13461	21	Red
MD6F-1	MD6M-1	-	X	13475	13477	13454	13461	24	Blue
MD6F-2	MD6M-2	-	X	13475	13477	13454	13461	24	Blue
MD4F-2	MD4M-2	-	X	13472	13476	13454	13461	29	Grey
MD2F-2	MD2M-2	-	X	13474	13477	13454	3461	33	Brown
MD2F-3	MD2M-3	-	X	13474	13477	13454	13461	33	Brown
MD1F-2	MD1M-2	-	-	13474	13477	13455	13462	37	Green
MD1F-3	MD1M-3	-	-	13474	13477	13455	13462	37	Green
MD10F-3	MD10M-3	-	-	13475	13477	13455	13462	42	Pink
MD20F-3	MD20M-3	-	-	13474	13477	13455	13462	45	Black
MD30F-3	MD30M-3	-	-	13474	13477	13455	13462	50	Orange
MD40F-3	MD40M-3	-	-	13475	13477	13456	13463	54	Purple

Specifications:
Wire Range: No. 16 to 4/0 AWG
Rating: 600V, 90°C

Tooling: pp. 110-139

Die Selector Chart: pp. 140-147

Motor Pigtail Connectors

Motor Pigtail Connector – One Line to Two Load (3 Wire)

- KON-TOUR® louvered contact bands
- Color-coded to match installing dies

Material: High-Conductivity Wrought Copper

Finish: Electro-Tin Plate

Contact Material: Beryllium Copper

C o m p r e s s i o n

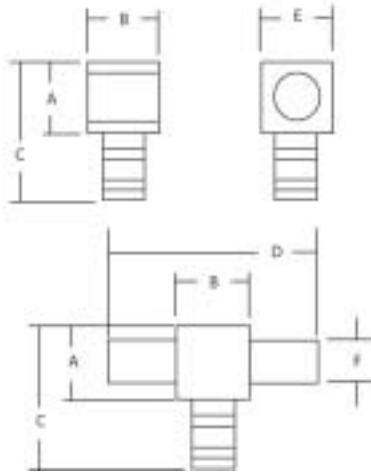

CAT. NO. Certified to 600V		Wire Size	Body Size	Color Code	Boot insulation	Dimensions in. (mm)						Strip Length (in.)
Female Disconnect	Male Disconnect					A	B	C	D	E	F	
MD1614F-0	M2D1614M-0	16-14 AWG	0	Blue	MDBOOT-1	0.25 (6.4)	0.25 (6.4)	0.63 (16.0)	0.52 (13.2)	0.25 (6.4)	0.13 (3.3)	3/8
MD1614F-1	M2D1614M-1	16-14 AWG	1	Blue	MDBOOT-1	0.38 (9.7)	0.38 (9.7)	0.78 (19.8)	0.75 (19.1)	0.38 (9.7)	0.25 (6.4)	3/8
MD1210F-1	M2D1210M-1	12-10 AWG	1	Yellow	MDBOOT-1	0.38 (9.7)	0.35 (8.9)	0.78 (19.8)	0.75 (19.1)	0.38 (9.7)	0.25 (6.4)	3/8
MD1210F-2	M2D1210M-2	12-10 AWG	2	Yellow	MDBOOT-2	0.50 (12.7)	0.50 (12.7)	0.90 (22.9)	1.00 (25.4)	0.50 (12.7)	0.37 (9.4)	3/8
MD8F-1	M2D8M-1	8 AWG	1	Red	MDBOOT-1	0.38 (9.7)	0.38 (9.7)	0.82 (20.8)	0.75 (19.1)	0.38 (9.7)	0.25 (6.4)	7/16
MD8F-2	M2D8M-2	8 AWG	2	Red	MDBOOT-2	0.50 (12.7)	0.50 (12.7)	0.95 (24.1)	1.00 (25.4)	0.50 (12.7)	0.37 (9.4)	7/16
MD6F-1	M2D6M-1	6 AWG	1	Blue	MDBOOT-1	0.38 (9.7)	0.38 (9.7)	0.88 (22.4)	0.75 (19.1)	0.38 (9.7)	0.25 (6.4)	1/2
MD6F-2	M2D6M-2	6 AWG	2	Blue	MDBOOT-2	0.50 (12.7)	0.50 (12.7)	1.02 (25.9)	1.00 (25.4)	0.50 (12.7)	0.37 (9.4)	1/2
MD4F-2	M2D4M-2	4 AWG	2	Grey	MDBOOT-2	0.50 (12.7)	0.50 (12.7)	1.03 (26.2)	1.00 (25.4)	0.50 (12.7)	0.37 (9.4)	1/2
MD2F-2	M2D2M-2	2 AWG	2	Brown	MDBOOT-2	0.50 (12.7)	0.50 (12.7)	1.09 (27.7)	1.00 (25.4)	0.50 (12.7)	0.37 (9.4)	17/32
MD2F-3	M2D2M-3	2 AWG	3	Brown	MDBOOT-3	0.88 (22.4)	0.88 (22.4)	1.46 (37.1)	1.75 (44.5)	0.88 (22.4)	0.50 (12.7)	17/32
MD1F-2	M2D1M-2	1 AWG	2	Green	MDBOOT-2	0.50 (12.7)	0.50 (12.7)	1.23 (31.2)	1.00 (25.4)	0.50 (12.7)	0.37 (9.4)	9/16
MD1F-3	M2D1M-3	1 AWG	3	Green	MDBOOT-3	0.88 (22.4)	0.88 (22.4)	1.56 (39.6)	1.75 (44.5)	0.88 (22.4)	0.50 (12.7)	9/16
MD10F-3	M2D10M-3	1/0 AWG	3	Pink	MDBOOT-3	0.88 (22.4)	0.88 (22.4)	1.56 (39.6)	1.75 (44.5)	0.88 (22.4)	0.50 (12.7)	9/16
MD20F-3	M2D20M-3	2/0 AWG	3	Black	MDBOOT-3	0.88 (22.4)	0.88 (22.4)	1.59 (40.4)	1.75 (44.5)	0.88 (22.4)	0.50 (12.7)	5/8
MD30F-3	M2D30M-3	3/0 AWG	3	Orange	MDBOOT-3	0.88 (22.4)	0.88 (22.4)	1.71 (43.4)	1.75 (44.5)	0.88 (22.4)	0.50 (12.7)	11/16
MD40F-3	M2D40M-3	4/0 AWG	3	Purple	MDBOOT-3	0.88 (22.4)	0.88 (22.4)	1.81 (46.0)	1.75 (44.5)	0.88 (22.4)	0.50 (12.7)	3/4

Operating Range: 600V max., 1000V max. in signs and fixtures.

Listing: UL Listed and CSA Certified for 12/8 AWG solid copper conductors and stranded copper conductors in the sizes shown.

Selection: Always use the same body size when selecting male and female disconnects.

For example: to connect a 2 AWG male to an 8 AWG female, select catalogue number M2DM-2 and MD8F-2. Both have body size 2.

Insulation: Use insulating boots matching the disconnect body size as indicated in the chart. To protect the connection from moisture and dirt use sealing compound

Catalogue Number MDBOOT-SEAL.

Tooling: pp. 110-139

Die Selector Chart: pp. 140-147

Motor Pigtail Connectors

Motor Pigtail Connector – One Line to Two Load (3 Wire) (Continued)

- KON-TOUR® louvered contact bands
- Color-coded to match installing dies

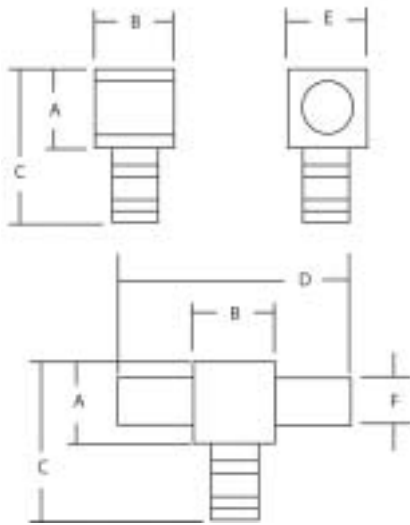

C o m p r e s s i o n



CAT. NO. Certified to 600V		WT112M WT111M WT2000 ERG2002	TBM25S TBM20S	Installing Tools					
				TBM6, TBM6S, TBM6ORS		TBM5 TBM5S	TBM8 TBM8S	Hydraulic Tools and TBM50S Hand Tool	
				Upper Die	Lower Die	Die Set	Die Set	Die Code	Color
Female Disconnect	Male Disconnect								
MD1614F-0	M2D1614M-0	X	-	-	-	-	-	-	-
MD1614F-1	M2D1614M-1	X	-	-	-	-	-	-	-
MD1210F-1	M2D1210M-1	X	-	-	-	-	-	-	-
MD1210F-2	M2D1210M-2	X	-	-	-	-	-	-	-
MD8F-1	M2D8M-1	-	X	13475	13477	13454	13461	21	Red
MD8F-2	M2D8M-2	-	X	13475	13477	13454	13461	21	Red
MD6F-1	M2D6M-1	-	X	13475	13477	13454	13461	24	Blue
MD6F-2	M2D6M-2	-	X	13475	13477	13454	13461	24	Blue
MD4F-2	M2D4M-2	-	X	13472	13476	13454	13461	29	Grey
MD2F-2	M2D2M-2	-	X	13474	13477	13454	3461	33	Brown
MD2F-3	M2D2M-3	-	X	13474	13477	13454	13461	33	Brown
MD1F-2	M2D1M-2	-	-	13474	13477	13455	13462	37	Green
MD1F-3	M2D1M-3	-	-	13474	13477	13455	13462	37	Green
MD10F-3	M2D10M-3	-	-	13475	13477	13455	13462	42	Pink
MD20F-3	M2D20M-3	-	-	13474	13477	13455	13462	45	Black
MD30F-3	M2D30M-3	-	-	13474	13477	13455	13462	50	Orange
MD40F-3	M2D40M-3	-	-	13475	13477	13456	13463	54	Purple

Tooling: pp. 110-139

Die Selector Chart: pp. 140-147

Motor Pigtail Connectors

5 KV Motor Pigtail Connector Supplied with Boot, Pin, Silicon Gel (Two Female Connectors Required)

C o m p r e s s i o n

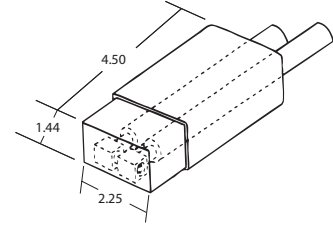
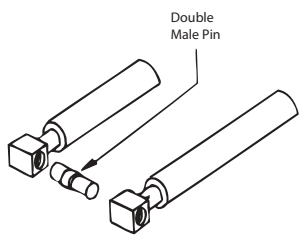

CAT. NO.	Wire Range AWG	Female Disconnect Cat. No.	Color Code	Dimensions (in.)			Body Size
				L	W	H	
5KVBOOT-2L <small>(connection pin for two female connectors included)</small>	#8	MD8F-2	Red	4.50 (114.3)	2.25 (57.2)	1.44 (36.6)	2
	#6	MD6F-2	Blue	4.50 (114.3)	2.25 (57.2)	1.44 (36.6)	2
	#4	MD4F-2	Grey	4.50 (114.3)	2.25 (57.2)	1.44 (36.6)	2
	#2	MD2F-2	Brown	4.50 (114.3)	2.25 (57.2)	1.44 (36.6)	2
	#1	MD1F-2	Green	4.50 (114.3)	2.25 (57.2)	1.44 (36.6)	2
5KVBOOT-3L <small>(connection pin for two female connectors included)</small>	#2	MD2F-3	Brown	4.50 (114.3)	2.25 (57.2)	1.44 (36.6)	3
	#1	MD1F-3	Green	4.50 (114.3)	2.25 (57.2)	1.44 (36.6)	3
	1/0	MD10F-3	Pink	4.50 (114.3)	2.25 (57.2)	1.44 (36.6)	3
	2/0	MD20F-3	Black	4.50 (114.3)	2.25 (57.2)	1.44 (36.6)	3
	3/0	MD30F-3	Orange	4.50 (114.3)	2.25 (57.2)	1.44 (36.6)	3
	4/0	MD40F-3	Purple	4.50 (114.3)	2.25 (57.2)	1.44 (36.6)	3

* Male pin supplied will fit all ranges and combinations of wire sizes per body size.

Sealing of motor-disconnect boots

Sealant

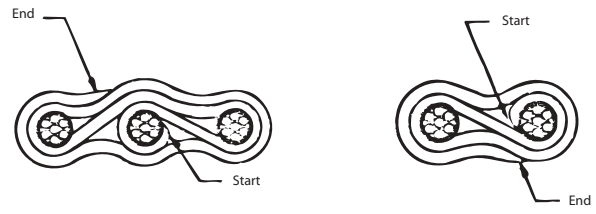

Sealant should be used with T&B MOTOR DISCONNECT Boots: MDBOOT-0, MDBOOT-1, MDBOOT-2 and MDBOOT-3.

The cable should be clean and free of grease and other foreign substances.

Apply two layers around each cable at the same distance from the connector.

Slide the assembly into boot, apply Ty-Rap® cable ties and work sealant around wires at end of boot to eliminate voids.

Specifications

- Description: Polybutene Compound
- Application Temperature: 4°C to 38°C (40°F to 100°F)
- Service Temperature: -40°C to 82°C (-40°F to 180°F)
- Dimensions: Width 1", Thickness 1/8", Length (std. roll) 10', wrapped on release liner
- Environmental Resistance: Resists normal aging process
- Chemical Resistance: Resists acids, bases and alcohols
- Dielectric Strength: 200 V/mil minimum
- Volume Resistivity: 1013 ohms/cm
- Flame Retardancy: Passed VO Vertical Flame Test

CAT. NO.	Description
MDBOOT-SEAL	Sealant

For water-tight applications, contact technical services.

Motor Pigtail Connectors

Silicone Lubricant for High Voltage Electrical Work



CAT. NO.	Size	Std. Pkg.
2015	5 grams	100 tubes
SL5	5 oz./142 grams	12 tubes

C
o
m
p
r
e
s
s
i
o
n