

## Base strip - MCV 1,5/11-GF-3,81 - 1830680

Please be informed that the data shown in this PDF Document is generated from our Online Catalog. Please find the complete data in the user's documentation. Our General Terms of Use for Downloads are valid (<http://phoenixcontact.com/download>)

Header, Nominal current: 8 A, Rated voltage (III/2): 160 V, Number of positions: 11, Pitch: 3.81 mm, Color: green, Contact surface: Tin, Mounting: Wave soldering



The figure shows a 10-position version of the product

### Product Features

- Versions with engagement noses for locking plugs with self-locking flanges
- Low-profile pin strips with compact pitches



### Key Commercial Data

|                                      |                                                                                                         |
|--------------------------------------|---------------------------------------------------------------------------------------------------------|
| Packing unit                         | 1 pc                                                                                                    |
| GTIN                                 | <br>4 017918 051334 |
| Weight per Piece (excluding packing) | 4.18 g                                                                                                  |
| Custom tariff number                 | 85366990                                                                                                |
| Country of origin                    | Germany                                                                                                 |

### Technical data

#### Dimensions

|                          |              |
|--------------------------|--------------|
| Length                   | 7.25 mm      |
| Pitch                    | 3.81 mm      |
| Dimension a              | 38.1 mm      |
| Constructional height    | 10 mm        |
| Length of the solder pin | 3.4 mm       |
| Pin dimensions           | 0,8 x 0,8 mm |
| Hole diameter            | 1.2 mm       |

## Base strip - MCV 1,5/11-GF-3,81 - 1830680

### Technical data

#### General

|                                        |                |
|----------------------------------------|----------------|
| Range of articles                      | MCV 1,5/...-GF |
| Insulating material group              | IIIa           |
| Rated surge voltage (III/3)            | 2.5 kV         |
| Rated surge voltage (III/2)            | 2.5 kV         |
| Rated surge voltage (II/2)             | 2.5 kV         |
| Rated voltage (III/3)                  | 160 V          |
| Rated voltage (III/2)                  | 160 V          |
| Rated voltage (II/2)                   | 250 V          |
| Connection in acc. with standard       | EN-VDE         |
| Nominal current I <sub>N</sub>         | 8 A            |
| Maximum load current                   | 8 A            |
| Insulating material                    | PBT            |
| Flammability rating according to UL 94 | V0             |
| Color                                  | green          |
| Number of positions                    | 11             |

#### Standards and Regulations

|                                        |        |
|----------------------------------------|--------|
| Connection in acc. with standard       | EN-VDE |
|                                        | CSA    |
| Flammability rating according to UL 94 | V0     |

### Classifications

#### eCl@ss

|            |          |
|------------|----------|
| eCl@ss 4.0 | 272607xx |
| eCl@ss 4.1 | 27260701 |
| eCl@ss 5.0 | 27260701 |
| eCl@ss 5.1 | 27260701 |
| eCl@ss 6.0 | 27260704 |
| eCl@ss 7.0 | 27440402 |
| eCl@ss 8.0 | 27440402 |
| eCl@ss 9.0 | 27440402 |

#### ETIM

|          |          |
|----------|----------|
| ETIM 3.0 | EC001121 |
| ETIM 4.0 | EC002637 |
| ETIM 5.0 | EC002637 |

# Base strip - MCV 1,5/11-GF-3,81 - 1830680

## Classifications

### UNSPSC

|               |          |
|---------------|----------|
| UNSPSC 6.01   | 30211810 |
| UNSPSC 7.0901 | 39121409 |
| UNSPSC 11     | 39121409 |
| UNSPSC 12.01  | 39121409 |
| UNSPSC 13.2   | 39121409 |

## Approvals

### Approvals

#### Approvals

CSA / VDE Gutachten mit Fertigungsüberwachung / IEC60335 CB Scheme / CCA / EAC / cULus Recognized / EAC

#### Ex Approvals

#### Approvals submitted

## Approval details

|                                                                                         |       |       |
|-----------------------------------------------------------------------------------------|-------|-------|
| CSA  |       |       |
|                                                                                         | B     | D     |
| Nominal current I <sub>N</sub>                                                          | 8 A   | 8 A   |
| Nominal voltage U <sub>N</sub>                                                          | 300 V | 300 V |

|                                                                                                                             |       |
|-----------------------------------------------------------------------------------------------------------------------------|-------|
| VDE Gutachten mit Fertigungsüberwachung  |       |
| Nominal current I <sub>N</sub>                                                                                              | 8 A   |
| Nominal voltage U <sub>N</sub>                                                                                              | 160 V |

# Base strip - MCV 1,5/11-GF-3,81 - 1830680

## Approvals

|                                |       |
|--------------------------------|-------|
| IECEE CB Scheme                |       |
| Nominal current I <sub>N</sub> | 8 A   |
| Nominal voltage U <sub>N</sub> | 160 V |

|                                |       |
|--------------------------------|-------|
| CCA                            |       |
| Nominal current I <sub>N</sub> | 8 A   |
| Nominal voltage U <sub>N</sub> | 160 V |

|     |  |
|-----|--|
| EAC |  |
|-----|--|

|                                |       |       |
|--------------------------------|-------|-------|
| cULus Recognized               |       |       |
|                                | B     | D     |
| Nominal current I <sub>N</sub> | 8 A   | 8 A   |
| Nominal voltage U <sub>N</sub> | 300 V | 300 V |

|     |  |
|-----|--|
| EAC |  |
|-----|--|

## Drawings

Diagram

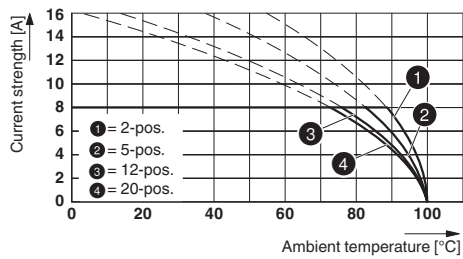

Drilling diagram

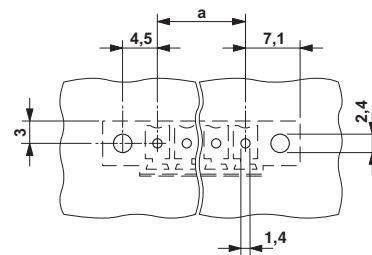

Type: MC 1,5/...-STF-3,81 with MCV 1,5/...-GF-3,81

## Base strip - MCV 1,5/11-GF-3,81 - 1830680

Dimensional drawing

