

DO NOT SCALE DRAWING

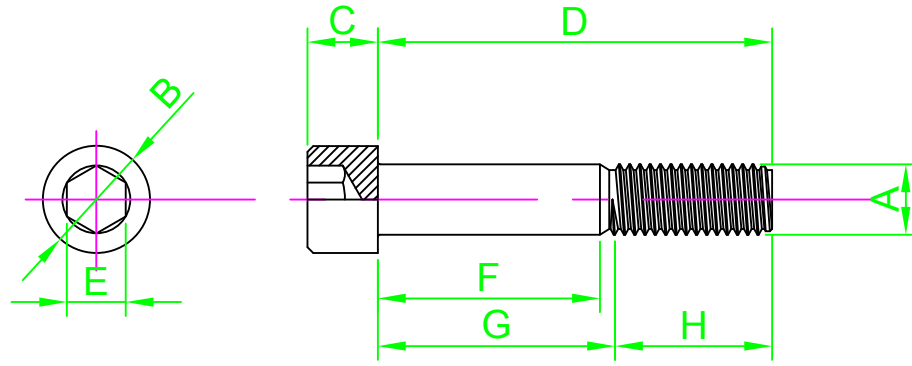
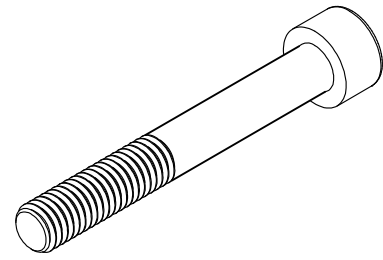

REVISION

A INITIAL DRAWING 25.01.16

Part Number	ØA	B Max	C Max	D Length	E Nom	F Min	G Max	H Ref			
M2.5 5 SO12CS S100	M2.5-0.45	4.68	2.50	5.0	2.0	N/A	1.35	N/A			
M2.5 6 SO12CS S100				6.0							
M2.5 10 SO12CS S100				10.0							
M2.5 12 SO12CS S100	M3-0.5	5.68	3.0	12.0	2.5	N/A	1.50	N/A			
M3 6 SO12CS S100				6.0							
M3 8 SO12CS S100				8.0							
M3 10 SO12CS S100				10.0							
M3 12 SO12CS S100				12.0							
M3 16 SO12CS S100				16.0							
M3 20 SO12CS S100				20.0							
M3 25 SO12CS S100	25.0	4.5	7.0	18.0							
M3 30 SO12CS S100	30.0	9.5	12.0								
M4 6 SO12CS S100	M4-0.7	7.22	4.0	6.0	3.0	N/A	2.10	N/A			
M4 8 SO12CS S100				8.0							
M4 10 SO12CS S100				10.0							
M4 12 SO12CS S100				12.0							
M4 15 SO12CS S100				15.0							
M4 16 SO12CS S100				16.0							
M4 20 SO12CS S100				20.0							
M4 25 SO12CS S100				25.0							
M4 30 SO12CS S100				30.0					6.50	10.0	20.0
M4 35 SO12CS S100				35.0					11.50	15.0	
M4 40 SO12CS S100	40.0	16.50	20.0								
M4 50 SO12CS S100	50.0	26.50	30.0								
M5 8 SO12CS S100	M5-0.8	8.72	5.0	8.0	4.0	N/A	2.10	N/A			
M5 10 SO12CS S100				10.0							
M5 12 SO12CS S100				12.0							
M5 16 SO12CS S100				16.0							
M5 20 SO12CS S100				20.0							
M5 25 SO12CS S100				25.0							
M5 30 SO12CS S100				30.0					4.0	8.0	22.0
M5 35 SO12CS S100				35.0					9.0	13.0	
M5 40 SO12CS S100				40.0					14.0	18.0	
M5 50 SO12CS S100				50.0					24.0	28.0	
M5 60 SO12CS S100	60.0	34.0	38.0								

Part Number	ØA	B Max	C Max	D Length	E Nom	F Min	G Max	H Ref			
M6 10 SO12CS S100	M6-1.0	10.22	6.0	10.0	5.0	N/A	3.0	N/A			
M6 12 SO12CS S100				12.0							
M6 16 SO12CS S100				16.0							
M6 20 SO12CS S100				20.0							
M6 25 SO12CS S100				25.0							
M6 30 SO12CS S100				30.0							
M6 35 SO12CS S100				35.0					6.0	11.0	24.0
M6 40 SO12CS S100				40.0					11.0	16.0	
M6 50 SO12CS S100				50.0					21.0	26.0	
M6 60 SO12CS S100				60.0					31.0	36.0	
M6 65 SO12CS S100				65.0					36.0	41.0	
M6 70 SO12CS S100				70.0					41.0	46.0	
M6 75 SO12CS S100				75.0					46.0	51.0	
M6 80 SO12CS S100				80.0					51.0	56.0	
M6 90 SO12CS S100				90.0					61.0	66.0	
M6 100 SO12CS S100	100.0	71.0	76.0								
M8 10 SO12CS S100	M8-1.25	13.27	8.0	10.0	6.0	N/A	3.75	N/A			
M8 16 SO12CS S100				16.0							
M8 20 SO12CS S100				20.0							
M8 25 SO12CS S100				25.0							
M8 30 SO12CS S100				30.0							
M8 35 SO12CS S100				35.0					5.75	12.0	28.0
M8 40 SO12CS S100				40.0					10.75	17.0	
M8 45 SO12CS S100				45.0					15.75	22.0	
M8 50 SO12CS S100				50.0					20.75	27.0	
M8 60 SO12CS S100				60.0					25.75	32.0	
M8 90 SO12CS S100	90.0	55.75	62.0								
M10 25 SO12CS S100	M10-1.5	16.27	10.0	25.0	8.0	N/A	4.5	32.0			
M10 30 SO12CS S100				30.0							
M10 40 SO12CS S100				40.0							
M10 60 SO12CS S100				60.0					20.50	28.0	
M12 25 SO12CS S100	M12-1.75	18.27	12.0	25.0	10.0	N/A	5.25	N/A			
M12 40 SO12CS S100				40.0							
M12 45 SO12CS S100				45.0							

NOTES:



UNLESS OTHERWISE SPECIFIED:
DIMENSIONS ARE IN MM (MILLIMETERS).
SURFACE FINISH:
TOLERANCES: DIN 912

MATERIAL:
Steel

TITLE:
Hex Socket Head Cap Screw DIN 912

NAME	DATE
DRAWN Darryl Wilson	25.01.16
CHK'D	
APPVD	

HEAT TREATMENT:
Grade 12.9

DESIGN RIGHT. TR FASTENINGS LTD, 2003
UNDER NO CIRCUMSTANCES MUST THIS
DRAWING BE COPIED OR DISCLOSED
WITHOUT FIRST OBTAINING WRITTEN
AUTHORITY.

CUSTOMER PART NUMBER:
N/A

FINISH:
Self Finish

DRAWING NUMBER:
TR32SO12CSS100

A4

PROJECTION

