

DO NOT SCALE DRAWING

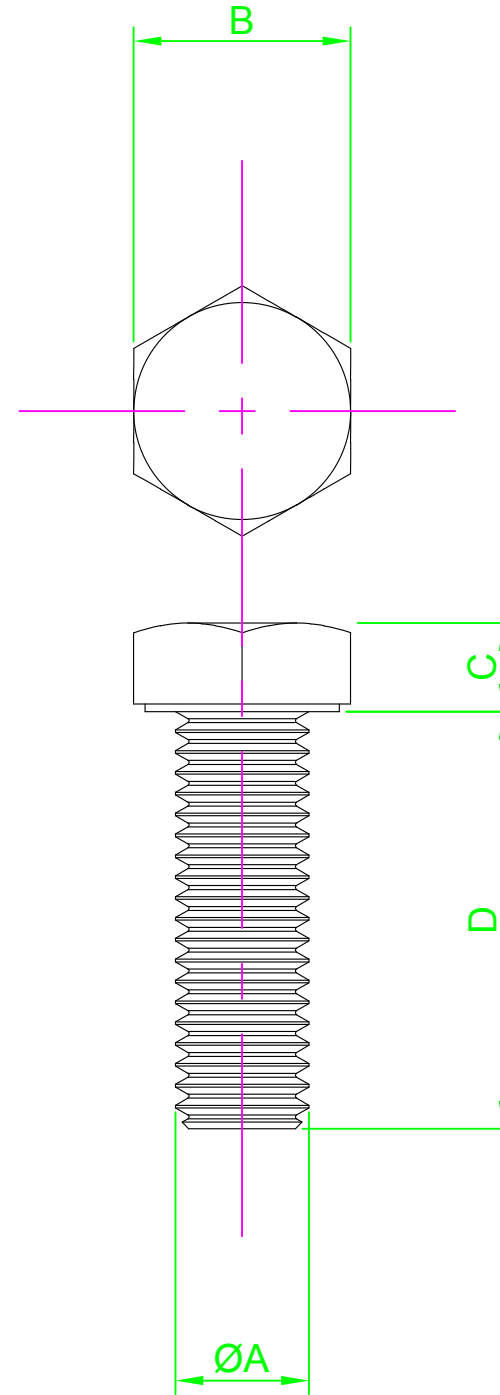
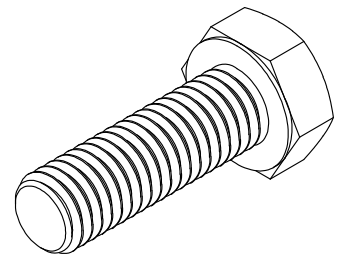

REVISION

A INITIAL DRAWING 26.01.16 DW

Part Number	ØA	B Nom	C Nom	D Length
M8 12 HH88SC Z50	M8-1.25	13	5.3	12.0
M8 16 HH88SC Z50				16.0
M8 20 HH88SC Z50				20.0
M8 25 HH88SC Z50				25.0
M8 30 HH88SC Z50				30.0
M8 35 HH88SC Z50				35.0
M8 40 HH88SC Z50				40.0
M8 50 HH88SC Z50				50.0
M10 16 HH88SC Z50	M10-1.50	17	6.4	16.0
M10 20 HH88SC Z50				20.0
M10 25 HH88SC Z50				25.0
M10 30 HH88SC Z50				30.0
M10 35 HH88SC Z50				35.0
M10 40 HH88SC Z50				40.0
M10 50 HH88SC Z50				50.0
M10 60 HH88SC Z50				60.0
M10 70 HH88SC Z50				70.0
M12 30 HH88SC Z50	M12-1.75	19	7.5	30.0
M12 40 HH88SC Z50				40.0
M12 50 HH88SC Z50				50.0

NOTES:



UNLESS OTHERWISE SPECIFIED:
DIMENSIONS ARE IN MM (MILLIMETERS).
SURFACE FINISH:
TOLERANCES: DIN 933

MATERIAL:
Steel

TITLE:
Hex Head Set Screw DIN 933

	NAME	DATE
DRAWN	Darryl Wilson	26.01.16
CHK'D		
APPVD		

HEAT TREATMENT:
Grade 8.8

DESIGN RIGHT. TR FASTENINGS LTD, 2003
UNDER NO CIRCUMSTANCES MUST THIS
DRAWING BE COPIED OR DISCLOSED
WITHOUT FIRST OBTAINING WRITTEN
AUTHORITY.

CUSTOMER PART NUMBER:
N/A

FINISH:
TC1 - Commercial Zinc/Clear Cr3

DRAWING NUMBER:
TR32HH88SCZ50

A4

