

DASH NO.	M CODE	MADE FROM
----------	--------	-----------

GSD

M55339/15-00491

REVISIONS	
ISSUE	CHANGES
6	CN 33888 C REDRAWN KH 06/09/92
7	CN 35618 D KH 01/09/95

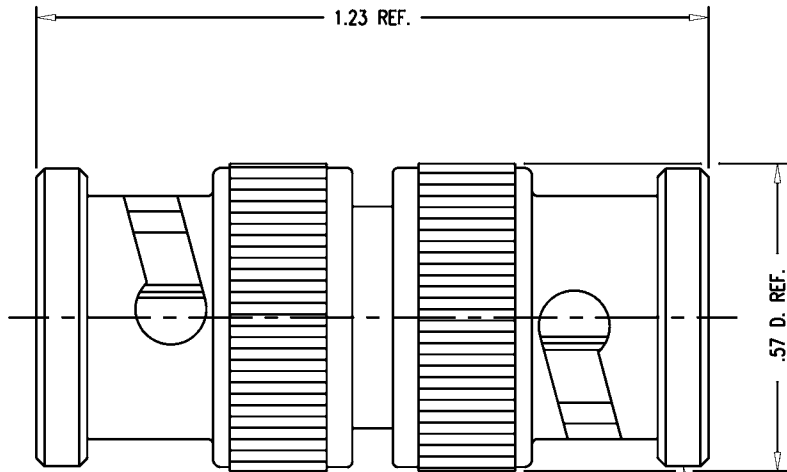

STAMP: 91836 M55339/15-00491
759-5 XXXX

DATE CODE

NOTES:

- INTERFACE PER MIL-STD-348, FIG. 301-1.
- MATERIALS:
 - GASKETS: SILICONE RUBBER, ZZ-R-765
 - INSULATOR: TEFLON, ASTM-D-4894
 - OUTER CONTACTS } BER. COPPER, ASTM-B-196
 - SPRING WASHERS }
 - ALL OTHER METAL PARTS: BRASS, ASTM-B16
- FINISHES:
 - CENTER CONTACT: GOLD PLATE PER MIL-G-45204
 - ALL OTHER METAL PARTS: SILVER PLATE, QQ-S-365.
- ELECTRICAL CHARACTERISTICS:
 - NOMINAL IMPEDANCE: 50 OHMS
 - FREQUENCY RANGE: DC TO 4 GHz.
 - WORKING VOLTAGE: 500 VRMS

KAM2043

SCALE	4:1
APPROX SURFACE AREA	759-5
USED ON	
REF:	
ADAPTER, M-M, BNC-BNC	
DRAWN KH	DATE 06/09/92
DESIGN CT	DATE 06/12/92
APPR. JT	DATE 06/20/92

GSD

KINGS
ELECTRONICS CO., INC.
TUCKAHOE, NEW YORK 10707

M55339/15-00491