

DO NOT SCALE DRAWING

REVISION

A INITIAL DRAWING 24.9.15

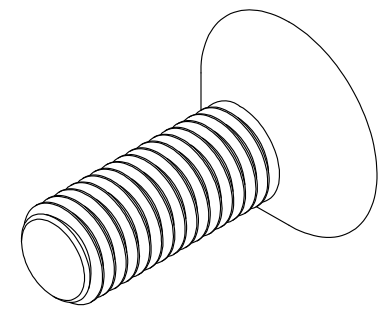
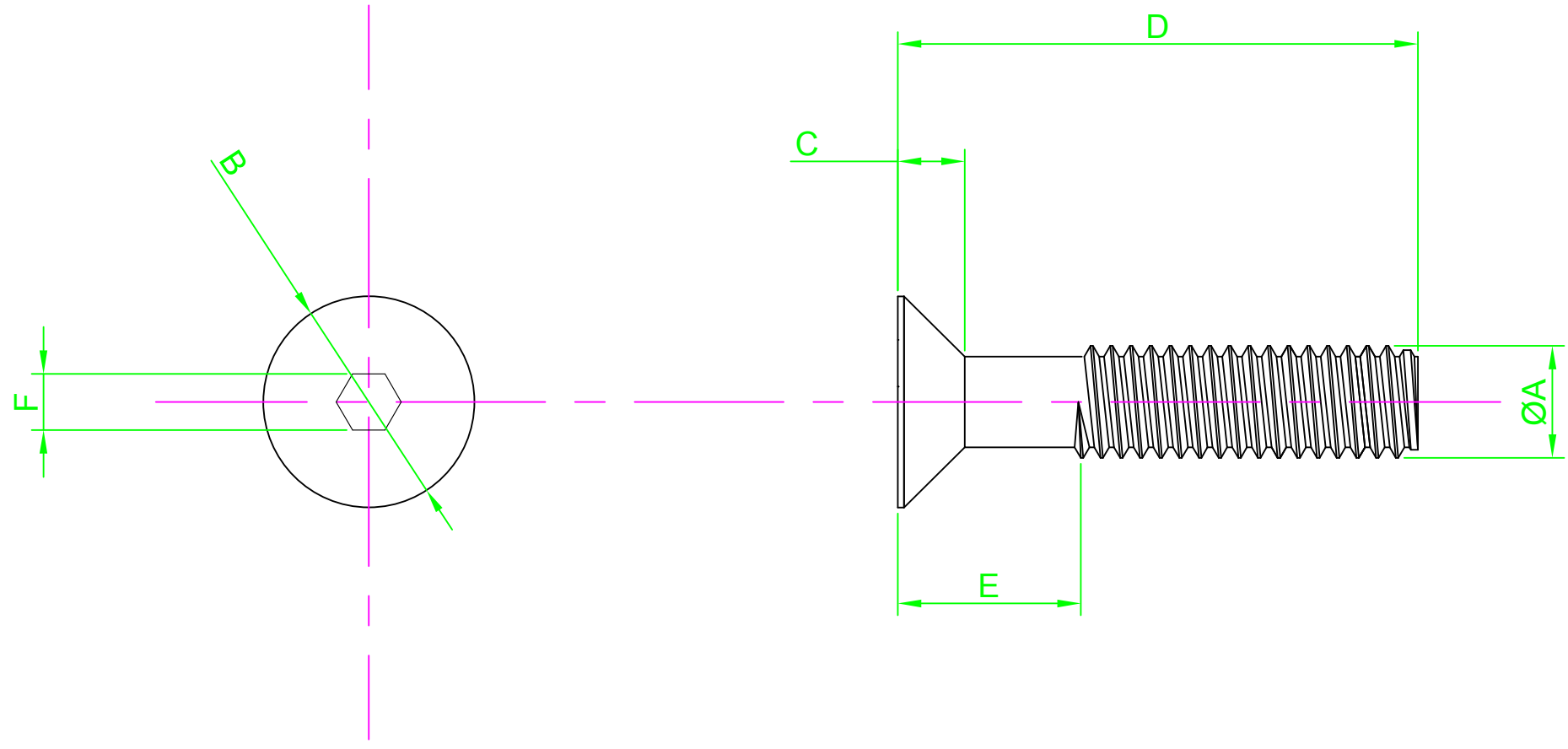

Part Number	ØA	B Nom	C Max	D Length	E Max	F Nom
M3 6 KHA2MC S50	M3-0.5	6	1.7	6.0	3.2	2
M3 10 KHA2MC S50				10.0		
M3 12 KHA2MC S50				12.0		
M4 10 KHA2MC S50	M4-0.7	8	2.3	10.0	4.4	2.5
M4 12 KHA2MC S50				12.0		
M4 16 KHA2MC S50				16.0		
M4 20 KHA2MC S50				20.0		
M5 10 KHA2MC S50	M5-0.8	10	2.8	10.0	5.2	3
M5 12 KHA2MC S50				12.0		
M5 16 KHA2MC S50				16.0		
M5 20 KHA2MC S50				20.0		
M5 30 KHA2MC S50				30.0		
M6 12 KHA2MC S50	M6-1.0	12	3.3	12.0	6.3	4
M6 16 KHA2MC S50				16.0		
M6 20 KHA2MC S50				20.0		
M6 30 KHA2MC S50				30.0		

NOTES:



UNLESS OTHERWISE SPECIFIED:
DIMENSIONS ARE IN MM (MILLIMETERS).
SURFACE FINISH:
TOLERANCES: DIN 7991

MATERIAL:
Stainless Steel A2

TITLE:
Hex Socket Csk Head Cap Screw DIN 7991

	NAME	DATE
DRAWN	Darryl Wilson	24.09.15
CHK'D		
APPVD		

HEAT TREATMENT:
N/A

DESIGN RIGHT. TR FASTENINGS LTD, 2003
UNDER NO CIRCUMSTANCES MUST THIS
DRAWING BE COPIED OR DISCLOSED
WITHOUT FIRST OBTAINING WRITTEN
AUTHORITY.

CUSTOMER PART NUMBER:
N/A

FINISH:
Self Finish

DRAWING NUMBER:
TR32KHA2MC-S50

A4

