

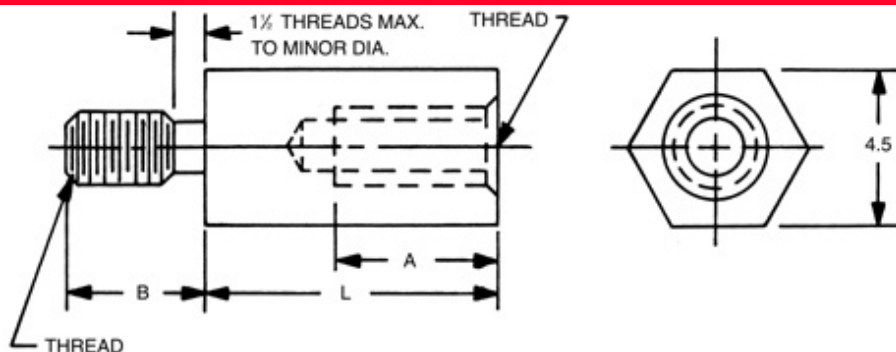

4.5mm HEX MALE-FEMALE STANDOFFS

RAF



RAF

Order Code:

Navigation buttons: <<< >>> Contents

12-Zinc

Finishes:

Quote [\[How to create part numbers\]](#) [\[Material Specifications\]](#)

SELECT	PART NO.	LENGTH
<input type="checkbox"/>	M2100	5
<input type="checkbox"/>	M2101	6
<input type="checkbox"/>	M2102	7
<input type="checkbox"/>	M2103	8
<input type="checkbox"/>	M2104	9
<input type="checkbox"/>	M2105	10
<input type="checkbox"/>	M2106	11
<input type="checkbox"/>	M2107	12
<input type="checkbox"/>	M2108	13
<input type="checkbox"/>	M2109	14
<input type="checkbox"/>	M2110	15
<input type="checkbox"/>	M2111	16
<input type="checkbox"/>	M2112	17
<input type="checkbox"/>	M2113	18
<input type="checkbox"/>	M2114	19

SELECT	PART NO.	LENGTH
<input type="checkbox"/>	M2115	20
<input type="checkbox"/>	M2116	21
<input type="checkbox"/>	M2117	22
<input type="checkbox"/>	M2118	23
<input type="checkbox"/>	M2119	24
<input type="checkbox"/>	M2120	25
<input type="checkbox"/>	M2121	28
<input type="checkbox"/>	M2122	31
<input type="checkbox"/>	M2123	34
<input type="checkbox"/>	M2124	37
<input type="checkbox"/>	M2125	40
<input type="checkbox"/>	M2126	43
<input type="checkbox"/>	M2127	46
<input type="checkbox"/>	M2128	49
<input type="checkbox"/>	M2129	52

THREAD LENGTH CODE				
Select	CODE	THREAD	A	B
<input type="checkbox"/>	2545	M2.5x0.45	4.8	3.97
<input type="checkbox"/>	3005	M3x0.5	6.4	4.76

MINIMUM THREAD DEPTH "A"					
THREAD	Body Length "L"				
	5	6	7	8	9
M2.5x0.45	1.9	2.9	3.9	-	-
M3x0.5	1.8	2.8	3.8	4.8	5.8

Select	CODE	MATERIAL	RoHS
<input type="checkbox"/>	AL	ALUMINUM	YES
<input type="checkbox"/>	B	BRASS	YES
<input type="checkbox"/>	SS	STAINLESS STEEL	YES
<input type="checkbox"/>	S	STEEL	YES
<input type="checkbox"/>	N	NYLON	YES

Ordering Code

mxxxx	xxxx	xx	xx
	Thread		Finish
Length		Material	

For non standard items please click [here](#)



© 1999 RAF Electronic Hardware All Rights Reserved

Seymour CT 06483 203 888-2133 Fax: 203 888-9860 www.rafhdwe.com

