

HOME

PRODUCTS

ONLINE CATALOG

REQUEST QUOTE

ORDER ONLINE

CHECK STOCK

REQUEST PRINT CATALOG

REQUEST SAMPLES

ENGINEERING DATA

DISTRIBUTORS

CAPABILITIES BROCHURE

CALL NOW:
203 888-2133

PART NO. SEARCH - ENTER 3-4 CHARS:

ENTER

Catalogs: [ASE](#) | [Metric](#) | [Handles & Ferrules](#)

4.5mm Hex Female Standoffs

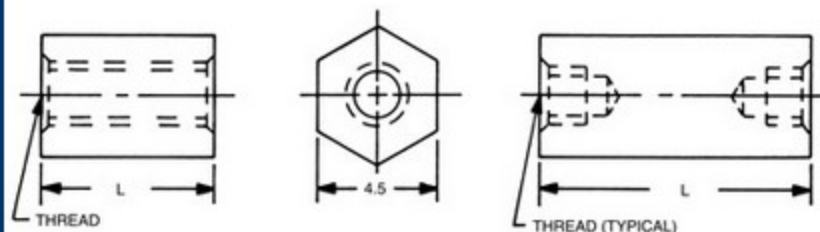

[Home](#) [Previous](#) [Next](#)
[Related ASE](#)

Ordering Code			
M	XXXX	XXXX	XX
Length	Thread	Material	Finish

PART: M1260-2545-SS

Enter desired quantities:

Qty 1

Qty 2

Qty 3

Request Quote

Check Stock

[Download drawing](#)

Select	Part No.	Length	Select	Part No.	Length
<input type="radio"/>	M 1250	3	<input type="radio"/>	M 1266	19
<input type="radio"/>	M 1251	4	<input type="radio"/>	M 1267	20
<input type="radio"/>	M 1252	5	<input type="radio"/>	M 1268	21
<input type="radio"/>	M 1253	6	<input type="radio"/>	M 1269	22
<input type="radio"/>	M 1254	7	<input type="radio"/>	M 1270	23
<input type="radio"/>	M 1255	8	<input type="radio"/>	M 1271	24
<input type="radio"/>	M 1256	9	<input type="radio"/>	M 1272	25
<input type="radio"/>	M 1257	10	<input type="radio"/>	M 1273	28
<input type="radio"/>	M 1258	11	<input type="radio"/>	M 1274	31
<input type="radio"/>	M 1259	12	<input type="radio"/>	M 1275	34
<input type="radio"/>	M 1260	13	<input type="radio"/>	M 1276	37
<input type="radio"/>	M 1261	14	<input type="radio"/>	M 1277	40
<input type="radio"/>	M 1262	15	<input type="radio"/>	M 1278	43
<input type="radio"/>	M 1263	16	<input type="radio"/>	M 1279	46
<input type="radio"/>	M 1264	17	<input type="radio"/>	M 1280	49
<input type="radio"/>	M 1265	18	<input type="radio"/>	M 1281	52

Select	Code	Thread
<input type="radio"/>	2545	M2.5x0.45
<input type="radio"/>	3005	M3x0.5

[Thread depth information](#)

Select	Code	Material	RoHS
<input type="radio"/>	AL	Aluminum	YES
<input type="radio"/>	B	Brass	YES
<input type="radio"/>	SS	Stainless Steel	YES
<input type="radio"/>	S	Steel	YES
<input type="radio"/>	N	Nylon	YES

[Material Specifications](#)

SELECT FINISH:

Plain Finish

* Finishes ending with an asterisk
are not RoHS Compliant

[Ordering non-standard items](#)

Logos and links to MW
Industries, ECIA, and
NEFDA