

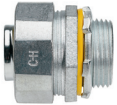







Liquidtight fittings

Overview

Our liquidtight product line offers high quality, high performance fittings. Designed to the toughest standards and integrating the latest technology, not only do you get a reliable and durable product, you also get one that reduces installation time and cost. Our versatile lines of liquidtight fittings are designed for a wide range of industrial, commercial and residential applications. Choose from our Liquidator™, LiQuik™, zinc die cast, non-metallic or low profile liquidtight fittings.

Liquidtight fittings selection chart:

| | Family | Material | Size/range | Configurations | Typical applications |
|---|----------------------------------|----------------------|------------|---|---|
|  | Liquidator™ | Malleable iron | 3/8" - 6" | Straight, 45°, 90° | For use with LFMC in tough, industrial, corrosive applications |
|  | Liquidator LT SA aluminum | Copper-free aluminum | 3/8" - 4" | Straight (3/8" through 4"), 90° (3/8" through 2") | Used where aluminum material is preferred in tough, industrial, corrosive applications |
|  | LTK low profile | Steel/malleable iron | 3/8" - 2" | Straight, 45°, 90° | Used where there are space restrictions in tough, industrial, corrosive applications |
|  | LTQ LiQuik™ | Malleable iron | 3/8" - 2" | Straight | Labor saving, no disassembly, in tough, industrial, corrosive applications |
|  | LTDC zinc die cast | Zinc die cast | 3/8" - 4" | Straight, 90° | Used where zinc die cast material is preferred in tough, industrial, corrosive applications |
|  | LTNM non-metallic | Nylon | 3/8" - 2" | Straight, 90° | Use with non-metallic Type B LT conduit in corrosive, commercial and residential applications |
|  | LTS steel | Tubular steel | 1/2" - 2" | Straight only | For use in cost-competitive applications in light industrial and commercial applications |
|  | LT SS stainless Steel | 304 stainless steel | 1/2" - 2" | Straight, 90° | Used where corrosion resistance is required in tough, industrial, corrosive applications |

Liquidtight

| Product features | User benefits |
|--|---|
| UL Listed; cUL certified | Assurance of safe and reliable performance; end-user peace of mind |
| Provides protection in wet locations | Meets NEC and UL requirements for use in wet locations; reduces downtime and replacement costs |
| Available in various configurations in various trade sizes and materials | Complete selection of styles and sizes; easy selection from one source, saves time and money |
| Hex surfaces on gland nut and body | Easy wrenching; fast, easy installation results in labor savings |
| Sealing gasket effectively seals out water, oil, dust and dirt | Eliminates leakage, potential downtime and replacement costs |
| Locknut bites into box; won't vibrate loose | Provides a reliable ground and safety of personnel and equipment |
| Cupped long grounding ferrule is distortion-free | Provides excellent pull-out strength, prevents conduit pop-out and provides grounding for safety of personnel and equipment |
| Concrete tight | Provides rugged durability in concrete applications |

Liquidtight fittings

Overview

Applications:

Typical applications for liquidtight conduit and liquidtight fittings include the wiring of machine tools, motors, transformers, food processing equipment, robotics, air conditioning units, illuminated storefront signs and billboards, etc. The flexible metallic conduit and fittings protect conductors from mechanical damage due to vibration and movement, and seal out cutting oils, coolants, water, dust, etc. Applications such as these can be found in, but are not limited to, industries such as:

- Machine tool manufacturers
- Electric power generating plants
- Waste treatment facilities
- Paint manufacturing facilities
- Automobile manufacturing facilities
- Aerospace industries
- Breweries
- Food processing plants
- Dairies
- Pulp and paper mills
- Petroleum refineries
- Chemical and petrochemical plants
- Healthcare

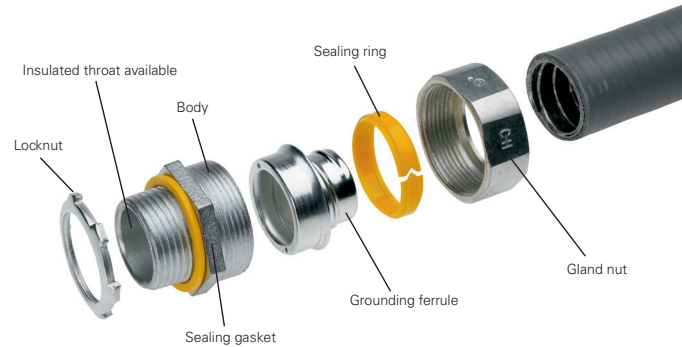

Features:

- Liquidtight, raintight, oiltight for protection and long life in wet, dusty and corrosive environments
- Hex shaped gland nut allows for easy wrenching, providing a fast, tight installation
- Suitable for wet locations
- Reusable, long ferrule prevents pull-out and tight bend conduit pop-out
- Furnished with locknut and sealing ring
- Third party certified
- Available in insulated and non-insulated versions to meet any customer preference

Certifications and compliances:

- UL Listed liquidtight flexible metal conduit fittings are suitable for use in the following hazardous locations under NEC:
 - Class I, Division 2;
 - Class II, Divisions 1 & 2; and
 - Class III, Divisions 1 & 2;
 - Suitable for grounding in sizes $\frac{3}{8}$ " through $1\frac{1}{4}$ " under NEC
- UL Standards 514B, 467
- cUL Standard C22.2 No. 18F
- UL File No. E-19189



Liquidtight fittings

Liquidator™ flexible metallic conduit fittings

Applications:

- Liquidator™ fittings are used when liquidtight conduit is in tough, industrial and corrosive applications
- Available in both malleable iron and aluminum construction with the option of a ground lug pre-attached

Features:

- Liquidtight, raintight, oiltight for protection and long life in wet, dusty and corrosive environments
- Hex shaped gland nut allows for easy wrenching, providing a fast, tight installation
- Suitable for wet locations
- Reusable, long ferrule prevents pull-out and tight bend conduit pop-out
- Furnished with locknut and sealing ring
- Third party certified
- Available in malleable iron and aluminum construction
- Available in straight, 90 and 45 degree configurations
- Available in sizes $\frac{3}{8}$ " to 6" (select sizes)
- Available in insulated and non-insulated versions to meet any customer preference

Certifications and compliances:

- UL Listed liquidtight flexible metal conduit fittings are suitable for use in the following hazardous locations under NEC:
 - Class I, Division 2;
 - Class II, Divisions 1 & 2; and
 - Class III, Divisions 1 & 2;
- Suitable for grounding in sizes $\frac{3}{8}$ " through $1\frac{1}{4}$ " under NEC
- UL Standards 514B, 467
- cUL Standard C22.2 No. 18F
- UL File No. E-19189

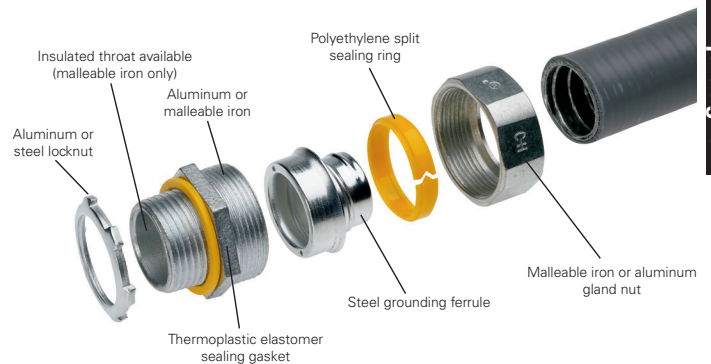

Liquidtight

Standard materials:

- Body – straight – $\frac{3}{8}$ " through 6": malleable iron; $\frac{3}{8}$ " through 4": aluminum
- 45° – $\frac{3}{8}$ " through 4": malleable iron
- 90° – $\frac{3}{8}$ " through 4": malleable iron or aluminum
- Gland nut – malleable iron or aluminum
- Ferrule – steel
- Gland nut sealing ring – polyethylene
- Sealing gasket – thermoplastic elastomer
- Locknut – steel or aluminum

Standard finishes:

- Malleable iron – zinc electroplate
- Aluminum – natural

Liquidtight fittings

Liquidator™ flexible metallic conduit fittings

Straight connectors – malleable iron

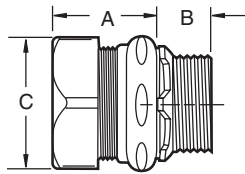
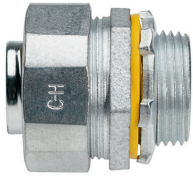

| Trade size | Cat. # Non-insulated | Cat. # Insulated | Unit qty. | Wt. lbs. per 100 | A | B | C |
|------------|----------------------|---------------------|-----------|------------------|-------|-------|-------|
| 3/8" | LT38 | LTB38 | 25 | 15.4 | 1.125 | 0.500 | 1.125 |
| 1/2" | LT50 | LTB50 | 25 | 17.6 | 1.250 | 0.500 | 1.250 |
| 3/4" | LT75 | LTB75 | 25 | 28.7 | 1.250 | 0.500 | 1.563 |
| 1" | LT100 | LTB100 | 5 | 39.7 | 1.438 | 0.625 | 0.813 |
| 1 1/4" | LT125 | LTB125 | 5 | 55.1 | 1.500 | 0.688 | 2.250 |
| 1 1/2" | LT150 | LTB150 | 2 | 70.5 | 1.625 | 0.750 | 2.438 |
| 2" | LT200 | LTB200 | 1 | 99.2 | 1.750 | 0.750 | 3.000 |
| 2 1/2" | LT250 | LTB250 | 1 | 363.8 | 2.188 | 1.000 | 4.000 |
| 3" | LT300 | LTB300 | 1 | 456.4 | 2.500 | 1.125 | 4.188 |
| 3 1/2" | LT350 | LTB350 | 1 | 668.0 | 2.625 | 1.188 | 5.250 |
| 4" | LT400 | LTB400 | 1 | 789.2 | 2.750 | 1.250 | 5.750 |
| 5" | LT500 [Ⓢ] | LTB500 [Ⓢ] | 1 | 1036.2 | 3.125 | 1.438 | 6.063 |
| 6" | LT600 [Ⓢ] | LTB600 [Ⓢ] | 1 | 1366.9 | 3.375 | 1.500 | 7.750 |

[Ⓢ] Not UL Listed or CSA certified.

Liquidtight

Straight connectors with grounding lug – malleable iron

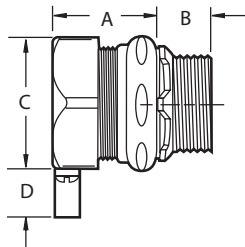

| Trade size | Cat. # Non-insulated with aluminum grounding lug | Cat. # Insulated with aluminum grounding lug | Cat. # insulated with copper grounding lug | Lug size | Unit qty. | Wt. lbs. per 100 | A | B | C | D |
|------------|--|--|--|-------------|-----------|------------------|-------|-------|-------|-------|
| 3/8" | LT38G | LTB38G | LTB38GC | #4 - #14 | 25 | 17.4 | 1.125 | 0.500 | 1.125 | 0.750 |
| 1/2" | LT50G | LTB50G | LTB50GC | #4 - #14 | 25 | 19.5 | 1.250 | 0.500 | 1.250 | 0.750 |
| 3/4" | LT75G | LTB75G | LTB75GC | #4 - #14 | 25 | 30.7 | 1.250 | 0.500 | 1.563 | 0.750 |
| 1" | LT100G | LTB100G | LTB100GC | #4 - #14 | 5 | 41.7 | 1.438 | 0.625 | 0.813 | 0.750 |
| 1 1/4" | LT125G | LTB125G | LTB125GC | #4 - #14 | 5 | 57.0 | 1.500 | 0.688 | 2.250 | 0.750 |
| 1 1/2" | LT150G | LTB150G | LTB150GC | #4 - #14 | 2 | 72.4 | 1.625 | 0.750 | 2.438 | 0.750 |
| 2" | LT200G | LTB200G | LTB200GC | #4 - #14 | 1 | 100.9 | 1.750 | 0.750 | 3.000 | 0.750 |
| 2 1/2" | LT250G | LTB250G | LTB250GC | #1/0 - #8 | 1 | 370.9 | 2.188 | 1.000 | 4.000 | 1.125 |
| 3" | LT300G | LTB300G | LTB300GC | #1/0 - #8 | 1 | 462.9 | 2.500 | 1.125 | 4.188 | 1.125 |
| 3 1/2" | LT350G | LTB350G | LTB350GC | #3/0 - #6 | 1 | 682.1 | 2.625 | 1.188 | 5.250 | 1.500 |
| 4" | LT400G | LTB400G | LTB400GC | #3/0 - #6 | 1 | 802.9 | 2.750 | 1.250 | 5.750 | 1.500 |
| 5" | LT500G [Ⓢ] | LTB500G [Ⓢ] | - | 250MCM - #6 | 1 | 1052.7 | 3.125 | 1.438 | 6.063 | 1.688 |
| 6" | LT600G [Ⓢ] | LTB600G [Ⓢ] | - | 250MCM - #6 | 1 | 1389.4 | 3.375 | 1.500 | 7.750 | 1.688 |

[Ⓢ] Not UL Listed or CSA certified.

Straight connectors with and without grounding lug – aluminum

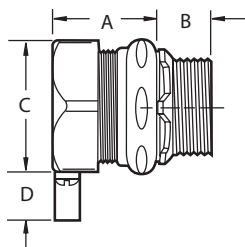
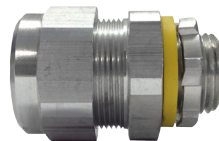

| Trade size | Cat. # Non-insulated | Cat. # Non-insulated with aluminum grounding lug | Lug size | Unit qty. | Wt. lbs. per 100 | A | B | C | D |
|------------|----------------------|--|-----------|-----------|------------------|-------|-------|-------|-------|
| 3/8" | LT38 SA | LT38G SA | #4 - #14 | 25 | 13.4 | 1.188 | 0.594 | 1.250 | 0.750 |
| 1/2" | LT50 SA | LT50G SA | #4 - #14 | 25 | 15.6 | 1.313 | 0.594 | 1.250 | 0.750 |
| 3/4" | LT75 SA | LT75G SA | #4 - #14 | 25 | 26.7 | 1.313 | 0.594 | 1.500 | 0.750 |
| 1" | LT100 SA | LT100G SA | #4 - #14 | 5 | 37.7 | 1.438 | 0.813 | 1.750 | 0.750 |
| 1 1/4" | LT125 SA | LT125G SA | #4 - #14 | 5 | 53.1 | 1.563 | 0.813 | 2.250 | 0.750 |
| 1 1/2" | LT150 SA | LT150G SA | #4 - #14 | 2 | 68.5 | 1.813 | 0.813 | 2.500 | 0.750 |
| 2" | LT200 SA | LT200G SA | #4 - #14 | 1 | 97.2 | 1.750 | 0.875 | 3.000 | 0.750 |
| 2 1/2" | LT250 SA | LT250G SA | #1/0 - #8 | 1 | 361.8 | 2.250 | 1.063 | 3.750 | 1.125 |
| 3" | LT300 SA | LT300G SA | #1/0 - #8 | 1 | 454.4 | 2.438 | 1.125 | 4.500 | 1.125 |
| 3 1/2" | LT350 SA | LT350G SA | #3/0 - #6 | 1 | 666.0 | 2.875 | 1.188 | 5.125 | 1.500 |
| 4" | LT400 SA | LT400G SA | #3/0 - #6 | 1 | 787.2 | 2.938 | 1.250 | 5.625 | 1.500 |

Liquidtight fittings

Liquidator™ liquidtight flexible metallic conduit fittings

90° angle connectors – malleable iron

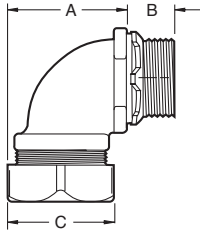

| Trade size | Cat. # Non-insulated | Cat. # Insulated | Unit qty. | Wt. lbs. per 100 | A | B | C |
|------------|----------------------|------------------|-----------|------------------|--------|-------|-------|
| 3/8" | LT3890 | LTB3890 | 25 | 25.4 | 1.313 | 0.500 | 1.125 |
| 1/2" | LT5090 | LTB5090 | 25 | 28.9 | 1.438 | 0.500 | 1.250 |
| 3/4" | LT7590 | LTB7590 | 10 | 44.1 | 1.625 | 0.500 | 1.563 |
| 1" | LT10090 | LTB10090 | 10 | 74.5 | 2.313 | 0.625 | 0.813 |
| 1 1/4" | LT12590 | LTB12590 | 5 | 96.1 | 2.375 | 0.688 | 2.250 |
| 1 1/2" | LT15090 | LTB15090 | 2 | 121.3 | 3.063 | 0.750 | 2.438 |
| 2" | LT20090 | LTB20090 | 1 | 176.4 | 3.188 | 0.750 | 3.000 |
| 2 1/2" | LT25090 | LTB25090 | 1 | 837.7 | 8.313 | 1.000 | 4.000 |
| 3" | LT30090 | LTB30090 | 1 | 1234.6 | 9.813 | 1.125 | 4.188 |
| 3 1/2" | LT35090 | LTB35090 | 1 | 1896.0 | 11.188 | 1.188 | 5.250 |
| 4" | LT40090 | LTB40090 | 1 | 2381.0 | 12.563 | 1.250 | 5.750 |

90° angle connectors with grounding lug – malleable iron

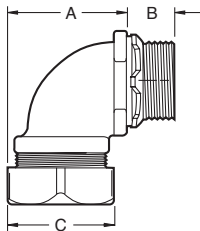

| Trade size | Cat. # Non-insulated with aluminum grounding lug | Cat. # Insulated with aluminum grounding lug | Cat. # Insulated with copper grounding lug | Lug size | Unit qty. | Wt. lbs. per 100 | A | B | C |
|------------|--|--|--|-----------|-----------|------------------|--------|-------|-------|
| 3/8" | LT3890G | LTB3890G | LTB3890GC | #4 - #14 | 25 | 27.6 | 1.313 | 0.500 | 1.125 |
| 1/2" | LT5090G | LTB5090G | LTB5090GC | #4 - #14 | 25 | 31.1 | 1.438 | 0.500 | 1.250 |
| 3/4" | LT7590G | LTB7590G | LTB7590GC | #4 - #14 | 10 | 46.3 | 1.625 | 0.500 | 1.563 |
| 1" | LT10090G | LTB10090G | LTB10090GC | #4 - #14 | 10 | 76.7 | 2.313 | 0.625 | 0.813 |
| 1 1/4" | LT12590G | LTB12590G | LTB12590GC | #4 - #14 | 5 | 98.3 | 2.375 | 0.688 | 2.250 |
| 1 1/2" | LT15090G | LTB15090G | LTB15090GC | #4 - #14 | 2 | 123.5 | 3.063 | 0.750 | 2.438 |
| 2" | LT20090G | LTB20090G | LTB20090GC | #4 - #14 | 1 | 178.6 | 3.188 | 0.750 | 3.000 |
| 2 1/2" | LT25090G | LTB25090G | LTB25090GC | #1/0 - #8 | 1 | 846.6 | 8.313 | 1.000 | 4.000 |
| 3" | LT30090G | LTB30090G | LTB30090GC | #1/0 - #8 | 1 | 1243.4 | 9.813 | 1.125 | 4.188 |
| 3 1/2" | LT35090G | LTB35090G | LTB35090GC | #3/0 - #6 | 1 | 1913.6 | 11.188 | 1.188 | 5.250 |
| 4" | LT40090G | LTB40090G | LTB40090GC | #3/0 - #6 | 1 | 2398.6 | 12.563 | 1.250 | 5.750 |

90° angle connectors with and without grounding lug – aluminum

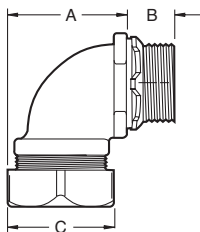

| Trade size | Cat. # Non-insulated | Cat. # Non-insulated with aluminum grounding lug | Lug size | Unit qty. | Wt. lbs. per 100 | A | B | C |
|------------|----------------------|--|----------|-----------|------------------|-------|-------|-------|
| 3/8" | LT3890 SA | LT3890G SA | #4 - #14 | 25 | 16 | 1.313 | 0.500 | 1.125 |
| 1/2" | LT5090 SA | LT5090G SA | #4 - #14 | 25 | 20 | 1.438 | 0.500 | 1.250 |
| 3/4" | LT7590 SA | LT7590G SA | #4 - #14 | 10 | 25 | 1.625 | 0.500 | 1.563 |
| 1" | LT10090 SA | LT10090G SA | #4 - #14 | 10 | 31 | 2.313 | 0.625 | 0.813 |
| 1 1/4" | LT12590 SA | LT12590G SA | #4 - #14 | 5 | 48 | 2.375 | 0.688 | 2.250 |
| 1 1/2" | LT15090 SA | LT15090G SA | #4 - #14 | 2 | 150 | 3.063 | 0.750 | 2.438 |
| 2" | LT20090 SA | LT20090G SA | #4 - #14 | 1 | 200 | 3.188 | 0.750 | 3.000 |

Liquidtight

Liquidtight fittings

Liquidator™ liquidtight flexible metallic conduit fittings

45° angle connectors – malleable iron

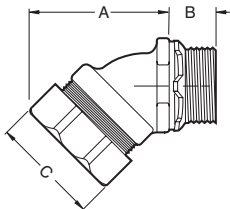

| Trade size | Cat. # Non-insulated | Cat. # Insulated | Unit qty. | Wt. lbs. per 100 | A | B | C |
|------------|----------------------|------------------|-----------|------------------|--------|-------|-------|
| 3/8" | LT3845 | LTB3845 | 25 | 27.1 | 1.938 | 0.500 | 1.125 |
| 1/2" | LT5045 | LTB5045 | 25 | 27.1 | 2.000 | 0.500 | 1.250 |
| 3/4" | LT7545 | LTB7545 | 10 | 39.7 | 2.188 | 0.500 | 1.563 |
| 1" | LT10045 | LTB10045 | 10 | 63.5 | 2.500 | 0.625 | 0.813 |
| 1 1/4" | LT12545 | LTB12545 | 5 | 87.3 | 2.813 | 0.688 | 2.250 |
| 1 1/2" | LT15045 | LTB15045 | 2 | 110.2 | 3.000 | 0.750 | 2.438 |
| 2" | LT20045 | LTB20045 | 1 | 176.4 | 3.688 | 0.750 | 3.000 |
| 2 1/2" | LT25045 | LTB25045 | 1 | 573.2 | 7.313 | 1.000 | 4.000 |
| 3" | LT30045 | LTB30045 | 1 | 859.8 | 7.625 | 1.125 | 4.188 |
| 3 1/2" | LT35045 | LTB35045 | 1 | 1278.7 | 9.625 | 1.188 | 5.250 |
| 4" | LT40045 | LTB40045 | 1 | 1521.2 | 11.063 | 1.250 | 5.750 |

Liquidtight

45° angle connectors with grounding lug – malleable iron

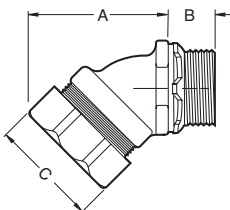

| Trade size | Cat. # Non-insulated with aluminum grounding lug | Cat. # Insulated with aluminum grounding lug | Cat. # Insulated with copper grounding lug | Lug size | Unit qty. | Wt. lbs. per 100 | A | B | C |
|------------|--|--|--|-----------|-----------|------------------|--------|-------|-------|
| 3/8" | LT3845G | LTB3845G | LTB3845GC | #4 - #14 | 25 | 29.3 | 1.938 | 0.500 | 1.125 |
| 1/2" | LT5045G | LTB5045G | LTB5045GC | #4 - #14 | 25 | 29.3 | 2.000 | 0.500 | 1.250 |
| 3/4" | LT7545G | LTB7545G | LTB7545GC | #4 - #14 | 10 | 41.9 | 2.188 | 0.500 | 1.563 |
| 1" | LT10045G | LTB10045G | LTB10045GC | #4 - #14 | 10 | 65.7 | 2.500 | 0.625 | 0.813 |
| 1 1/4" | LT12545G | LTB12545G | LTB12545GC | #4 - #14 | 5 | 89.5 | 2.813 | 0.688 | 2.250 |
| 1 1/2" | LT15045G | LTB15045G | LTB15045GC | #4 - #14 | 2 | 112.4 | 3.000 | 0.750 | 2.438 |
| 2" | LT20045G | LTB20045G | LTB20045GC | #4 - #14 | 1 | 178.6 | 3.688 | 0.750 | 3.000 |
| 2 1/2" | LT25045G | LTB25045G | LTB25045GC | #1/0 - #8 | 1 | 582.0 | 7.313 | 1.000 | 4.000 |
| 3" | LT30045G | LTB30045G | LTB30045GC | #1/0 - #8 | 1 | 868.6 | 7.625 | 1.125 | 4.188 |
| 3 1/2" | LT35045G | LTB35045G | LTB35045GC | #3/0 - #6 | 1 | 1296.3 | 9.625 | 1.188 | 5.250 |
| 4" | LT40045G | LTB40045G | LTB40045GC | #3/0 - #6 | 1 | 1538.8 | 11.063 | 1.250 | 5.750 |

Replacement liquidtight ferrules



| Trade size | Cat. # | Unit qty. | Wt. lbs. per 100 |
|------------|--------|-----------|------------------|
| 3/8" | FEA38 | 100 | 1.9 |
| 1/2" | FEA50 | 100 | 2.2 |
| 3/4" | FEA75 | 100 | 2.5 |
| 1" | FEA100 | 100 | 3.1 |
| 1 1/4" | FEA125 | 50 | 5.0 |
| 1 1/2" | FEA150 | 50 | 6.3 |
| 2" | FEA200 | 10 | 8.1 |
| 2 1/2" | FEA250 | 10 | 21.3 |
| 3" | FEA300 | 10 | 27.5 |
| 3 1/2" | FEA350 | 10 | 31.3 |
| 4" | FEA400 | 10 | 34.4 |