

THIS COPY IS PROVIDED ON A RESTRICTED BASIS AND IS NOT TO BE USED IN ANY WAY DETRIMENTAL TO THE INTERESTS OF PANDUIT CORP.

LAB			DIMENSIONS										
PRT. NO.	WIRE	STUD	BARREL				TONGUE			STUD			
			A±.12	B±.10	D±.015	E±.01	W±.04	T±.03	P MIN.	G±.10	S±.04	C REF.	H±.03
LAB1/0-38	1/0	3/8	5.33	1.55	.640	.394	.88	.25	3.16	.63	1.75	.88	.43
LAB2/0-12	2/0	1/2	5.55	1.55	.687	.439	.94	.25	3.16	.63	1.75	.88	.54
LAB3/0-12	3/0	1/2	5.55	1.55	.760	.484	1.03	.27	3.16	.63	1.75	.88	.54
LAB4/0-12	4/0	1/2	5.98	1.80	.875	.547	1.19	.31	3.28	.63	1.75	1.00	.54
LAB250-12	250 MCM	1/2	6.05	1.80	.906	.594	1.25	.31	3.28	.63	1.75	1.00	.54

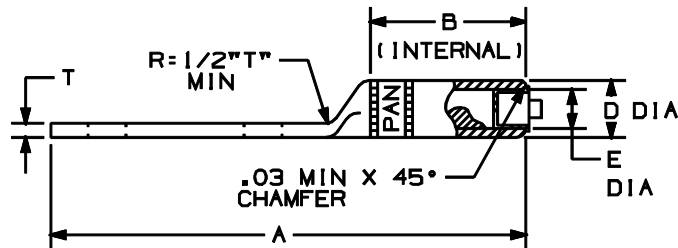
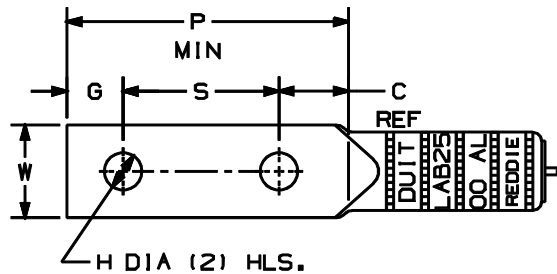

NOTES:

- FOR USE WITH STRANDED ALUMINUM/ COPPER WIRE ONLY.
- USE THE FOLLOWING PANDUIT INSTALLATION TOOLING:

TOOL NO.	WIRE RANGE
CT-720	#6-350
CT-920	#6-1000
CT-930	#6-1000
CT-940CH	#6-1000
CT-980	#6-500
CT-2001	#6-300

- LUGS ARE APPROVED BY:



LISTED  
587H  
E52164



CERTIFIED  
LR31212

- BARREL COLOR CODED WITH DIE SET INDEX NUMBER.

C41153\_01

**PANDUIT**

CORP.

TINLEY PARK, ILLINOIS

01 3-01 RM FILESPEC WAS N41153CA\_PCD\_00

00 4/95 MS RELEASED 03183

LAB SERIES ALUMINUM LUGS  
#1/0 THRU 250 MCM

REV	DATE	BY	CHK	DESCRIPTION	ECN #	CUST	PM	DRAWN BY	CHK'D	SCALE	DRAWING NO.
								MS		N/A	C41153