

SD

KTH-2248

REVISIONS

ISSUE	CHANGES
-------	---------

0	ER 37375 JW 09/09/97
---	-------------------------

KTH2248B

SCALE 2:1

APPROX SURFACE AREA

USED ON

REF:

CRIMP DIE

DRAWN JW	DATE 08/20/97
DESIGN LJ	DATE 08/19/97
APPR. FDH	DATE 09/08/97

**KINGS**  
ELECTRONICS CO., INC.  
TUCKAHOE, NEW YORK 10707

KTH-2248

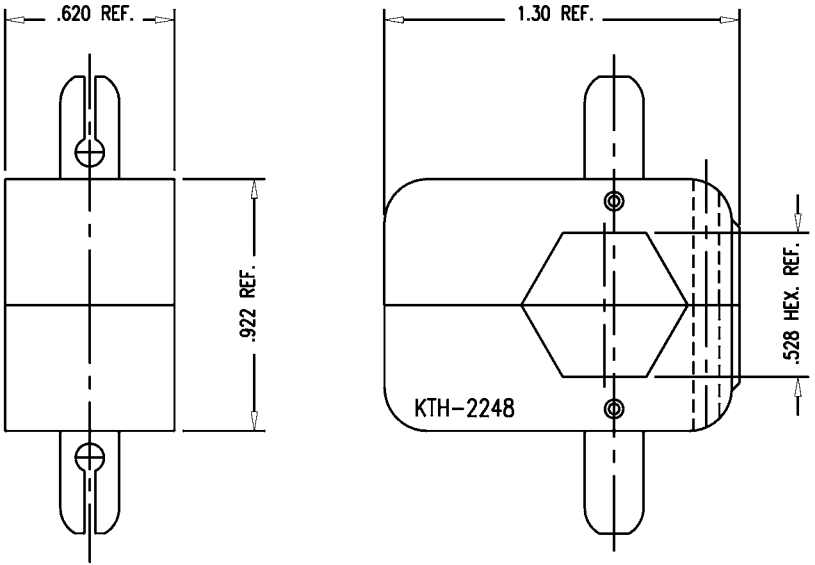

- NOTES:
1. MATERIAL: ALLOY STEEL
  2. FINISH: BLACK OXIDE (AFTER HEAT TREATING).
  3. FOR USE WITH GEPCO/COMMSCOPE 7826 MOHAWK M52479 & BELDEN 9232 CABLE.

SD