

GSD

KH-99-10

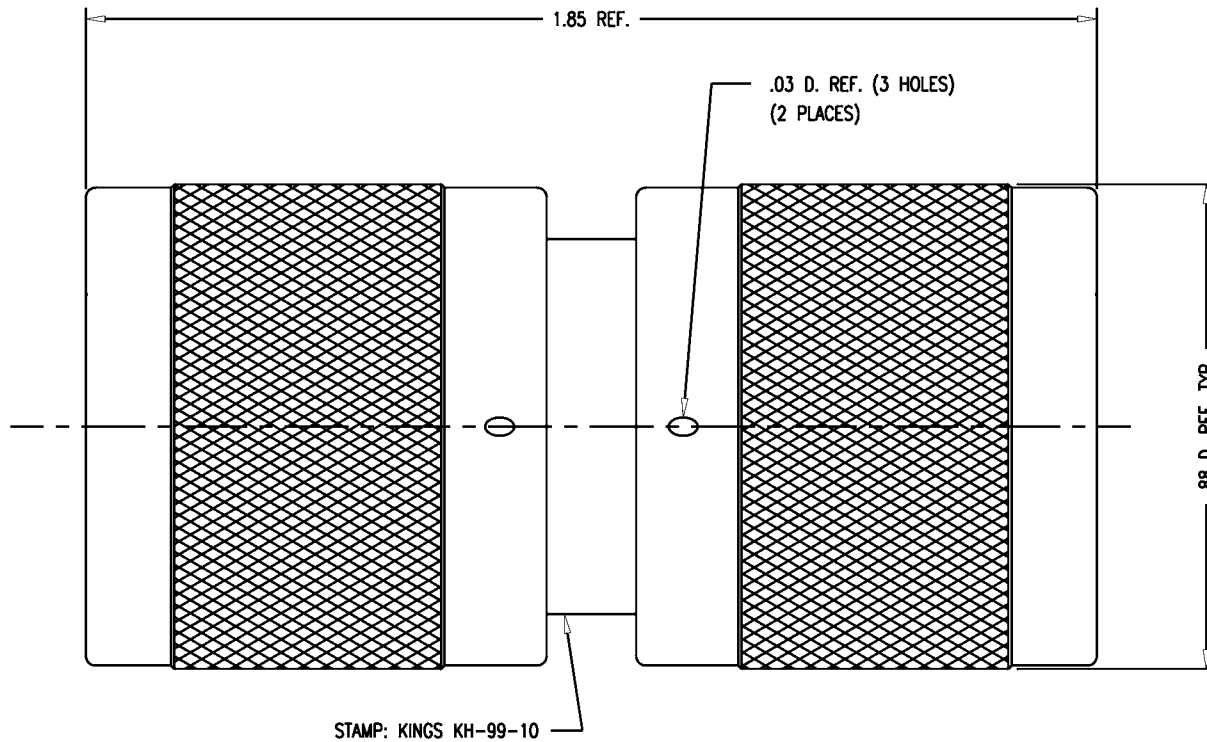

STAMP: KINGS KH-99-10

NOTES:

1. INTERFACE PER MIL-STD-348, FIG. 317-1.
2. MATERIALS:
 - INSULATORS- TEFLON, ASTM-D-1457
 - GASKETS- SILICONE RUBBER, ZZ-R-765
 - OUTER CONTACT- BER. COP., ASTM-B-196
 - C-RING- PHOSPHOR BRONZE, QQ-B-750
 - ALL OTHER METAL PARTS- BRASS, ASTM-B16
3. FINISHES:
 - CENTER CONTACTS- GOLD PLATE PER MIL-G-45204
 - ALL OTHER METAL PARTS- SILVER PLATE PER QQ-S-365
4. ELECTRICAL CHARACTERISTICS:
 - WORKING VOLTAGE- 1500 VRMS
 - FREQUENCY RANGE- DC TO 4 GHZ
 - NOMINAL IMPEDANCE- 50 OHMS

REVISIONS

ISSUE	CHANGES
1	CN 34949 C REDRAWN KH 09/29/93

KAM3085

SCALE 4:1	
APPROX SURFACE AREA	
USED ON	
REF:	
ADAPTER, HN, M-M	
DRAWN KH	DATE 09/29/93
DESIGN MJB	DATE 10/01/93
APPR.	DATE

KINGS
ELECTRONICS CO., INC.
TUCKAHOE, NEW YORK 10707

KH-99-10

GSD