

# GSD

REVISIONS	
ISSUE	CHANGES
5	CN 33602 E REDRAWN WJM 12/17/91
6	CN 36889 C MJB 03/22/96
7	CN 37800 E TML 03/08/99
8	CN 38236 C TML 02/27/01

M39012/16-0008

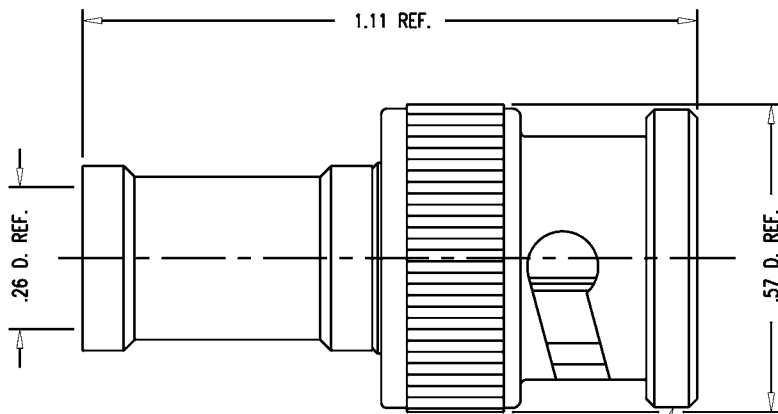

STAMP: 91836 M39012/16B0008 KC-59-220 YR WK  
DATE CODE

**NOTES:**

- FOR USE WITH RG-59, 59A, 59B, 62, 62A, 62C & 210/U CABLE.
- FOR CABLING INSTRUCTIONS SEE CP-401.
- FOR CABLE TRIMMING USE KTH-57 & KTD-26.
- FOR CRIMPING USE DIE KTH-2062.
- INTERFACE PER MIL-STD-348, FIG. 301-1.
- MATERIALS:  
 INSULATOR: TEFLON, ASTM-D-1457  
 K-GRIP SLEEVE: COM. BRONZE TUBE, ALLOY 220  
 GASKET: SILICONE RUBBER, ZZ-R-765  
 OUTER CONTACT } BER. COPPER, ASTM-B-196  
 SPRING WASHER }  
 ALL OTHER METAL PARTS: BRASS, ASTM-B16
- FINISHES:  
 CENTER CONTACT: HARD GOLD PLATE, PER MIL-G-45204  
 ALL OTHER METAL PARTS: BRASS, ASTM-B16
- ELECTRICAL CHARACTERISTICS:  
 NOMINAL IMPEDANCE: 50 OHMS  
 WORKING VOLTAGE: 500 VRMS  
 FREQUENCY RANGE: 4 GHz.

WAS:  
WJM1613 KC59220S

SCALE	4:1		
APPROX SURFACE AREA	KC-59-220		
USED ON			
REF:	SUPERSEDES UG-1789/U		
<b>PLUG, BNC</b>			
DRAWN	WJM	DATE	12/17/91
DESIGN	MJB	DATE	02/05/92
APPR.		DATE	

**KINGS**  
ELECTRONICS CO., INC.  
ROCK HILL, SOUTH CAROLINA 29730

M39012/16-0008

# GSD