

K85R1X/K85R2X Series
Right Angle PCB Mount Open Body

Ordering Information

K85R1X-	E	D	-	9	S	-	N	
Series	Shell Size	Contact Construction		Number of Contacts	Contact Type		Mounting Options	Plating Options

Series

K85R1X - Kycon D-Subminiature Connector, Right Angle PCB Termination .283" (7.2 mm) Foot Print

K85R2X - Kycon D-Subminiature Connector, Right Angle PCB Termination .370" (9.4 mm) European Foot Print

Shell Size

- E - 9 Contacts
- A - 15 Contacts
- B - 25 Contacts
- C - 37 Contacts

Contact Construction

D - Precision Formed Right Angle

Number of Contacts

9, 15, 25, 37

Pin Contact Type

- P - Pin Contact (Plug)
- S - Socket Contact (Receptacle)

Plating Options and Performance Specifications

D-SUBMINIATURE CONNECTORS

K85R1X / K85R2X Series

Mounting Options *

*Metric Jack Screws also available. (see page 38)

No Designator - No Mounting Brackets

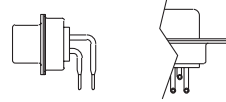

O - Mounting Brackets with .120" Dia. Non-Threaded Mounting Holes and Riveted Threaded Inserts

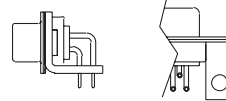

OJ - Mounting Brackets with .120" Dia. Non-Threaded Mounting Holes and Riveted Threaded Inserts with JS-1055 4-40 Hex Jackscrews Installed

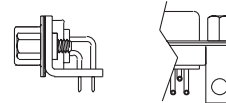

OR - Mounting Brackets with .120" Dia. Non-Threaded Mounting Holes with 4-40 Round Jackscrews Riveted to Connector

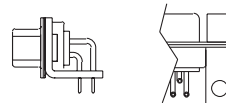

N - Mounting Brackets with Grounding Boardlocks and Riveted Threaded Inserts

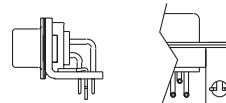

NJ - Mounting Brackets with Grounding Boardlocks and Riveted Threaded Inserts with JS-1055 4-40 Hex Jackscrews Installed

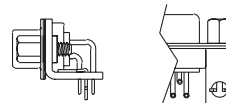

NR - Mounting Brackets with Grounding Boardlocks and Riveted Threaded Inserts with 4-40 Round Jackscrews Riveted to Connector

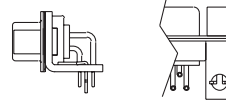

K - (No Mounting Brackets) Riveted Threaded 4-40 Bushings

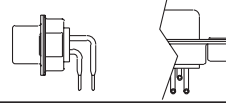

KJ - (No Mounting Brackets) Riveted Threaded 4-40 Bushings with JS-1055 4-40 Hex Jackscrews Installed

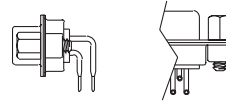

K85R1X/K85R2X Dimensions

Standard with No Mounting Brackets

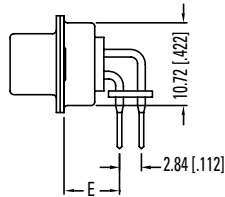
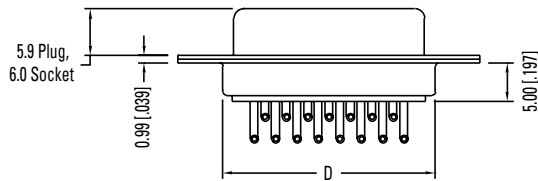
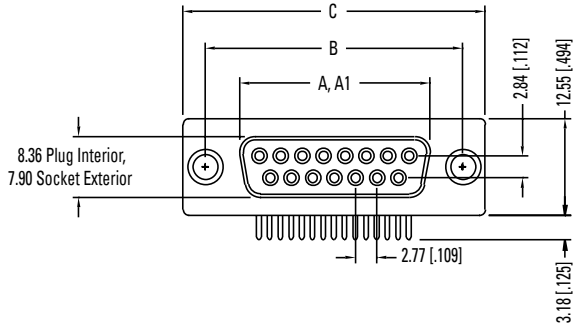

K85R1X/K85R2X Dimensions

With Mounting Brackets, and Grounding Board Locks

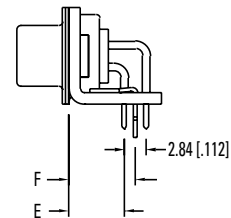
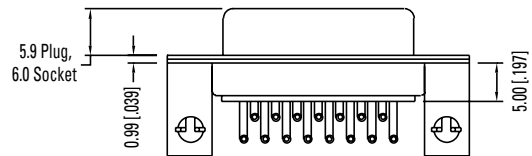
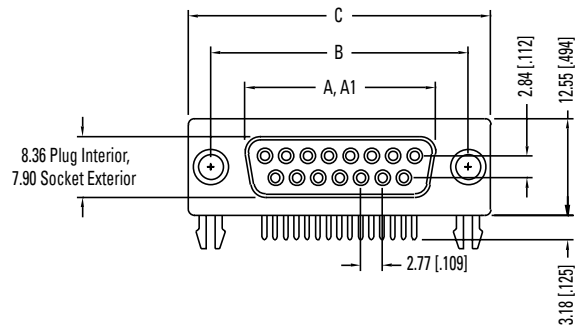

Dimensions in mm [In]

Number of Contacts (Shell Size)	Dimensions (Inch/mm) K85R1X/K85R2X				
	A	A1	B	C	D
9 (E)	.643 16.33	.666 16.92	.984 24.99	1.213 30.81	.795 20.19
15 (A)	.971 24.66	.994 25.25	1.312 33.32	1.541 39.14	1.083 27.51
25 (B)	1.511 38.38	1.534 38.96	1.852 47.04	2.088 53.04	1.652 41.96
37 (C)	2.159 54.84	2.182 55.42	2.500 63.50	2.729 69.32	2.272 57.71

Series	E Dimension	F Dimension
K85R1X	7.2mm (.283)	8.62mm (.339)
K85R2X	9.4mm (.370)	10.82mm (.425)

A = Exterior of Female Shell (S)
A1 = Interior of Male Shell (P)

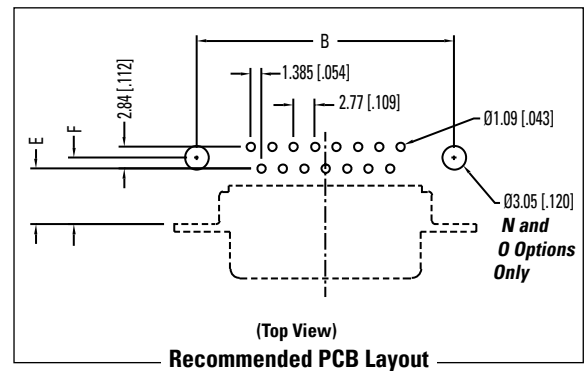

KYCON continues its leadership in D-Subminiature connectors by offering a complete line of sizes and options.

PC99 Colors Available:

- HD15: Blue
- DB15: Gold
- DB25: Burgundy
- DB09: Teal



D-SUBMINIATURE CONNECTORS

Performance Specifications

Materials and Finish

Shell

Steel Material, Tin or Nickel Finish, and Indentations (Dimples) on Plug Only

Insert

Standard: PBT Thermoplastic, Black Color, 30% Glass Filled, 94V-0 Rated

Reflow Compatible: High Temperature Thermoplastic, Black Color, 30% Glass Filled, 94V-0 Rated

Contact Material

Plug : Brass .040 (1.00) Diameter Standard; .030 (0.76) Diameter High Density

Socket: Phosphor Bronze (Precision Formed Contact)

Brass (Precision Machined Contact)

Contact Finish-Standard

Gold Flash Over 0.0001 (0.00254) Nickel on Mating End of Contacts

Tin Over Nickel or Gold Flash Over Nickel on Solder Tails

Riveted Insert

Brass Material, Nickel Finish

Mechanical Characteristics

Durability

500 Insertion Cycles Min

Operating Temperature Rating

-55°C to +105°C

Electrical Characteristics

Contact Current Rating

5A

Contact Resistance

30 Milliohms Max

Dielectric Withstanding Voltage

1000 V AC Min for 1 Minute

Insulation Resistance

1000 Megohms Min, at 500 V DC

Processing Characteristics

Soldering Temperature Rating

High Temperature Plastic: 260 °C for 10 Seconds

Plating Options

Designator	Plating Description
Standard	Gold Flash over Nickel on Contacts. Gold Flash over Nickel or Tin over Nickel on Solder Tails.
15	15µ" Gold over Nickel on Mating End of Contacts. Tin over Nickel on Solder Tails.
30	30µ" Gold over Nickel on Mating End of Contacts. Tin over Nickel on Solder Tails.