

## K66 Series High Density Right Angle PCB Mount

### Ordering Information

K66	-	E	15	S	-	N	15	-	VESA
Series		Shell Size	Number of Contacts	Contact Type		Mounting Options	Plating Options		VESA Options

#### Series

K66 - Kycon High Density D-Subminiature Connector,  
Right Angle PCB Termination, .350 Footprint  
K66HT - Reflow Compatible Version

#### Shell Size, Number of Contacts

E-15 Contacts  
A-26 Contacts  
B-44 Contacts  
C-62 Contacts

#### Contact Type

P-Pin Contact (Plug)  
S-Socket Contact (Receptacle)

#### Mounting Options (See page 35)

#### Plating Options and Performance Specifications (See page 4)

#### VESA Options (15 Pin Receptacle Only)

Blank-Standard  
VESA - VESA Compliant Version

### VESA Features

- Right Angle PCB Termination, 15 Pin Receptacle, .350 Footprint
- Contact #9 Recessed 0.050" (1.27mm) to Allow Last Mate/First Break on 5V Supply Voltage
- Blue PBT Insulator Signifies 5V Capability and Full Feature AccessBus Capability in Accordance with Video Electronics Standard Association (VESA)
- Meets Display Data Channel (DDC) Standard

## D-SUBMINIATURE CONNECTORS

### K66 Series

### K66 Series Dimensions

Pictured with Board Lock Option, Dimensions in mm

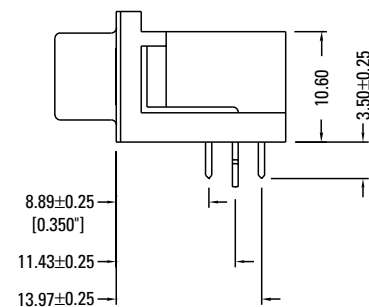
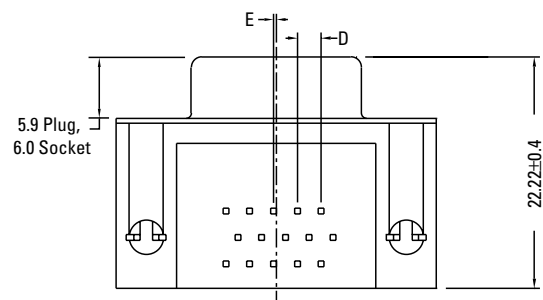
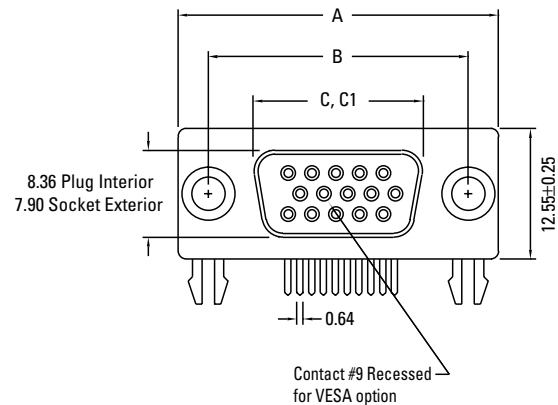

Shell Size	A	B	C	C1	D	E
	In mm	± .015 ± 0.38	± .005 ± 0.13	± .010 ± 0.25	± .010 ± 0.25	± .005 ± 0.13
<b>15</b> (E)	<b>1.213</b> 30.81	<b>.984</b> 24.99	<b>.643</b> 16.33	<b>.666</b> 16.92	<b>.090</b> 2.29	<b>.010</b> 0.25
<b>26</b> (A)	<b>1.541</b> 39.14	<b>1.312</b> 33.32	<b>.971</b> 24.66	<b>.994</b> 25.25	<b>.090</b> 2.29	<b>.020</b> 0.51
<b>44</b> (B)	<b>2.088</b> 53.04	<b>1.852</b> 47.04	<b>1.511</b> 38.38	<b>1.534</b> 38.96	<b>.090</b> 2.29	<b>.020</b> 0.51
<b>62</b> (C)	<b>2.729</b> 69.32	<b>2.500</b> 63.50	<b>2.159</b> 54.84	<b>2.182</b> 55.42	<b>.095</b> 2.41	<b>.023</b> 0.58

**C = Exterior of Female Shell (S)**

**C1 = Interior of Male Shell (P)**

**Female (Receptacle): Top View**

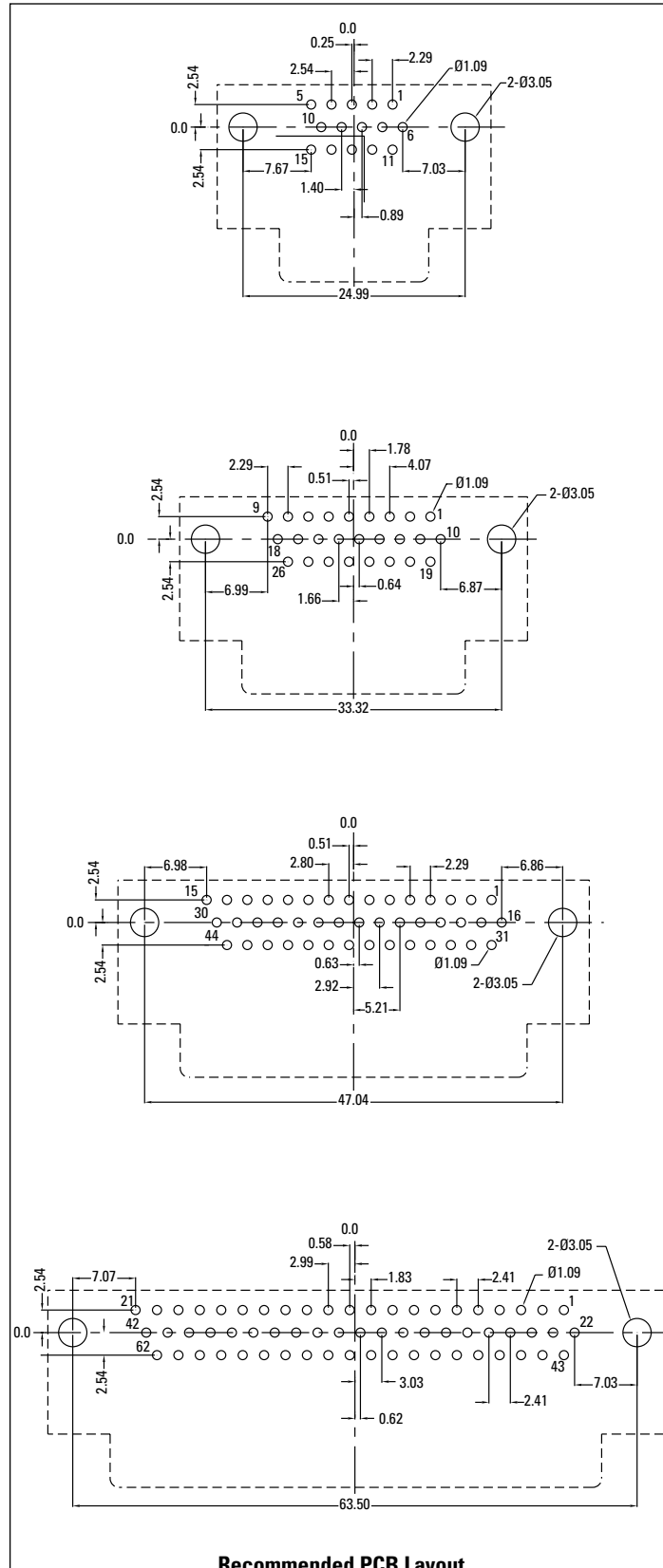

**Male (Plug): Bottom View**

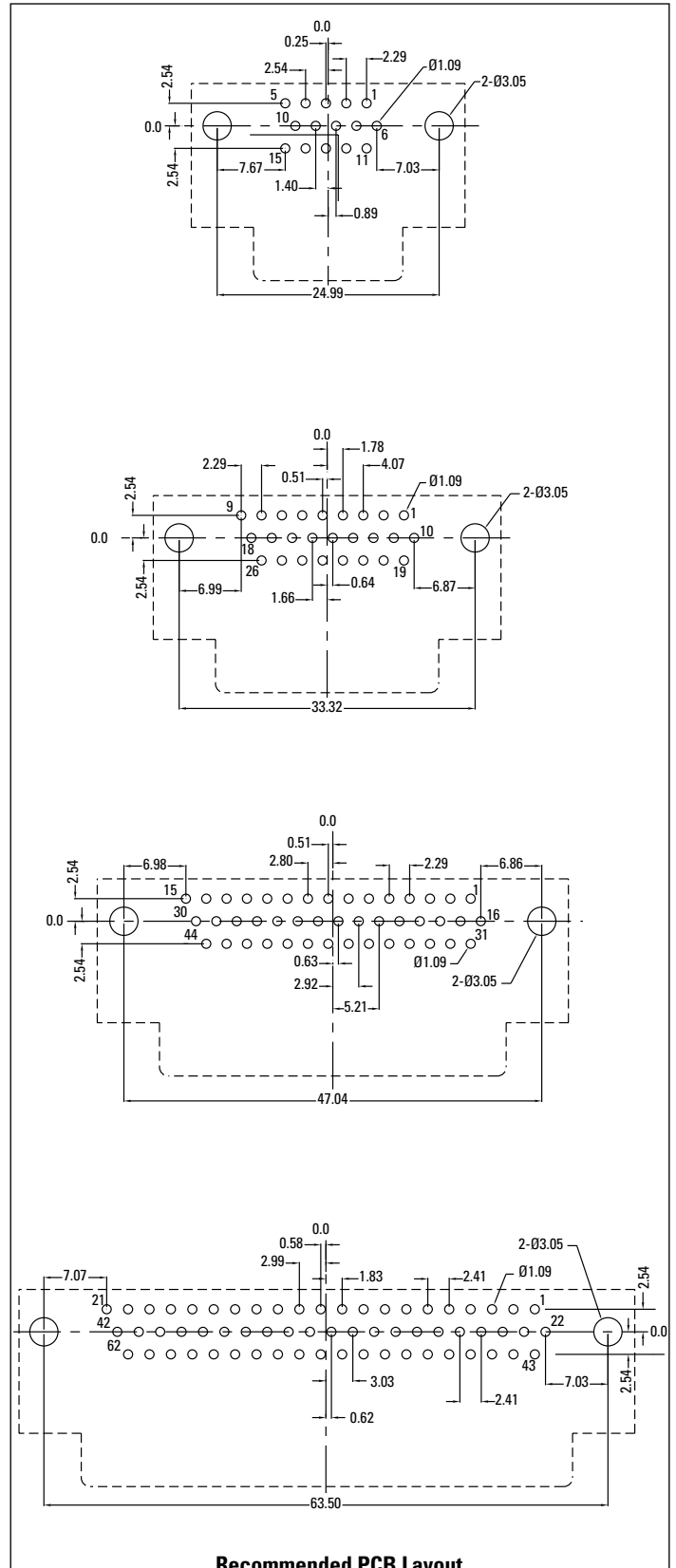

**Mounting Options**  
**K22, KF22,**  
**K66, KF66**

Front Panel Mounting Options	PCB Mounting Options			
	Grounding Board Locks	Top Only Grounding Straps with Non-Threaded .125" Diameter Mounting Holes	Wrap Around Grounding Straps with Non-Threaded .125" Diameter Mounting Holes (K22/KF22/Only)	4 Prong Board Locks
Riveted Threaded Inserts	<b>N</b>	<b>H</b>	<b>O</b>	<b>NV</b>
Riveted Threaded Inserts with 4-40 Hex. Jack Screws Installed	<b>NJ</b>	<b>HJ</b>	<b>OJ</b>	<b>NVJ</b>
4-40 Round Jackscrews Riveted to Connector	<b>NR</b>	<b>HR</b>	<b>OR</b>	<b>NVR</b>
Non-Threaded Riveted Inserts	<b>NT</b>	<b>HT</b>	<b>OT</b>	<b>NVT</b>
Riveted Threaded Inserts with M3/4-40 Hex. Jack Screws Installed	<b>NJM</b>	<b>HJM</b>	<b>OJM</b>	<b>NVJM</b>

**PC Board Mounting Options**

**N Option**

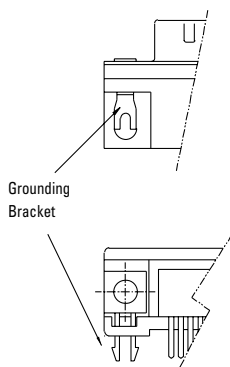

**H Option**

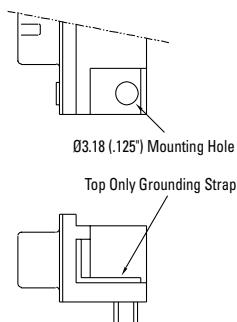

**O Option**

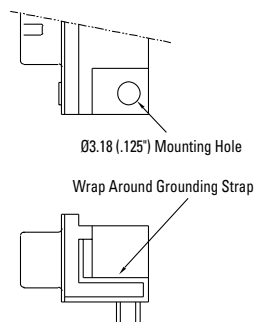

**NV Option**

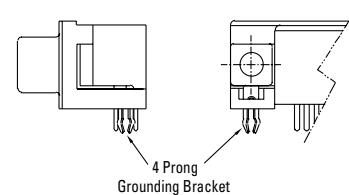

**Front Panel Mounting Options**

**Standard**

(4-40) Riveted Threaded Insert

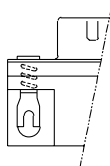

**-J Option**

(4-40) Riveted Threaded Insert with 4-40 Hex. JS1000 Jack Screws Installed to Connector

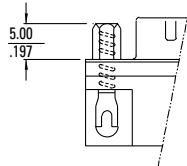

**-R Option**

(4-40) Round Jack Screws Riveted to Connector

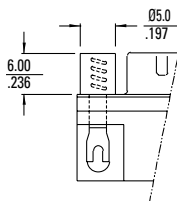

**-T Option**

Riveted Non-Threaded Insert 3.18/.125" Dia.

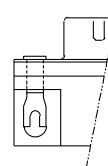

**-JM Option**

(4-40) Riveted Threaded Insert with M3/4-40 Hex. JS-M3131 Jack Screws Installed to Connector

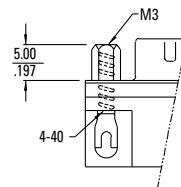

*KYCON continues its leadership in D-Subminiature connectors by offering a complete line of sizes and options.*

**PC99 Colors Available:**

- HD15: Blue
- DB15: Gold
- DB25: Burgundy
- DB09: Teal



## D-SUBMINIATURE CONNECTORS

### Performance Specifications

#### Materials and Finish

**Shell**

Steel Material, Tin Finish, and Indentations (Dimples) on Plug Only

**Insert**

Standard: PBT Thermoplastic, Black Color, 30% Glass Filled, 94V-0 Rated  
 Reflow Compatible: High Temperature Thermoplastic, Black Color, 30% Glass Filled, 94V-0 Rated

**Contact Material**

Pin: Brass .040 (1.02) Diameter Standard; .030 (0.76) Diameter High Density  
 Socket: Phosphor Bronze (Precision Formed Contact)  
 Brass (Precision Machined Contact)

**Contact Finish-Standard**

Gold Flash Over 0.0001 (0.00254) Nickel on Mating End of Contacts  
 Tin/Lead Over Nickel or Gold Flash Over Nickel on Solder Tails

**Riveted Insert**

Brass Material, Nickel Finish

#### Mechanical Characteristics

**Contact Retention**

Precision Machined Contact 10 Lbs, Precision Formed Contact 10 Lbs

**Contact Extraction Force**

Typ. 4 Oz.

**Contact Insertion Force**

Typ. 9 Oz.

**Durability**

1,000 Insertion Cycles Min (With Standard Plating)

**Operating Temperature Rating**

-55°C to +125°C

#### Electrical Characteristics

**Contact Current Rating**

Precision Machined Contact 7.6 Amps  
 Precision Formed Contact 5.0 Amps (Except K99 Series)

**Contact Resistance**

Precision Machined Contact 5 Milliohms Max  
 Precision Formed Contact 8 Milliohms Max

**Dielectric Withstanding Voltage**

1000 V AC Min for 1 Minute

**Insulation Resistance**

5000 Megohms Min

#### Processing Characteristics

**Soldering Temperature Rating**

High Temperature Plastic: 230°C for 30 Seconds, 260°C for 10 Seconds

#### Plating Options

Designator	Plating Description
Standard	Gold Flash over Nickel on Contacts. Gold Flash over Nickel or Tin/Lead over Nickel on Solder Tails.
15	15µ" Gold over Nickel on Mating End of Contacts. Tin/Lead over Nickel on Solder Tails.
30	30µ" Gold over Nickel on Mating End of Contacts. Tin/Lead over Nickel on Solder Tails.