

Recommended PCB Layout (Top View)

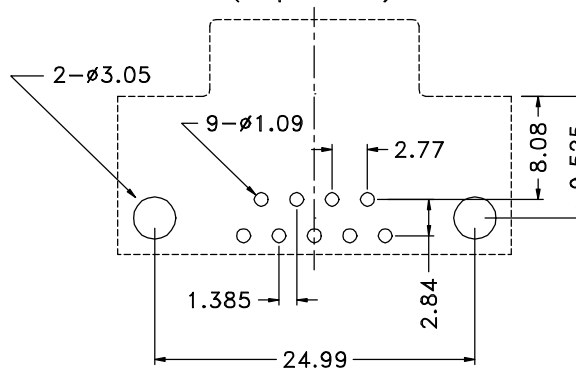

Material and Finish

Shell: Steel, zinc plated or tin plated
 Insulator: PBT with glass-fiber reinforcement
 UL 94V-0
 color-black

Contact Material:
 Plug- Brass
 Socket- Phosphor bronze

Duplex plated as follows:

- 30 .000030" [0.00076mm] gold on mating end, tin-lead on termination end, with entire contact nickel
- 15 .000015" [0.00038mm] gold on mating end, tin-lead on termination end, with entire contact nickel

(Standard) Gold flash on mating end, Gold flash or tin-lead on termination end, with nickel underplate on entire contact

Electrical Specifications

- Rated Current: 5A
- Rated Voltage: 300V DC
- Withstanding Voltage: 500V (rms) AC for 1 min
- Insulation Resistance: more than 1000 Mohm at 500v DC
- Contact Resistance: 13 mohm Max
- Dielectric Strength: 1000V for 1 min
- Temperature Rating: -55°C to +105°C

CSA NRTL/C Certified File No. LR78160
 UL Recognized File No. E169636

REVISION	DATE	DESCRIPTION	DRAWN BY	DESIGNED BY	UNITS
A	12/19/96	New Drawing	C. Leiva		mm
			CHECKED BY	APPROVED BY	DATE
					12/19/96

K22-E9S-NJ

RT. Ang D-Sub, Female

0.318" Footprint, With Jack Screws

