

**Recommended PCB Layout  
(Top View)**

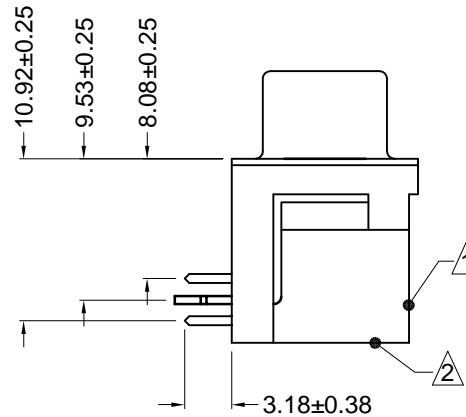
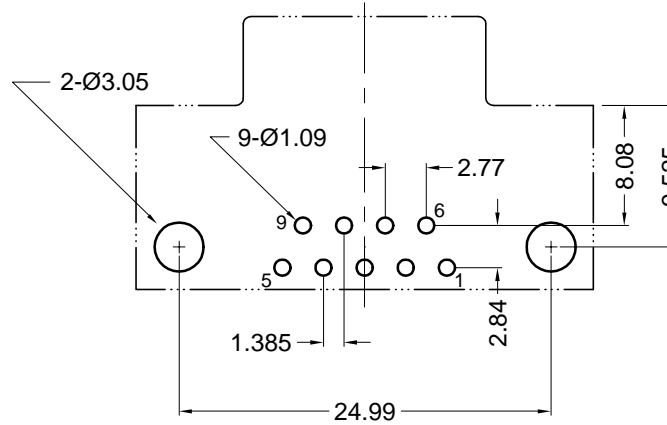

**Material and Finish**

Shell: steel, tin plated  
 Insulator: PBT thermoplastic, 30% glass-fiber reinforcement, UL94V-0 rated, black color  
 Contact Material: phosphor bronze  
 Contact Plating Options:  
 Standard: gold flash on mating end, tin-lead on termination end, 50u" nickel underplate on entire contact  
 15 Option: 0.000015" gold on mating end, tin-lead on termination end, 50u" nickel underplate on entire contact  
 30 Option: 0.000030" gold on mating end, tin-lead on termination end, 50u" nickel underplate on entire contact

**Specifications**

Rated Current: 5A  
 Rated Voltage: 300V DC  
 Withstanding Voltage: 500V (r.m.s.) AC for 1 minute  
 Insulation Resistance: more than 1000 megohms at 500V DC  
 Contact Resistance: 13 milliohm max.  
 Dielectric Strength: 1000V for 1 minute  
 Operating Temperature: -55°C to +105°C  
 Durability Rating: 500 mating cycles min.

**Ordering Information**

Part Number	Contact Area Plating Finish
K22-E9P-N	Gold Flash (standard)
K22-E9P-N15	15u" Gold (15 option)
K22-E9P-N30	30u" Gold (30 option)

1 Datecode information printed on all parts on top of plastic housing

2 Kycon name and logo molded into back plastic cover on all parts

CSA NRTL/C Certified File No. LR78160  
 UL Recognized File No. E140125

Tolerances
X.X ± 0.25
X.XX ± 0.15
Unless Stated Otherwise

REVISION	DATE	DESCRIPTION	DRAWN BY	REV CHECK BY	UNITS
A	10/19/98	New Drawing	C. Leiva	C. Furumasu	MM
A1	1/19/04	ECD #04-006	REVISED BY	REV CHECK DATE	DATE
A2	2/5/04	ECD #04-019	C. Leiva	2/5/04	10/19/98

K22-E9P-N

9 POS. RT. ANG D-SUB, MALE

0.318" FOOTPRINT, BOARDLOCKS

