

# EAO – Your Expert Partner for Human Machine Interfaces

## K14-271.122101 - Illuminated pushbutton

### K14-271.122101 - Illuminated pushbutton



*Attention: The preview is based on a sample product. This can differ from your current configuration.*

#### Mounting

Mounting cut-out Ø 22,3 mm  
Design raised

#### Front

Front dimension Ø 29 mm  
Front shape round

#### Other Attributes

Weight 0.021 kg  
Operation current 2.5/5 mA ±15 %  
Operating voltage 24 V AC/DC

#### Operating-/Indication part

Lens illumination illuminative  
Lens material Plastic  
Lens optics transparent  
Lens profile flush  
Lens colour red

#### IP-Rating

Front protection IP67

#### Connection Method

Terminal Soldering terminal

#### Actuator

Switching action Maintained  
Housing colour black  
Housing material Plastic

#### Switching element

Switching system Snap-action switching element  
Switching current 5 A  
Contacts 1 NC + 1 NO  
Switching voltage 250 V AC/DC  
Contact material

#### Illumination

LED colour red

#### Function

Illuminated pushbutton

# EAO – Your Expert Partner for Human Machine Interfaces

K14-271.122101 - Illuminated pushbutton

## Dimensions

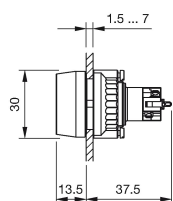

## Mounting cut-outs

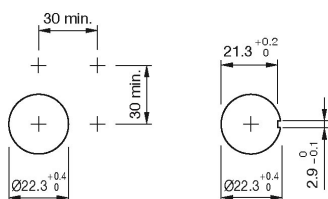

## Wiring diagram

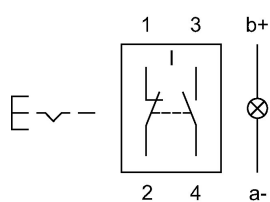

## Legend

Contacts: NC = Normally closed, NO = Normally open