

KEMET, GTX, EMI/RFI Filters, Noise Suppression, 250 VAC, 560 VDC, 10 A, 75x44x25mm

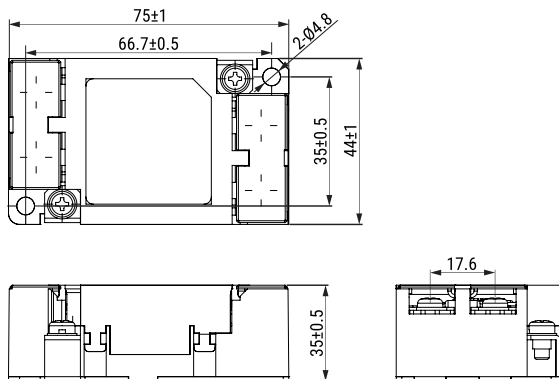

### Dimensions

|           |                 |
|-----------|-----------------|
| <b>L</b>  | 75mm +/-1mm     |
| <b>W</b>  | 44mm +/-1mm     |
| <b>H</b>  | 25mm +/-1mm     |
| <b>S</b>  | 17.6mm NOM      |
| <b>L1</b> | 66.7mm +/-0.5mm |
| <b>W1</b> | 35mm +/-0.5mm   |

### Packaging Specifications

|                            |       |
|----------------------------|-------|
| <b>Packaging Quantity:</b> | 30    |
| <b>Component Weight:</b>   | 126 g |

### General Information

|                              |                                 |
|------------------------------|---------------------------------|
| <b>Series:</b>               | GTX                             |
| <b>Style:</b>                | Plastic Box                     |
| <b>Description:</b>          | EMI Filter, With Y Capacitor    |
| <b>Phase:</b>                | Single-phase                    |
| <b>RoHS:</b>                 | With Exemptions                 |
| <b>Qualifications:</b>       | UL, cUL, TUV                    |
| <b>Tightening Torque:</b>    | 1.2 ~ 1.4N-m (Recommended)      |
| <b>Line Terminal:</b>        | 14-4(JST)                       |
| <b>Line Terminal Width:</b>  | 12 Max.                         |
| <b>Earth Terminal:</b>       | R5.5-4(JST)                     |
| <b>Earth Terminal Width:</b> | 9.5 Max.                        |
| <b>Miscellaneous:</b>        | 60 K Self-Temperature Rise Max. |
| <b>Terminal Type:</b>        | Screw                           |

### Specifications

|                           |              |
|---------------------------|--------------|
| <b>Voltage AC:</b>        | 250 VAC      |
| <b>Voltage DC:</b>        | 560 VDC      |
| <b>Rated Current:</b>     | 10 A         |
| <b>Temperature Range:</b> | -25/+55°C    |
| <b>Leakage Current:</b>   | 4.6 mA (MAX) |