

KEMET, GTX, EMI/RFI Filters, Noise Suppression, 250 VAC, 560 VDC, 10 A, 75x44x25mm

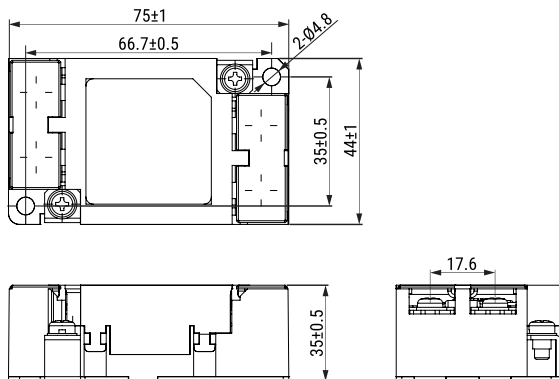

Dimensions

| | |
|-----------|-----------------|
| L | 75mm +/-1mm |
| W | 44mm +/-1mm |
| H | 25mm +/-1mm |
| S | 17.6mm NOM |
| L1 | 66.7mm +/-0.5mm |
| W1 | 35mm +/-0.5mm |

Packaging Specifications

| | |
|----------------------------|-------|
| Packaging Quantity: | 30 |
| Component Weight: | 121 g |

General Information

| | |
|------------------------------|---------------------------------|
| Series: | GTX |
| Style: | Plastic Box |
| Description: | EMI Filter, With Y Capacitor |
| Phase: | Single-phase |
| RoHS: | With Exemptions |
| Qualifications: | UL, cUL, TUV |
| Tightening Torque: | 1.2 ~ 1.4N-m (Recommended) |
| Line Terminal: | 14-4(JST) |
| Line Terminal Width: | 12 Max. |
| Earth Terminal: | R5.5-4(JST) |
| Earth Terminal Width: | 9.5 Max. |
| Miscellaneous: | 60 K Self-Temperature Rise Max. |
| Terminal Type: | Screw |

Specifications

| | |
|---------------------------|---------------|
| Voltage AC: | 250 VAC |
| Voltage DC: | 560 VDC |
| Rated Current: | 10 A |
| Temperature Range: | -25/+55°C |
| Leakage Current: | 0.01 mA (MAX) |