



Grid-Store Wall Mounted Systems

Grid-Store System provides a strong, versatile solution for organization and storage of small, medium and large supplies. A wide selection of accessories allow for easy storage of items ranging from catheters to crutches. Heavy-duty wall brackets firmly secure panels to walls or any flat surface. Heavy gauge wire grid (1/4" rod) construction allows for secure storage as well as visibility and dust and dirt free storage. Durable white gloss finish. Grid hooks and accessories are fabricated using 1/4" diameter wire, allowing heavy-duty application storage.

**GRID-STORE HOOKS**

Each hook is a full 1/4" in diameter and ideal for hanging prepackaged items. Available in 3 lengths.

**GRID-STORE HOOK TUBE WITH 5 HOOKS**

16" Rectangular tubing with 5 hooks.

**GRID-STORE SLANTED SHELF**

Slanted shelf allows you to display products higher up yet still easy to see. Measures 15-1/4" L x 22-3/8" W.

**GRID-STORE BASKETS**

12" L x 12" W x 8" H baskets, one also available with a 4" front lip allowing easy access to items stored.

MODEL NO.	DESCRIPTION	CTN QTY	CTN WGT
<b>Grid Panels</b>			
A GSP-2448	24" x 48" Grid-Store Panel	1	12 lbs
GSP-2460	24" x 60" Grid-Store Panel	1	15 lbs
GSP-2472	24" x 72" Grid-Store Panel	1	17 lbs
<b>Grid Panels Accessories</b>			
B GSP-HOOK6	6" Grid-Store Hook	1	1 lb
GSP-HOOK8	8" Grid-Store Hook	1	1 lb
GSP-HOOK10	10" Grid-Store Hook	1	1 lb
C GSP-B12128	12" x 12" x 8" Grid-Store Basket	1	3 lbs
D GSP-5HOOK-16	16" Rectangular Tube w/ 5 Hooks	1	2 lbs
E GSP-WMHD	Heavy-Duty Wall Mounting Bracket	1	1 lb
F GSP-SB12128	12" x 12" x 8" Slanted Grid-Store Basket	1	2 lbs
G GSP-SS2215	22-3/8" x 15-1/4" Slanted Shelf	1	4 lbs

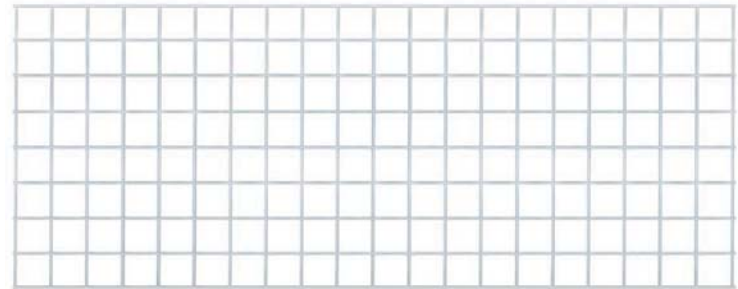
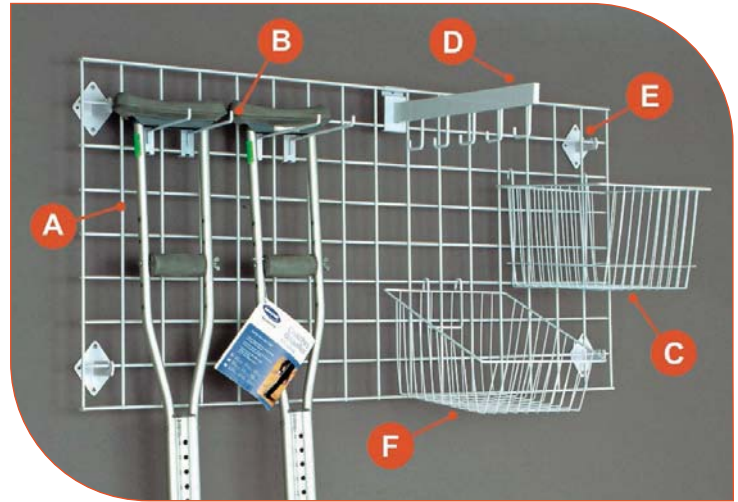

A GSP-2448

Accessories



B GSP-Hooks 6", 8" and 10"



C GSP-B12128



D GSP-5HOOK-16



E GSP-WMHD



F GSP-SB12128

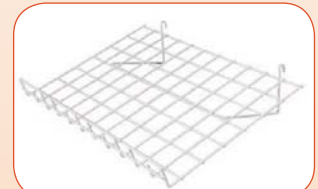

G GSP-SS2215

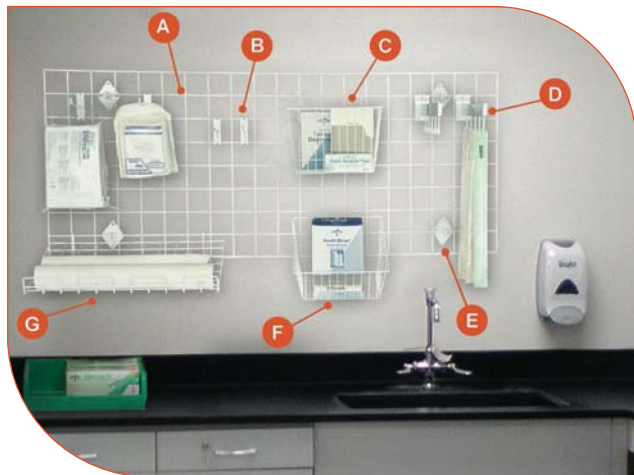

**STRONG & VERSATILE SOLUTION FOR SMALL, MEDIUM AND LARGE SUPPLIES**