

# MULTIPLE OUTPUT PROGRAMMABLE LINEAR D.C. POWER SUPPLY

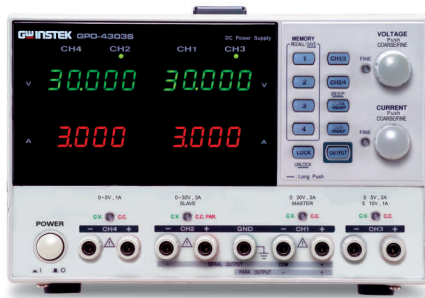

The GPD-Series contain the superior technology and high quality which GW Instek had established through its long history of power supply design and manufacturing. The GPD-Series offers digital panel control, large display, bright LED indicators, high output resolution, 4 sets of setup memory, USB remote control and smart cooling fan control. Additionally, the GPD-Series provide easy operation, a wide selection of panel settings and the most important for a reasonable price. All these features make the GPD-Series the most promising new comer in the power supply market.

## High Resolution

With 1mV/1mA (for GPD-2303S/3303S/4303S) high resolution and coarse/fine volume control the GPD-Series, guarantees clean and stable output. Using the GPD-Series you can easily simulate the device under test's accurate behavior against small changes in voltage or current, which is impossible when using a low resolution power supply.

## Tracking Series and Parallel Function

Tracking series and parallel function allows you to use the GPD-Series in wide range of applications. The tracking series mode guarantees higher output voltage, while the tracking parallel mode guarantees higher output current.

## Convenience Functions

The knobs are digitally controlled, allowing fine or coarse volume setting. The key lock feature locks panel operations, preventing accidental change of the settings which might lead damaging for the equipments.

## 4 Sets of Save / Recall

The GPD-Series can save and recall panel settings, these feature which can not offered by general power supplies. You can quickly select a panel setting from four memory sets without manual configuration.

## USB Remote Control

The USB device port in the GPD-Series allows you to remotely control the power supply according to your application needs.

## GPD-2303S/3303S/4303S GPD-3303D

### FEATURES

- 2,3,and 4 Independent Isolated Output
- 4 LED Display Sets : 3 Digits After Decimal Point (GPD-2303S/3303S/4303S)
- Minimum Resolution :  
GPD-2303S/3303S/4303S (1mV/1mA)  
GPD-3303D (100mV/10mA)
- Digital Panel Control (Rotary Encoder Switch, Rubber Key With Indicator)
- User-Friendly Operation, Coarse / Fine Volume Control
- 4 Sets Save / Recall
- Key-Lock
- Output ON/OFF
- Tracking Series and Parallel Mode
- Smart Cooling Fan Achieving Low Noise
- Compact Design
- PC Software & USB Driver
- USB Standard Interface

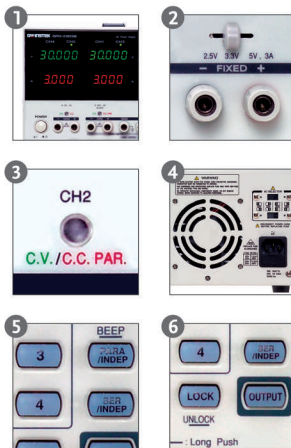

## FUNCTION FEATURES

1. Bright LED display shows settings or actual level of output
2. The independent CH3 output offers three commonly used voltage settings (GPD-3303S/3303D only)
3. C.V./C.C. modes are clearly indicated in different colors
4. Smart cooling fan control offers a well-balanced cooling mechanism, ensuring quiet operation
5. The tracking series and parallel mode can be selected with a single touch
6. Indicators embedded in the keys provide an instant view of the power supply status; the Key Lock feature prevents improper operation

### APPLICATIONS

- Laboratories and Educational Facilities
- Product Testing and Quality Assurance
- Service Operation and Post-Sales Support
- Product Development and Debugging

## SPECIFICATIONS

OUTPUT	Channel Voltage Current	GPD-2303S		GPD-3303S			GPD-4303S				GPD-3303D		
		CH1	CH2	CH1	CH2	CH3	CH1	CH2	CH3	CH4	CH1	CH2	CH3
		0~30V 0~3A	0~30V 0~3A	0~30V 0~3A	0~30V 0~3A	2.5/3.3/5.0V 0~3A	0~30V 0~3A	0~30V 0~3A	0~5V or 5.001V~10V 0~3A or 0~1A	0~5V 0~1A	0~30V 0~3A	0~30V 0~3A	2.5/3.3/5.0V 0~3A
CONSTANT VOLTAGE OPERATION	Regulation	Line regulation $\leq 0.01\%+3mV$ Load regulation $\leq 0.01\%+3mV$ (rating current $\leq 3A$ ) $\leq 0.02\%+5mV$ (rating current $>3A$ )											
	Ripple & Noise Recovery Time Temp.Coefficient Output Range	$\leq 1mV_{rms}$ (5Hz~1MHz) $\leq 100 \mu S$ (50%Load change, Minimum load 0.5A) $\leq 300ppm / ^\circ C$ 0 to rating voltage continuously adjustable											
CONSTANT CURRENT OPERATION	Regulation	Line regulation $\leq 0.2\%+3mA$ Load regulation $\leq 0.2\%+3mA$											
	Ripple Current Output Range	$\leq 3mA_{rms}$ 0 to rating current continuously adjustable											
TRACKING OPERATION	Regulation of PAR.	Line regulation $\leq 0.01\%+3mV$ Load regulation $\leq 0.01\%+3mV$ (rating current $\leq 3A$ ) $\leq 0.02\%+5mV$ (rating current $>3A$ )											
	Regulation of SER.	Line regulation $\leq 0.01\%+5mV$ Load regulation $\leq 300mV$ Tracking error $\leq 0.5\%\pm 10mV$ (10 ~ 30V no load) with load added $\leq 300mV$ $\leq 0.5\%\pm 30mV$ (0 ~ 9.99V no load) with load added $\leq 300mV$											
	Tracking error	$\leq 0.5\% + 10mV$								$\leq 0.5\% + 50mV$			
METER	Display	Voltage : 4 3/4 digits 0.4" LED Display Current : 3 3/4 digits 0.4" LED Display								Voltage:2 3/4 digits 0.4" LED Display Current:2 3/4 digits 0.4" LED Display			
	Resolution	Voltage : 1mV Current : 1mA								Voltage:100mV Current:10mA			
	Program Accuracy(25 $\pm$ 5 $^\circ$ C)	Voltage : $\pm(0.03\%$ of RDG +10 digits) Current : $\pm(0.3\%$ of RDG +10 digits)								Voltage: $\pm(0.5\%$ of RDG+2 digits) Current: $\pm(0.5\%$ of RDG+2 digits)			
	Readback Accuracy(25 $\pm$ 5 $^\circ$ C)	Voltage : $\pm(0.03\%$ of RDG +10 digits) Current : $\pm(0.3\%$ of RDG +10 digits)								Voltage: $\pm(0.5\%$ of RDG+2 digits) Current: $\pm(0.5\%$ of RDG+2 digits)			
CH3 SPECIFICATIONS	Output Voltage Output Current Regulation(25 $\pm$ 5 $^\circ$ C )	-		( 2.5V/3.3V/5V ) $\pm 8\%$ 3A Line regulation $\leq 0.01\%+3mV$ Load regulation $\leq 0.01\%+3mV$			0~5V / 5~10V 0~3A / 0~1A Line regulation $\leq 0.01\%+3mV$ Load regulation $\leq 0.01\%+3mV$		( 2.5V/3.3V/5V ) $\pm 8\%$ 3A Line regulation $\leq 0.01\%+3mV$ Load regulation $\leq 0.01\%+3mV$				
	Repple & Noise	$\leq 1mV_{rms}$ (5Hz~1MHz)			$\leq 2mV_{rms}$ (5Hz~1MHz)				$\leq 1mV_{rms}$ (5Hz~1MHz)				
KEY LOCK	Yes												
MEMERY SAVE/RECALL	4 sets												
POWER SOURCE	AC100V/120V/220V/230V $\pm 10\%$ , 50/60Hz												
DIMENSION & WEIGHT	210(W) x 130 (H) x 265(D) mm ; Approx. 7kg												

Specifications subject to change without notice. PD-0000DGD1DH

### ORDERING INFORMATION

<b>GPD-2303S</b>	GPD-2303S 2 Channels, 180W Programmable Linear DC Power Supply
<b>GPD-3303S</b>	GPD-3303S 3 Channels, 195W Programmable Linear DC Power Supply
<b>GPD-4303S</b>	GPD-4303S 4 Channels, 195W Programmable Linear DC Power Supply
<b>GPD-3303D</b>	GPD-3303D 3 Channels, 195W Programmable Linear DC Power Supply

### ACCESSORIES

User Manual x 1 , Power cord x 1	
<b>GPD-2303S</b>	Test Lead GTL-104Ax2;European Test Lead GTL-204Ax2, GTL-201Ax1
<b>GPD-3303S</b>	Test Lead GTL-104Ax2,GTL-105Ax1;European Test Lead GTL-203Ax1,GTL-204Ax2,GTL-201Ax1
<b>GPD-4303S</b>	Test Lead GTL-104Ax2,GTL-105Ax2;European Test Lead GTL-203Ax2,GTL-204Ax2,GTL-201Ax1
<b>GPD-3303D</b>	Test Lead GTL-104Ax2,GTL-105Ax1;European Test Lead GTL-203Ax1,GTL-204Ax2,GTL-201Ax1

### OPTIONAL ACCESSORIES

<b>GTL-246</b>	USB Cable
----------------	-----------

Global Headquarters

#### GOOD WILL INSTRUMENT CO., LTD.

No.7-1, Jhongsing Road, Tucheng Dist., New Taipei City 236, Taiwan  
T +886-2-2268-0389 F +886-2-2268-0639  
E-mail: marketing@goodwill.com.tw

China Subsidiary

#### GOOD WILL INSTRUMENT (SUHZOU) CO., LTD.

NO. 69, Lushan Road, Snd, Suzhou Jiangsu 215101 China  
T +86-512-6661-7177 F +86-512-6661-7277  
E-mail: marketing@instek.com.cn

Malaysia Subsidiary

#### GOOD WILL INSTRUMENT (M) SDN. BHD.

27, Persiaran Mahsuri 1/1, Sunway Tunas,  
11900 Bayan Lepas, Penang, Malaysia  
T +604-6309988 F +604-6309989  
E-mail: sales@goodwill.com.my

U.S.A. Subsidiary

#### INSTEK AMERICA CORP.

3661 Walnut Avenue Chino, CA 91710, U.S.A.  
T +1-909-5918358 F +1-909-5912280  
E-mail: sales@instekamerica.com

Japan Subsidiary

#### INSTEK JAPAN CORPORATION

4F, Prosper Bldg, 1-3-3 Iwamoto-Cho Chiyoda-Ku,  
Tokyo 101-0032 Japan  
T +81-3-5823-5656 F +81-3-5823-5655  
E-mail: info@instek.co.jp

Korea Subsidiary

#### GOOD WILL INSTRUMENT KOREA CO., LTD.

Room No.805, Ace Hightech-City B/D 1 Dong,  
Mullae-Dong 3Ga 55-20, Yeongduengpo-Gu, Seoul, Korea  
T +82-2-3439-2205 F +82-2-3439-2207  
E-mail : gwinstek@gwinstek.co.kr

# GW INSTEK

Simply Reliable

www.gwinstek.com