

Cable gland - G-INS-PG7-M68N-PNES-BK - 1424495

Please be informed that the data shown in this PDF Document is generated from our Online Catalog. Please find the complete data in the user's documentation. Our General Terms of Use for Downloads are valid (<http://phoenixcontact.com/download>)



Cable gland, Cable gland material: PA, External cable diameter 3 mm ... 6.5 mm, Shielding: No, Connecting thread: Pg7, Color: jet black RAL 9005



Key Commercial Data

Packing unit	1
GTIN	 4 055626 373256
GTIN	4055626373256
Custom tariff number	39269097

Technical data

Dimensions

Length	32 mm
Wrench size, union nut	15 mm
Wrench size, support	15 mm
Hexagon angular dimension	17.1 mm
Length of the connecting thread	8 mm
Feed-through hole diameter	12.6 mm ... 12.7 mm
External cable diameter	3 mm ... 6.5 mm
	4 mm ... 6 mm (for UL 514 B)

Ambient conditions

Degree of protection	IP68 (5 bar / 0.5 h)
Ambient temperature (operation)	-20 °C ... 100 °C (static)

General

Cable gland - G-INS-PG7-M68N-PNES-BK - 1424495

Technical data

General

No. of conductors	1
Cable gland material	PA
Cable seal material	Neoprene
Shielded	No
Thread type on connection side	Pg7
Torque	1.5 Nm (Union nut)
	1.5 Nm (Support)
	2 Nm (for UL514 B: union nut / support)
Flammability rating according to UL 94	V2
	V2 (Housing)
Color	jet black RAL 9005
Assembly instructions	1) Mount screw connection support in the housing using the correct torque 2) Insert cable 3) Tighten union nut using the correct torque
Manufacturer	BIMED
Manufacturer Designation	BS-21

Standards and Regulations

Flammability rating according to UL 94	V2
--	----

Drawings

Dimensional drawing

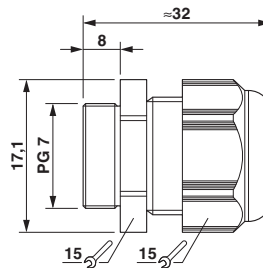

Dimensional drawing

Approvals

Approvals

Approvals

UL Recognized / EAC

Cable gland - G-INS-PG7-M68N-PNES-BK - 1424495

Approvals

Ex Approvals

Approval details

UL Recognized		http://database.ul.com/cgi-bin/XYV/template/LISEXT/1FRAME/index.htm	E199260
---------------	---	---	---------

EAC			EAC-Zulassung
-----	---	--	---------------
