

TECHNICAL DATA:

Configuration

| | |
|-------------------------|---|
| Dome nut | Polyamide PA6 |
| Dust cap | Polyethylene PE-LD, colours *white or **green |
| Sealing ring/outer part | Silicone rubber VMQ |
| Sealing ring/inner part | TPE TPS (from M16x1,5) |
| Gland body | Polyamide PA6 |
| Connecting thread | metric, as per EN 60423 |

Properties

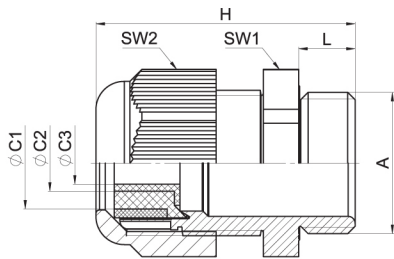

- wide sealing and clamping range
- easy-to-install

| | | |
|---------------------|---|----------------|
| Group (Zone) | II 2 G (1,2) | II 2 D (21,22) |
| Marking | Ex e IIC Gb | Ex tb IIC Db |
| Cable installation | fixed | |
| Temperature range | see table Characteristics, assigned to Part. No. | |
| Protection grade | IP66 | |
| Test standard | EN 60079-0:2012, IEC 60079-0:2011 EN 60079-7:2007, IEC 60079-7:2006 EN 60079-31:2009, IEC 60079-31:2008 | |
| EC-Type certificate | PTB 99 ATEX 3101 X (M12x1,5 - M16x1,5) PTB 99 ATEX 3128 X (M20x1,5 - M63x1,5) PTB 14 ATEX 1015 X | |
| IECEX Certificate | IECEX PTB 05.0004X, IECEX PTB 14.0027X | |





Characteristics

Connecting thread standard length

| A | ØC3 mm | ØC2 mm | ØC1 mm | $\frac{E}{mm}$ L | SW1 mm | SW2 mm | H mm |  | Part No. -20 °C / +70 °C [*] | Part No. -40 °C / +70 °C [**] |  RAL 9005 jet black Part No. -55 °C / +70 °C [**] |
|---------|-----------|-----------|-----------------------|---------------------|-----------|-----------|---------|---|---------------------------------|----------------------------------|---|
| M12x1,5 | | | 5 - 7 | 8 | 15 | 15 | 31 | 20 | GHG9601955R0001 | | |
| M16x1,5 | | 5,5 - 7 | 7 - 10 | 8 | 20 | 20 | 35,5 | 20 | GHG9601955R0002 | | |
| M20x1,5 | 5,5 - 7 | 7 - 9 | 9,5 - 13 | 8 | 24 | 24 | 37 | 20 | GHG9601955R0003 | | |
| M20x1,5 | 5,5 - 7 | 7 - 9 | 9,5 - 11 | 8 | 24 | 24 | 37 | 20 | | GHG9601955R0010 | |
| M25x1,5 | 8 - 10 | 10 - 13 | 13,5 - 17,5 | 8 | 29 | 29 | 43 | 20 | GHG9601955R0004 | | |
| M25x1,5 | 8 - 10 | 10 - 13 | 13,5 - 15 | 8 | 29 | 29 | 43 | 20 | | | GHG9601955R0009 |
| M32x1,5 | | 14 - 17 | 17,5 - 21 | 10 | 36 | 36 | 50 | 20 | GHG9601955R0005 | | GHG9601955R0011 |
| M40x1,5 | | 19 - 22 | 22 - 28 | 10 | 46 | 46 | 51 | 10 | | | GHG9601955R0006 |
| M50x1,5 | | 24 - 28 | 28 - 35 | 12 | 55 | 55 | 61,5 | 10 | | | GHG9601955R0007 |
| M63x1,5 | | 29 - 35 | 36 - 48 ¹⁾ | 12 | 68 | 68 | 65,5 | 5 | | | GHG9601955R0008 |

Connecting thread long

| A | ØC3 mm | ØC2 mm | ØC1 mm | $\frac{E}{mm}$ L | SW1 mm | SW2 mm | H mm |  | Part No. -20 °C / +70 °C [*] | Part No. -40 °C / +70 °C [**] |  RAL 9005 jet black Part No. -55 °C / +70 °C [**] |
|---------|-----------|-----------|-----------------------|---------------------|-----------|-----------|---------|---|---------------------------------|----------------------------------|---|
| M12x1,5 | | | 5 - 7 | 12 | 15 | 15 | 35 | 20 | GHG9601955R0021 | | |
| M16x1,5 | | 5,5 - 7 | 7 - 10 | 12 | 20 | 20 | 39,5 | 20 | GHG9601955R0022 | | |
| M20x1,5 | 5,5 - 7 | 7 - 9 | 9,5 - 13 | 13 | 24 | 24 | 42 | 20 | GHG9601955R0023 | | |
| M20x1,5 | 5,5 - 7 | 7 - 9 | 9,5 - 11 | 13 | 24 | 24 | 42 | 20 | | GHG9601955R0029 | |
| M25x1,5 | 8 - 10 | 10 - 13 | 13,5 - 17,5 | 13 | 29 | 29 | 48 | 20 | GHG9601955R0024 | | |
| M25x1,5 | 8 - 10 | 10 - 13 | 13,5 - 15 | 13 | 29 | 29 | 48 | 20 | | | GHG9601955R0030 |
| M32x1,5 | | 14 - 17 | 17,5 - 21 | 15 | 36 | 36 | 55 | 20 | GHG9601955R0025 | | GHG9601955R0031 |
| M40x1,5 | | 19 - 22 | 22 - 28 | 15 | 46 | 46 | 56 | 10 | | | GHG9601955R0026 |
| M50x1,5 | | 24 - 28 | 28 - 35 | 16 | 55 | 55 | 66,5 | 10 | | | GHG9601955R0027 |
| M63x1,5 | | 29 - 35 | 36 - 48 ¹⁾ | 16 | 68 | 68 | 69,5 | 5 | | | GHG9601955R0028 |

¹⁾ M63x1,5 with additional sealing