

### Compact power entry module

- up to 10A current ratings
- IEC 950-compliant
- optional medical version (B type)
- snap-in version (S type)
- Nennstrom bis 10A
- IEC 950 konform
- Für medizinische Geräte als Option (Typ B)
- Snap-in Version (Typ S)
- courant nominal jusqu'à 10A
- conforme à CEI 950
- version médicale en option (type B)
- version snap-in (type S)



#### Filter selection table

Choose the family FN xxx with the required body style and features, and add -?? to determine current rating, and /?? for output connections. Example: FN 9224-1/07 is a horizontal screw-mounting filter, rated for 1A, with wire outputs.

#### Approvals



Family	Current ratings A at 40°C (25°)				Output connection	Housing	
	1 (1.2)	3 (3.5)	6 (6.9)	10 (11.6)			
FN 9224 -?? /??	-1	-3	-6	-10	/07	✓	-
FN 9224S -?? /??	-1	-3	-6	-10	/07	-	✓
Inductance L mH							
	4.7	1.24	0.52	0.13			

#### Additional specifications

Filter type	Capacitance		Maximum leakage µA/phase	Res. R MΩ	Weight g	Maximum operating volt.		Operating frequency Hz	Hipot test voltage	
	Cx nF	Cy nF				VAC	Hz		PN→E VAC	P→N VAC
All standard types	100	2.2	190	1	44	250	50/60	DC to 400	2000	760
B types (medical)	100	-	2	1	44	250	50/60	DC to 400	2500	760

MTBF at 40°C, 230V, per Mil-HB-217F: 2,200,000 hours

#### Electrical schematics

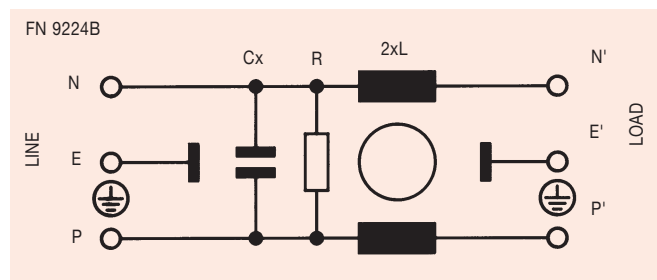
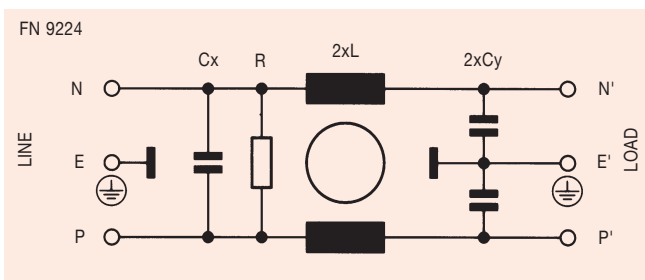

See tables for component values

## FN 9224 insertion loss

Per CISPR 17; A = 50Ω/50Ω sym, B = 50Ω/50Ω asym, C = 0.1Ω/100Ω sym, D = 100Ω/0.1Ω sym

### 1 amp types

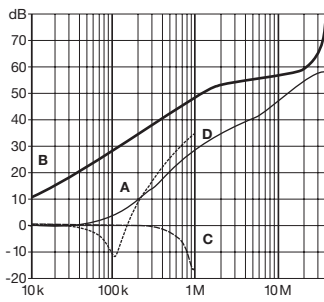

### 3 amp types

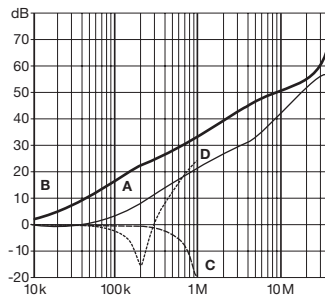

### 6 amp types

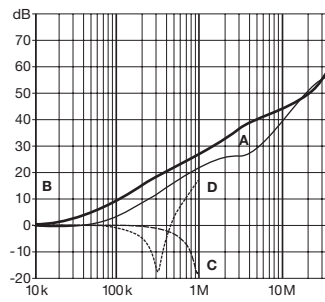

### 10 amp types

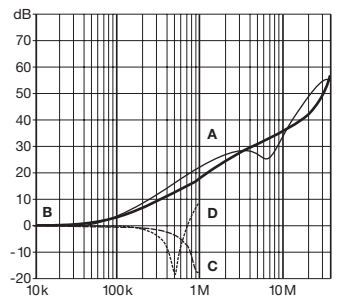

## Mechanical data

### FN 9224

		Tol. mm
<b>A</b>	48	± 0.5
<b>B</b>	22.5	± 0.3
<b>C</b>	40	± 0.2
<b>D</b>	37.7	± 0.3
<b>F</b>	5.5	± 0.3
<b>H</b>	Ø3.3	-
<b>J</b>	10.9	± 0.3
<b>M</b>	R≤3	-
<b>N</b>	21.5	± 0.2
<b>P</b>	28.5	± 0.2
<b>R</b>	M3	-
<b>S</b>	90°	-
<b>Y</b>	AWG 18	-
<b>Z</b>	160	± 5

### FRONT

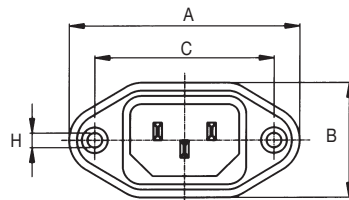

### SIDE

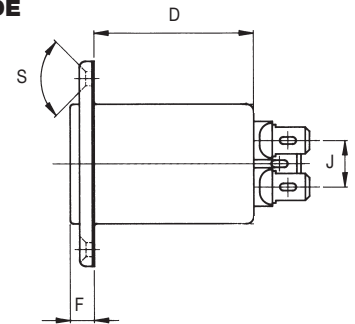

### PANEL CUT-OUT

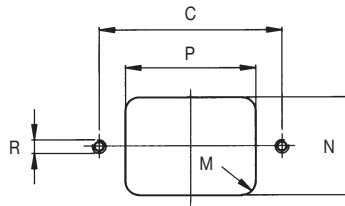

### FN 9224S

		Tol. mm
<b>A</b>	34	± 0.5
<b>B</b>	22.5	± 0.3
<b>C</b>	27.5	± 0.3
<b>D</b>	37.7	± 0.3
<b>F</b>	5.5	± 0.3
<b>M</b>	R≤1.5	-
<b>N</b>	20.8	+0.1 0
<b>P</b>	30.8	+0.1 0
<b>T</b>	panel thickness 0.5-2mm	-
<b>W</b>	6	± 1
<b>Y</b>	AWG 18	-
<b>Z</b>	160	± 5

### Snap-in version FN 9224S

(Possible thickness of mounting panels see page 100)

### FRONT

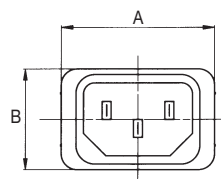

### SIDE

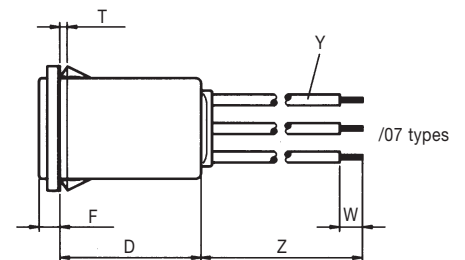

### PANEL CUT-OUT

