



SERIES 280HTS CARD LOK

RECOMMENDED GAP WIDTH

PCB + 10.29 mm (.405 in)

RECOMMENDED TORQUE

113 N-cm (10 in-lbs)

WEIGHT

2.50 g/cm (.224 oz/in)

MATERIALS AND FINISH

BRACKETS AND FRONT WEDGE

Material: 6061-T6 or T6XXX per ASTM-B221 or AMS- QQ-A-A-200/8

Finish: See finish table on opposite page

SCREW AND WASHER

Material: Stainless steel

Finish: Passivated per AMS2700

THREADED INSERT

Material: Stainless steel

Finish: Passivated per AMS2700

PIN

Material: Stainless steel

Finish: Passivated per AMS2700

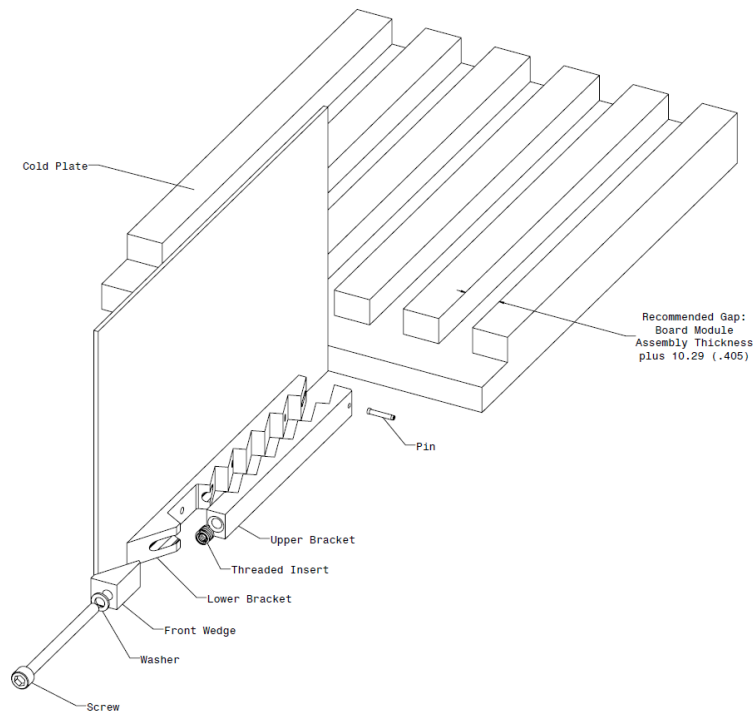

SERIES 280HTS CARD LOK

OPTIONS

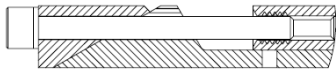

DETAIL "K" (RELAXED VIEW)

Detail "K"
Prevents the unintentional
disassembly of screw from shaft.

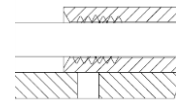

Detail "L" SCREW LOCKING INSERT
Provides prevailing torque for
resistance to loosening from shock
and vibration. Meets NASM 8846.

3.57 (9/64) PER ANSI/ASME B18.3
(M OPTION 3 MM PER ANSI/ASME B18.3M)

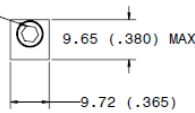

RELAXED STATE

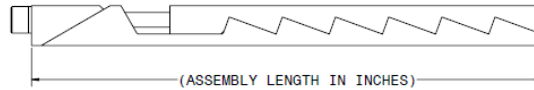

EXPANDED STATE

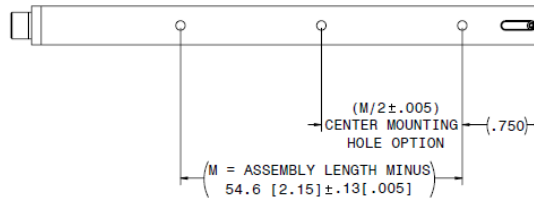
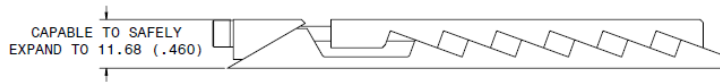

Units: mm(in)
Unless specified other
.XX=±.25, .X=±.5
(.XXX=±.010, .XX=±.02)

Part Number Code	M	A	280HTS -	3.30	E	T4	L	K
Screw Drive								
Metric Screw Head M3 Hex Drive _____		M						
Standard Screw Head 9/64 Hex Drive __ [Blank]		[Blank]						
Surface Finish								
Black Anodized _____		A						
Electroless Nickel _____		EN						
Length								
Length in 12.7 (.50 increments) _____			83.82	[3.30]				
_____ to _____			325.12	[12.80]				
Mounting								
Additional Center Mounting Hole _____						E		
None _____						[Blank]		
Mounting Options- mounting holes _____						T4		
Or choose from Mounting Method Table								
Threaded Insert								
Screw-Locking Insert _____							L	
Free-Running Insert _____							[Blank]	
Screw Type								
Captive Screw _____								K
Standard _____								[Blank]

Part Number Code Example: M A 280HTS – 4.80 E TM3 L K
Series 280HTS Card-Lok with M3 hex drive, black anodized finish, 121.9 (4.80) long, with additional mounting hole, M3X0.50 tapped hole, locking insert and captive screw

FINISH TABLE

CODE LETTER	SURFACE FINISH
A	BLACK ANODIZE PER MIL-A-8625 TYPE II, CLASS 2
EN	ELECTROLESS NICKEL PER MIL-C-26074 CLASS 4, GRADE B, BRIGHT

MOUNTING METHOD TABLE

CODE LETTER	METHOD
"T4"	4-40 TAPPED HOLE
"TM3"	M3 x 0.50 TAPPED HOLE

