



These non-insulated ring terminals are made of electrolytic copper for high conductivity. They can be installed with crimping tools having a single indenter or double indenter (recommended for solid wire). Serrated barrel increases grip on wire. Wire range identification is stamped on the tongue of each terminal.

Stock Thickness:

D & E = .06

F = .07

D10, E10, F10 = .04

D975 & F975 = .04

Non-Insulated Ring – Brazed Seam

Cat. No.	Pkg. Qty.	Wire Range	Bolt Hole	Wt./Lbs. Per 1000	Dimensions			
					A	B	C	M
D8-10*	25	8	#10	16	1.13	.48	.36	.90
D36*	200	8	#10	16	1.13	.48	.36	.90
D8-14*	25	8	1/4"	14	1.13	.48	.36	.90
D71*	200	8	1/4"	14	1.13	.48	.36	.90
D8-516*	25	8	5/16"	16	1.32	.59	.49	1.03
D72*	200	8	5/16"	16	1.32	.59	.49	1.03
D8-38*	25	8	3/8"	14	1.32	.59	.49	1.03
D73*	200	8	3/8"	14	1.32	.59	.49	1.03
D8-12*	25	8	1/2"	14	1.49	.82	.55	1.09
D75*	200	8	1/2"	14	1.49	.82	.55	1.09
E6-10*	20	6	#10	17	1.13	.48	.36	.90
E26*	200	6	#10	17	1.13	.48	.36	.90
E6-14*	20	6	1/4"	20	1.13	.48	.36	.90
E71*	200	6	1/4"	20	1.13	.48	.36	.90
E6-516*	20	6	5/16"	20	1.32	.60	.49	1.03
E72*	200	6	5/16"	20	1.32	.60	.49	1.03
E6-38*	20	6	3/8"	20	1.32	.60	.49	1.03
E73*	200	6	3/8"	20	1.32	.60	.49	1.03
E6-12*	20	6	1/2"	20	1.49	.82	.55	1.08
E75*	200	6	1/2"	20	1.49	.82	.55	1.08
F4-10*	20	4	#10	24	1.16	.48	.36	.93
F26*	200	4	#10	24	1.16	.48	.36	.93
F4-14*	20	4	1/4"	25	1.16	.48	.36	.93
F71*	200	4	1/4"	25	1.16	.48	.36	.93
F4-516*	20	4	5/16"	25	1.35	.60	.49	1.06
F72*	200	4	5/16"	25	1.35	.60	.49	1.06
F4-38*	20	4	3/8"	25	1.35	.60	.49	1.06
F73*	200	4	3/8"	25	1.35	.60	.49	1.06
F4-12*	20	4	1/2"	25	1.52	.82	.55	1.11
F75*	200	4	1/2"	25	1.52	.82	.55	1.11

Installing tools: ERG-2005 (D Series only), WT115A D, E, F and G, TBM6/TBM6S, WT3185

Installing dies: 11802 INDENTOR (D-E-F-G), D-11803-NEST, E-11805-NEST, F-11806-NEST (all ordered separately)

Not available on Mylar Tape.

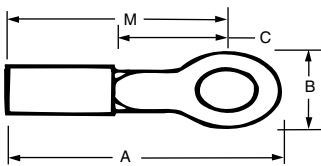

K

Sta-Kon®