

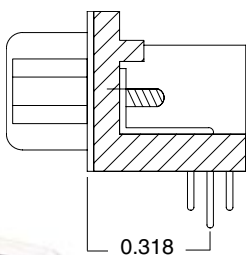

## D-SUB RIGHT ANGLE (.318")

- 4-40 Female Screwlock and Board Locks
- Gold Plated Contacts and Solder Post
- Plug with Grounding Indents on Shell
- Footprint = 0.318"



### Male

- DRB-09PR
- DRB-15PR
- DRB-23PR
- DRB-25PR
- DRB-37PR

### Female

- DRB-09SR
- DRB-15SR
- DRB-23SR
- DRB-25SR
- DRB-37SR
- DRB-50SR



## D-SUB RIGHT ANGLE (.318")

- 4-40 Threaded Insert and Board Locks
- Gold Plated Contacts and Solder Post
- Plug with Grounding Indents on Shell
- Footprint = 0.318"

### Male

- DRB-09PR-D
- DRB-15PR-D
- DRB-25PR-D

### Female

- DRB-09SR-D
- DRB-15SR-D
- DRB-25SR-D

- DRB-25SL-D

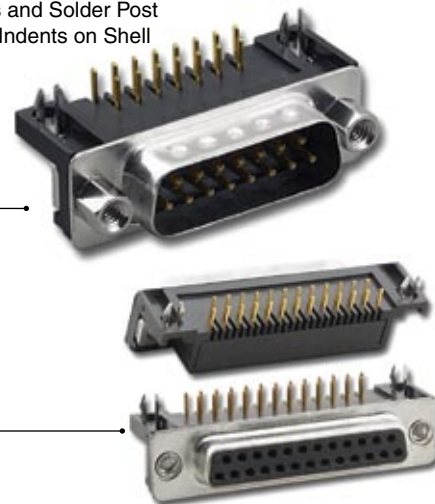

## D-SUB RIGHT ANGLE (.380")

- Gold Plated Contacts and Solder Post
- 4-40 Female Screwlock and Board Locks
- Plug with Grounding Indents on Shell
- Footprint = 0.380"

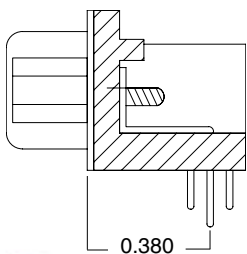

### Male

- DRB-09PM
- DRB-15PM
- DRB-25PM
- DRB-37PM

### Female

- DRB-09SM
- DRB-15SM
- DRB-25SM
- DRB-37SM

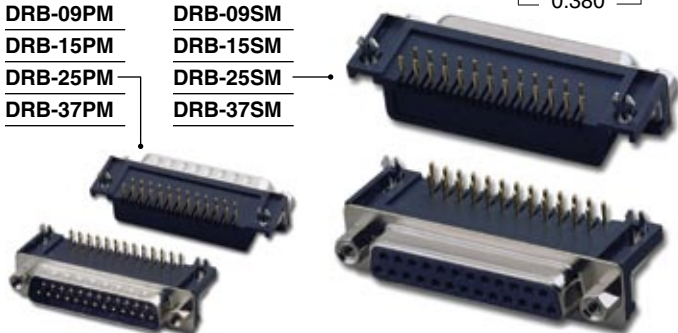

## HIGH DENSITY RIGHT ANGLE D-SUB

- Gold Plated Contacts and Solder Post
- 4-40 Female Screwlock and Board Locks
- Plug w/ Grounding Indents on Shell
- Footprint = 0.350"

### Male

- DHR-H15PR-D
- DHR-H26PR-D
- DHR-H44PR-D
- DHR-H62PR-D

### Female

- DHR-H15SR-D
- DHR-H26SR-D
- DHR-H44SR-D
- DHR-H62SR-D



## D-SUB RIGHT ANGLE (.590")

- Gold Plated Contacts and Solder Post
- 4-40 Female Screwlock and Board Locks
- Plug with Grounding Indents on Shell
- Foot Print = 0.590"

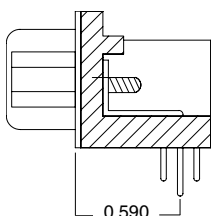

### Male

- DRB-09PL
- DRB-15PL
- DRB-25PL
- DRB-37PL

### Female

- DRB-09SL
- DRB-15SL
- DRB-25SL
- DRB-37SL



- 4-40 Threaded Insert

### Female

- DHR-H15SR
- DHR-H26SR
- DHR-H44SR
- DHR-H62SR

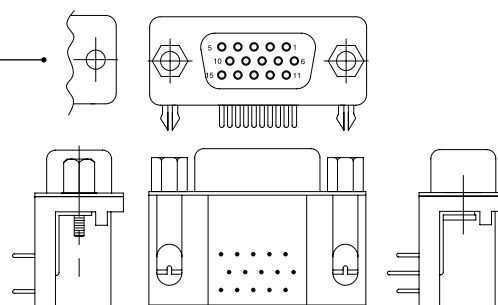

\* 4-40 Threaded Insert Option Available