

IC Sockets

Modular Single Row Male & Female

- ❖ Connectors can be cut to smaller sizes.
- ❖ Socket accepts mating pin $\varnothing 0.40$ to 0.56mm , using four finger Beryllium Copper Contact technology (see the Datamate range for more detail).
- ❖ Please consult drawings for specification.

MALE

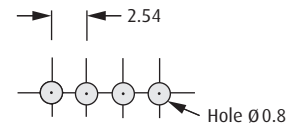
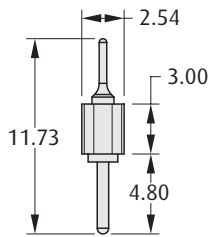
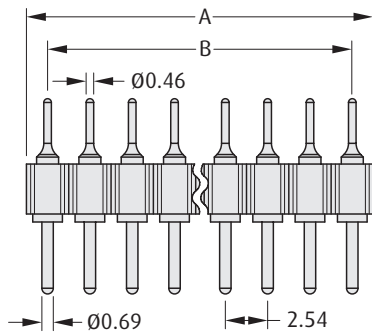

Recommended PC Board Pattern

CALCULATION

A	$2.54 \times \text{No. of ways per row}$
B	$2.54 \times (\text{No. of ways per row} - 1)$

FEMALE

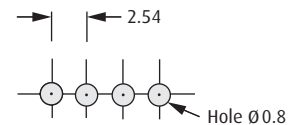
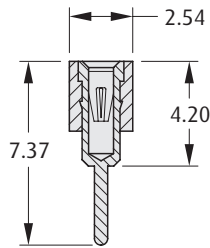
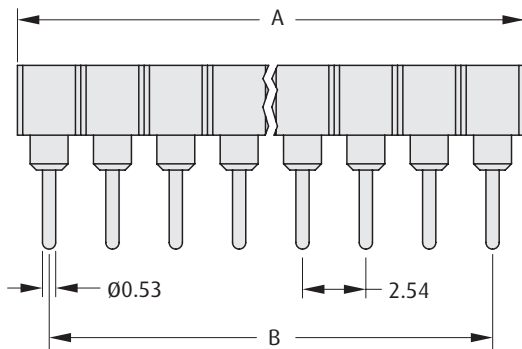

Recommended PC Board Pattern

HOW TO ORDER

D01 - 99 X XX XX

SERIES CODE

TYPE

2	Male
7	Female

FINISH

42	Gold + Tin (Female)	
46	Tin (Male)	

NO OF WAYS PER ROW

20, 32

www.harwin.com

All dimensions in mm.



HARWIN