



### SPECIFICATIONS

<b>MATERIAL</b>	Clip - Polycarbonate, Ring - Polypropylene (U.L. Listed Materials).
<b>DESIGN</b>	Style - Inner, outer reflector, standard clip, (short and extended).
<b>MOUNTING</b>	Mount through front of panel. Mounting holes should be deburred but not chamfered. Hole size .250" (6.35mm), holes on 3/8" centers. Panel thickness for CLP 125, 127 & 129, 1/32" to 1/8". For CLP 126, 1/8" to 1/4". Complete assembly using RNG 268. CLIPMOUNT® CLP 125, 127 & 129 with CONXRITE®, maximum panel thickness .110". With CLP 126, maximum .250" panel thickness.
<b>LEDs</b>	5mm standard or low profile, diffused or non-diffused.

### FEATURES

- Universal, used for mounting all standard 5mm LEDs.
- Low cost installation method for panel mounting LEDs.
- Styles include inner/outer reflector, standard and extended clip types.
- Accommodate panel thickness ranging from .032" to .250".
- LEDs are replaceable when mount is used with CONXRITE® socket.
- Various styles of CLIPMOUNTS® vastly increase the engineer's range of selection.

### CLIPMOUNT

<p><b>WITH RING</b></p>	<p><b>WITH CONXRITE®</b></p>
<p>Snap the CLIPMOUNT® into the panel - Insert LED - Press the ring in place to complete the assembly.</p>	<p>Snap the CLIPMOUNT® into the panel - Insert LED - Press the CONXRITE® socket in place to complete the assembly.</p>



U.S. & Foreign Patents Issued and Pending

### ORDERING CODES

<b>CLP 125</b>		<b>BLK</b>	
<b>MODEL</b>	CLP 125 Standard clip CLP 126 Extended clip CLP 127 Outer reflector clip	CLP 129 Inner reflector clip RNG 268 retaining ring	<b>COLOR</b> BLK Black only

### OUTLINE DRAWINGS

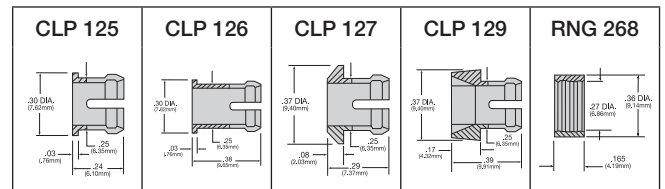

## SOLDERLESS LED CONNECTOR

### SPECIFICATIONS

<b>MATERIAL</b>	Housing - Polypropylene (natural). Terminals - Phosphor bronze, tin plated, compatible with LED leads. Resistor - Melf 1/2 resistor provides current limiting to 28 volts. Panel Mounts - Recommended lense CMC 321 and CMS 322. CLIPLITE® and CLIPMOUNT® are also acceptable mounts. Note - Trim LED lead length to .275" ± .010" (7.24mm).
-----------------	--

### FEATURES

- Internal resistor for 3V to 28V circuits, when external resistor is required or desired, CONXRITE® is available without built-in resistor.
- Requires no tools - provides a simple fast press-fit connection to either CLIPLITE® or CLIPMOUNT®.
- Stress-relieved connection controls the problem of broken LED leads.
- When preassembled to the wiring harness final assembly of the panel mounted LED is greatly simplified.
- Various colored CLIPLITE® lenses are available for use with CONXRITE®.
- Makes field replacement of defective LEDs practical and cost-effective.

### OUTLINE DRAWING

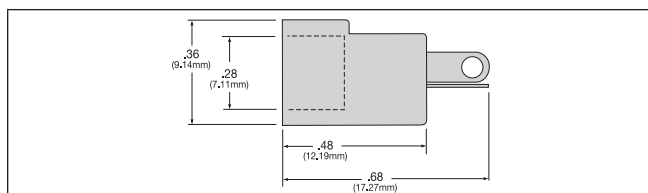

### RESISTOR SELECTOR

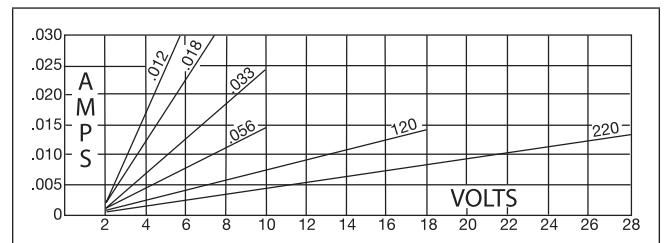

### ORDERING CODES

<b>CNX 310</b>		<b>012</b>	
<b>MODEL</b>			<b>RESISTOR CODE</b>
			CODE VALUE
			000 NO RESISTOR
			012 120 OHMS
			018 180 OHMS
			033 330 OHMS
			056 560 OHMS
			120 1200 OHMS
			220 2200 OHMS