



# Series C82/C92 Standard Dual Beam Solder Tail Edge-Grip Sockets

## FEATURES:

- Dual beam, edge-grip contacts provide high retention with positive wiping action.
- Removable cover provides lower profile.
- Side-to-side stackable.

## SPECIFICATIONS:

- Body is black UL-94V-0 Glass-filled Thermoplastic Polyester (PBT).
- Contact is Grade A spring-tempered Phosphor Bronze.
- Contact plating is either 50-150 $\mu$  [1.27-3.81 $\mu$ ] min. 90/10 Tin/Lead per MIL-T-10727 or 10 $\mu$  [.25 $\mu$ ] min. Gold per MIL-G-45204 in contact area and 50-150 $\mu$  [1.27-3.81 $\mu$ ] min. 90/10 Tin/Lead Alloy per MIL-T-81728 on solder tail, all over 50 $\mu$  [1.27 $\mu$ ] min. Nickel per QQ-N-290.
- Contact current rating=1 Amp.
- Contact resistance=20 mOhms initial.
- Insulation resistance=100 MOhms @ 500 VDC per MIL-STD-1344, method 3003.1.
- Dielectric withstanding voltage=1000 VAC.
- Operating temperature=221°F [105°C] Tin plating, =257°F [125°C] Gold plating.
- Solderability: MIL-STD-202, method 208 less heat aging.
- Accepts leads up to .011 x .018  $\pm$  .003 [.28 x .46  $\pm$  .08] or .021 [.53] diameter.
- Accepts leads .100-.200 [2.54-5.08] long with cover.

## MOUNTING CONSIDERATIONS:

- Suggested PCB hole size=.036  $\pm$  .002 [.91  $\pm$  .05] dia.

**ALL DIMENSIONS: INCHES [MILLIMETERS]**

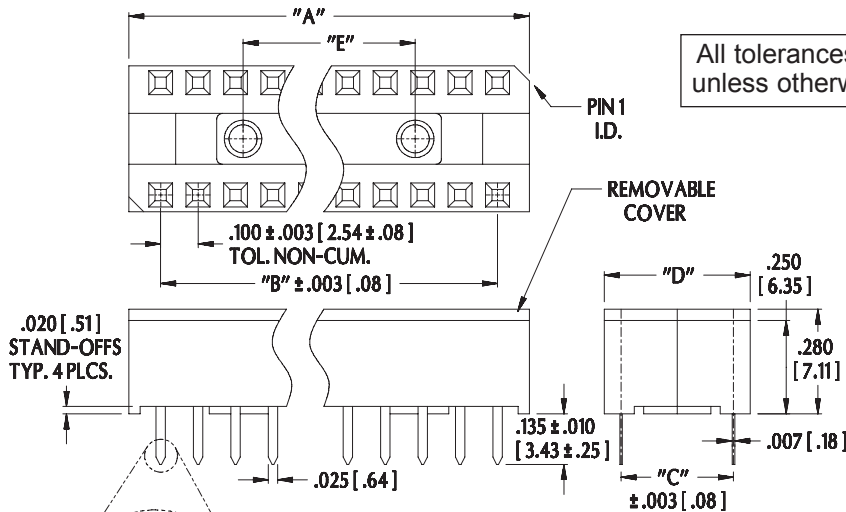

All tolerances  $\pm$  .005 [.13] unless otherwise specified

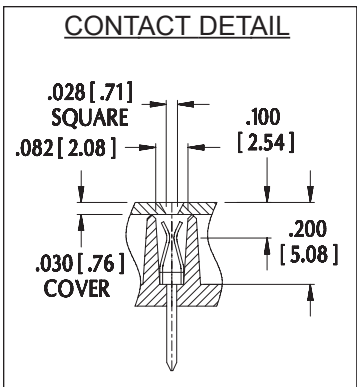

## ORDERING INFORMATION

**C XXXX-XX**

- Socket series: C82 series:  
 Pin plating: 82=Tin, 92=Gold  
 No. of pins (see table)  
 -04=closed entry  
 -54=open entry  
 C92 series:  
 -00=closed entry  
 -50=open entry

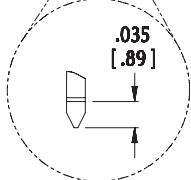

Pin tails can be bent over without breaking for mounting on PCB

No. of Pins	Dim. "A"	Dim. "B"	Centers "C"	Dim. "D" (max)	Dim. "E"
8	.465 [11.81]	.300 [7.62]	.300 [7.62]	.400 [10.16]	---
14	.765 [19.43]	.600 [15.24]	.300 [7.62]	.400 [10.16]	.300 [7.62]
16	.865 [21.97]	.700 [17.78]	.300 [7.62]	.400 [10.16]	.400 [10.16]
18	.965 [24.51]	.800 [20.32]	.300 [7.62]	.400 [10.16]	.400 [10.16]
20	1.065 [27.05]	.900 [22.86]	.300 [7.62]	.400 [10.16]	.400 [10.16]
22	1.180 [29.97]	1.000 [25.40]	.400 [10.16]	.500 [12.70]	.500 [12.70]
24	1.280 [32.51]	1.100 [27.94]	.600 [15.24]	.700 [17.78]	.500 [12.70]
28	1.480 [37.59]	1.300 [33.02]	.600 [15.24]	.700 [17.78]	.500 [12.70]
36	1.880 [47.75]	1.700 [43.18]	.600 [15.24]	.700 [17.78]	.800 [20.32]
40	2.080 [52.83]	1.900 [48.26]	.600 [15.24]	.700 [17.78]	.800 [20.32]

**ARIES**  
 ELECTRONICS, INC.  
<http://www.arieselec.com> • [info@arieselec.com](mailto:info@arieselec.com)

NORTH AMERICA  
 Frenchtown, NJ USA  
 TEL: (908) 996-6841  
 FAX: (908) 996-3891



UK/IRELAND/GB  
 TEL: +44 870 240 0249  
 FAX: +44 1653 690980  
[uking@arieselec.com](mailto:uking@arieselec.com)

EUROPE/MAINLAND/HOLLAND  
 TEL: +31 78 615 94 65  
 FAX: +31 78 615 43 11  
[europa@arieselec.com](mailto:europa@arieselec.com)  
 12002  
 REV.A