

C44U-M, Film, Metallized Polypropylene, DC Link, 165 uF, 10%, 1500 VDC

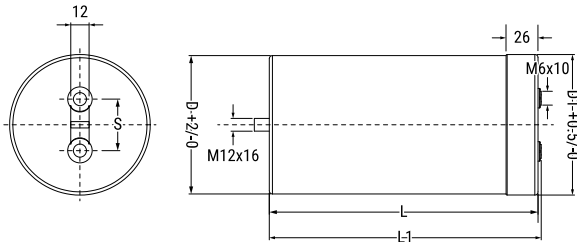

| Dimensions | |
|------------|----------------|
| D | 85mm +2mm |
| L | 124.5mm +/-2mm |
| L1 | 126mm +/-2mm |
| S | 32mm +/-0.3mm |
| D1 | 88mm +0.5mm |

| Packaging Specifications | |
|--------------------------|---------------|
| Mounting: | Bolt - M12x16 |
| Packaging: | Bulk, Bag |
| Packaging Quantity: | 5 |

| General Information | |
|---------------------|---|
| Series: | C44U-M |
| Dielectric: | Metallized Polypropylene |
| Style: | Can |
| Features: | DC Filtering, Energy Storage |
| RoHS: | With Exemptions |
| REACH: | SVHC (Pb – CAS 7439-92-1) |
| SCIP Number: | cc1c1ec4-db9e-4815-b26b-e8a34ddfb776 |
| Lead: | Screw Terminals M6 |
| AEC-Q200: | No |
| Component Weight: | 1020 g |
| Miscellaneous: | Thermal Resistance = 5.8 C/W. Weight = 5100 grams. |

| Specifications | |
|------------------------|---------------------------------------|
| Capacitance: | 165 uF |
| Capacitance Tolerance: | 10% |
| Voltage DC: | 1500 VDC |
| Temperature Range: | -40/+85°C |
| Rated Temperature: | 75°C |
| Insulation Resistance: | 180 MOhms |
| Max dV/dt: | 12 V/us |
| Resistance: | 3.2 mOhms (10kHz) |
| Ripple Current: | 40 Amps (10kHz 40C), 2045 Amps (Peak) |
| Inductance: | 50 nH |

Statements of suitability for certain applications are based on our knowledge of typical operating conditions for such applications, but are not intended to constitute - and we specifically disclaim - any warranty concerning suitability for a specific customer application or use. This Information is intended for use only by customers who have the requisite experience and capability to determine the correct products for their application. Any technical advice inferred from this Information or otherwise provided by us with reference to the use of our products is given gratis, and we assume no obligation or liability for the advice given or results obtained.