

ATW019

Tubular screw terminal block, centerline 10 mm / 0.394 inches, flat base, horizontal wire entry

Technical Data

	V / A / AWG	600 / 30 / 22 - 10
	V / A / AWG	400 / 20 / 18 - 14
	Screw torque	max. 4.4 lbs.-in
	2.5 mm ²	400 V / 24 A
	Screw torque	max. 0.5 Nm
Wire strip length		7.3 mm / 0.287 in.
Pole size		1 to 12
Color		Natural

ATW029

Tubular screw terminal block, centerline 10 mm / 0.394 inches, flat base, horizontal wire entry, wire protector

Technical Data

	V / A / AWG	600 / 30 / 22 - 10
	V / A / AWG	400 / 20 / 18 - 14
	Screw torque	max. 4.4 lbs.-in
	2.5 mm ²	400 V / 24 A
	Screw torque	max. 0.5 Nm
Wire strip length		7.3 mm / 0.287 in.
Pole size		1 to 12
Color		Natural

Dimensions in mm

1 mm = 0.0394 in.

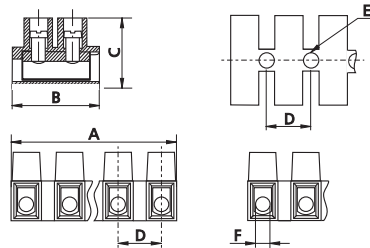

	A	B	C	D	E	F
mm	117.0	20.2	15.8	10.0	3.6	3.2±0.1
inches	4.606	0.795	0.622	0.394	0.142	0.126

Dimensions in mm

1 mm = 0.0394 in.

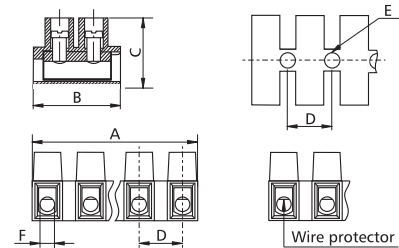

	A	B	C	D	E	F
mm	117.0	20.2	15.8	10.0	3.6	3.2±0.1
inches	4.606	0.795	0.622	0.394	0.142	0.126

Part numbers (P/N)

(informations: page 161)

Complete the part number by adding the pole size.

ATW019

centerline 10 mm / 0.394 inches

P/N ATW019

<input type="checkbox"/>	01	02	03	04	05	06	07	08
<input type="checkbox"/>	09	10	11	12				

Part numbers (P/N)

(informations: page 161)

Complete the part number by adding the pole size.

ATW029

centerline 8 mm / 0.394 inches

P/N ATW029

<input type="checkbox"/>	01	02	03	04	05	06	07	08
<input type="checkbox"/>	09	10	11	12				

Standard pole sizes

Available on demand. Minimum order quantity 5000 pieces per item.

Standard pole sizes

Available on demand. Minimum order quantity 5000 pieces per item.

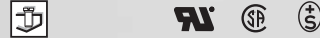

ATW039

Tubular screw terminal block, centerline 10 mm / 0.394 inches, 1.2 mm / 0.047 inches raised base, horizontal wire entry

Technical Data

	V / A / AWG	600 / 30 / 22 - 10
	V / A / AWG	400 / 20 / 18 - 14
	Screw torque	max. 4.4 lbs.-in
	2.5 mm ²	400 V / 24 A
	Screw torque	max. 0.5 Nm
Wire strip length		7.3 mm / 0.287 in.
Pole size		1 to 12
Color		Natural

ATW049

Tubular screw terminal block, centerline 10 mm / 0.394 inches, 1.2 mm / 0.047 inches raised base, horizontal wire entry, wire protector

Technical Data

	V / A / AWG	600 / 30 / 22 - 10
	V / A / AWG	400 / 20 / 18 - 14
	Screw torque	max. 4.4 lbs.-in
	2.5 mm ²	400 V / 24 A
	Screw torque	max. 0.5 Nm
Wire strip length		7.3 mm / 0.287 in.
Pole size		1 to 12
Color		Natural

Dimensions in mm 1 mm = 0.0394 in.

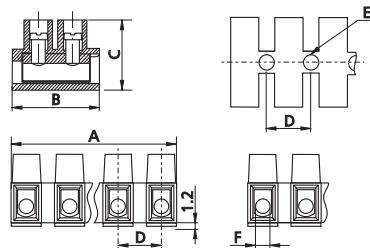

	A	B	C	D	E	F
mm	117.0	20.2	17.0	10.0	3.6	3.4±0.1
inches	4.606	0.795	0.670	0.394	0.142	0.134

Dimensions in mm 1 mm = 0.0394 in.

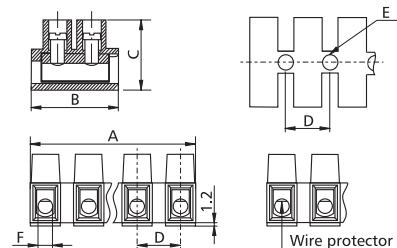

	A	B	C	D	E	F
mm	117.0	20.2	17.0	10.0	3.6	3.4±0.1
inches	4.606	0.795	0.670	0.394	0.142	0.134

Part numbers (P/N)

(informations: page 161)

ATW039

centerline 10 mm / 0.394 inches

P/N ATW039

Complete the part number by adding the pole size.

<input type="checkbox"/>	01	02	03	04	05	06	07	08
<input type="checkbox"/>	09	10	11	12				

Part numbers (P/N)

(informations: page 161)

ATW049

centerline 8 mm / 0.394 inches

P/N ATW049

Complete the part number by adding the pole size.

<input type="checkbox"/>	01	02	03	04	05	06	07	08
<input type="checkbox"/>	09	10	11	12				

- Standard pole sizes
- Available on demand. Minimum order quantity 5000 pieces per item.

- Standard pole sizes
- Available on demand. Minimum order quantity 5000 pieces per item.



ATW059

Tubular screw terminal block, centerline 10 mm / 0.394 inches, 4.3 mm / 0.169 inches raised base, horizontal wire entry

Technical Data

	V / A / AWG	600 / 30 / 22 - 10
	V / A / AWG	400 / 20 / 18 - 14
	Screw torque	max. 4.4 lbs.-in
	2.5 mm ²	400 V / 24 A
	Screw torque	max. 0.5 Nm
Wire strip length		7.3 mm / 0.287 in.
Pole size		1 to 12
Color		Natural

ATW069

Tubular screw terminal block, centerline 10 mm / 0.394 inches, 4.3 mm / 0.169 inches raised base, horizontal wire entry, wire protector

Technical Data

	V / A / AWG	600 / 30 / 22 - 10
	V / A / AWG	400 / 20 / 18 - 14
	Screw torque	max. 4.4 lbs.-in
	2.5 mm ²	400 V / 24 A
	Screw torque	max. 0.5 Nm
Wire strip length		7.3 mm / 0.287 in.
Pole size		1 to 12
Color		Natural

Dimensions in mm 1 mm = 0.0394 in.

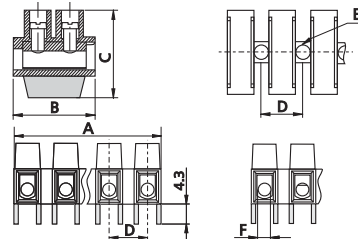

	A	B	C	D	E	F
mm	117.0	20.2	20.10	10.0	3.6	3.2±0.1
inches	4.606	0.795	0.791	0.394	0.142	0.126

Dimensions in mm 1 mm = 0.0394 in.

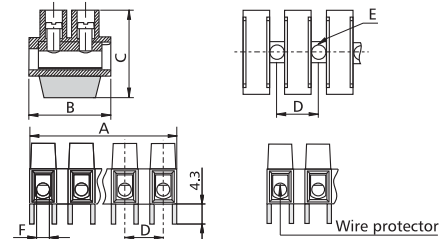

	A	B	C	D	E	F
mm	117.0	20.2	20.1	10.0	3.6	3.2±0.1
inches	4.606	0.795	0.791	0.394	0.142	0.126

Part numbers (P/N)

(informations: page 161)

Complete the part number by adding the pole size.

ATW059

centerline 10 mm / 0.394 inches

P/N ATW059

01	02	03	04	05	06	07	08
09	10	11	12				

Part numbers (P/N)

(informations: page 161)

Complete the part number by adding the pole size.

ATW069

centerline 8 mm / 0.394 inches

P/N ATW069

01	02	03	04	05	06	07	08
09	10	11	12				

- Standard pole sizes
- Available on demand. Minimum order quantity 5000 pieces per item.

- Standard pole sizes
- Available on demand. Minimum order quantity 5000 pieces per item.