

Model T8x16 (DC)

Tubular-Pull

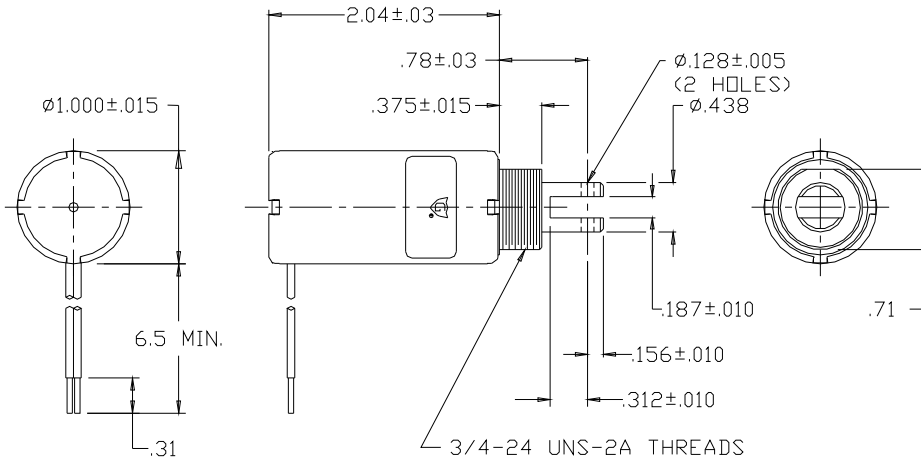

ISO 9001 / AS9100 Certified Company
 Woodstock, IL 60098 Ph. (815)334-3600 Fax (815)337-0377
 Or visit us at our website www.guardian-electric.com



Solenoid shown energized and fully seated.
 Supplied with mounting bracket, hex nut and lockwasher (not shown).
 Spring kits are available (consult factory).

Total Weight: 5.80 oz.
 Plunger Weight: 1.57 oz.

| Model No. | Part No. | Duty Cycle | Voltage | Resistance (Ω) | Power (W) | Current |
|------------|----------------|--------------|---------|----------------|-----------|---------|
| T8x16-I-12 | A420-066643-00 | Intermittent | 12VDC | 9.3 | 16.3 | 1.29 A |
| T8x16-C-12 | A420-066642-00 | Continuous | 12VDC | 28.3 | 5.3 | 424 mA |
| T8x16-I-24 | A420-066645-00 | Intermittent | 24VDC | 36.1 | 16.8 | 665 mA |
| T8x16-C-24 | A420-066644-00 | Continuous | 24VDC | 110 | 5.5 | 218 mA |

When ordering, please refer to Part No., as listed above.
 Consult factory for custom configurations.

| Stroke (in.) | Pull Force (oz.) | | | | | | | | Holding Force (oz.) |
|-------------------|------------------|-------|-------|-------|-------|-------|-------|-------|---------------------|
| | 0.050 | 0.125 | 0.250 | 0.375 | 0.500 | 0.625 | 0.750 | 1.000 | |
| Continuous Duty | 30 | 18 | 11 | 5 | 4 | 3 | 2 | n/a | 103 |
| Intermittent Duty | 60 | 40 | 25 | 19 | 15 | 10 | 8 | n/a | 125 |

UL Recognition

Recognized under the  Component Recognition Program of **Underwriters Laboratories, Inc.**

Continuous Duty

100% 'On' Time

Intermittent Duty

25% 'On' Time, (100 Seconds 'On' Max.
 Followed By 300 Seconds 'Off' Min.)

RoHS

These parts comply with **RoHS** Directive 2002/95/EC

Model T8x16 (DC)

