

Dimensions

Positions	A	B	C	D
06	7.62	5.08	10.16	7.62
08	10.16	7.62	10.16	
14	17.78	15.24	10.16	
16	20.32	17.78	10.16	
18	22.86	20.32	10.16	
20	25.40	22.86	10.16	

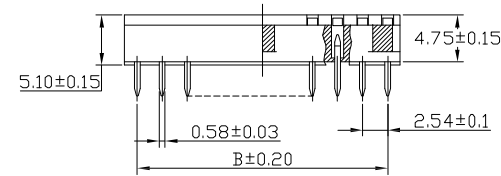

①

Positions	A	B	C	D
24	30.48	27.94	17.78	15.24
28	35.56	33.02	17.78	
32	40.64	38.10	17.78	
40	50.80	48.26	17.78	
48	60.96	58.42	17.78	

**Material:**

Contact:  
Phosphor Bronze thickness 0.15mm  
Plating:  
Contact Plating, Tin plated 60u"~80u"  
Insulator:  
PBT-4830, UL 94V-0

**SPECIFICATIONS:**

Current Rating:1A  
Dielectric withstanding Voltage:1000v  
RMS/minute  
Insulator resistance:5000 Megohms min.  
Contact resistance:20 milliohms initial  
30 milliohms after test.  
Operating temperatures:-55°C to 85°C  
Insertion force:340g(12 oz)max.per contact.  
Withdrawal force:80g(2.82 oz)min.per contact.

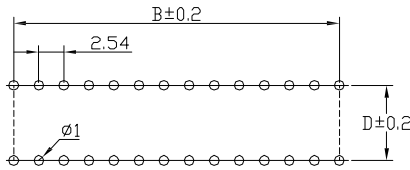

PCB Layout

**RoHS compliant**  
Unit: mm

Scale	FREE						Date	Name	Customer-No.
TOLERANCE						Drawn	26.05.2014	Ray	ASSMANN WSW-No. <b>Axx-LC-TR</b>
X.	±0.38					Approved	29.07.2014	Amy	
X.X	±0.25								
X.XX	±0.13								
DIM	TOL	①	Update the drawing	29.07.2014	Amy	<b>ASSMANN</b> WSW components		Drawing-No.	ASS 6449 CO rev01
Angle	±3°	②	Drawn	26.05.2014	Ray			Replace	
Angle	TOL	Id.	Modification	Date	Name			Sheet	

1

2

3

4

5

6

7