

A T L A S

F O O T S W I T C H



- ▶ The LINEMASTER® Atlas foot switch is a great option whether you are a domestic O.E.M. seeking to expand your export business or an overseas manufacturer looking for world-class quality. This Heavy Duty foot switch was designed for the most demanding industrial and commercial applications and environments. The Atlas takes the weight of the world off your shoulders by delivering reliable performance plus legendary durability. Its snap action with forced disconnect (positive break) on NC contacts meets European as well as U.S. standards. A side entry design was developed to support multi-pedal requests. Only from LINEMASTER® - American made innovation at work.



LINEMASTER Switch Corporation
Tel (860) 974-1000

29 Plaine Hill Road, P.O. Box 238
Woodstock, Connecticut 06281-0238 USA
Fax (800) 974-FOOT(3668)

FEATURES:

- Snap Action - SPDT and DPDT with forced disconnect (positive break) on NC contacts.
- Slow Action mechanism with forced disconnect on the NC contacts. Available as SPDT make before break or break before make.
- Direct PLC interface compatible (two-circuit bifurcated contact single-pole versions)
- Galvanically isolated bifurcated contacts - NO and NC circuits can be wired to different loads and polarities.
- Oversized “O” and “OX” shield models accept oversized safety shoes and metatarsal foot guards. The “OX” shield has an additional 3/4” (19.1 mm) opening height as compared to the “O” shield.
- Larger foot pedal for more positive control.
- Single PG 16 threaded conduit entry is standard. U.S. and other international conduit sizes and side entry for twin or triple interconnect available by special order.
- 3 holes provided for rigid mounting to the floor or equipment.

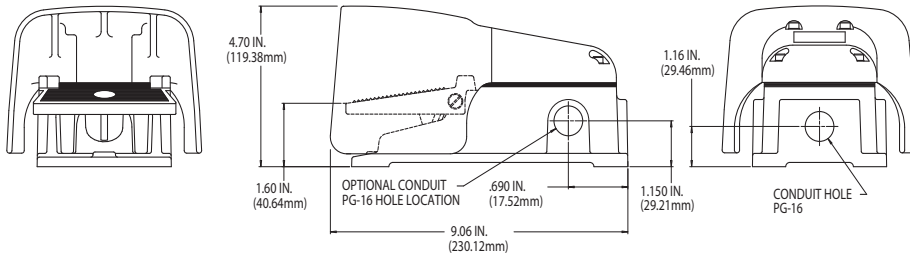
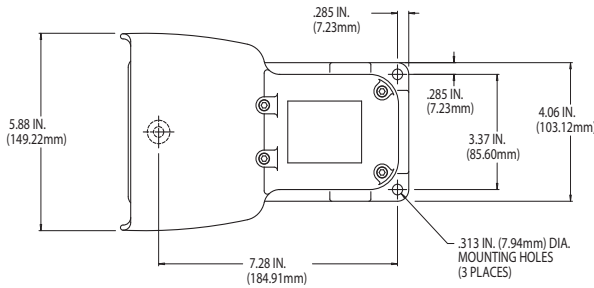

Full Shield Dimension Sheet shown for reference. Height with “O” shield, “OX” shield, and No shield are as follows:

- “O” Shield Height = 5.37 in
- “OX” Shield Height = 6.12 in
- No shield Height = 3.50 in

(Each Switch approx. 5lbs)

| Agency Approvals | EN 60529 Degree of Protection | Full Shield | “O” Shield | “OX” Shield | Without Guard | Circuit | Electrical Ratings |
|------------------|-------------------------------|------------------------|-------------------------|--------------------------|------------------------|--------------------------------------|---|
| cULus TUV CE | IP68 | 936-SWH | 936-SWHO | 936-SWHOX | 936-SWN | SPDT-SNAP Action | A300, Q300: Ith = 10A (AC) Ith = 2.5A (DC) AC15: Ue = 240V; le = 3A Ue = 120V; le = 6A DC13: Ue = 250V; le = 0.27A Ue = 120V; le = 0.55A Ue = 24V; le = 2.5A |
| cULus TUV CE | IP68 | 936-SWHC4 ¹ | 936-SWHOC4 ¹ | 936-SWHOXC4 ¹ | 936-SWNC4 ¹ | SPDT-SNAP Action | |
| cULus TUV CE | IP68 | 936-SWHBM ² | 936-SWHOBM ² | 936-SWHOXB ² | 936-SWNB ² | SPDT-SLOW Action BBM ² | |
| cULus TUV CE | IP68 | 936-SWHMB ³ | 936-SWHOMB ³ | 936-SWHOXMB ³ | 936-SWNB ³ | SPDT-SLOW Action MBB ³ | |
| cULus CE | IP68 | 937-SWH | 937-SWHO | 937-SWHOX | 937-SWN | DPDT-SNAP Action | |
| cULus CE | IP68 | 937-SWHC4 ¹ | 937-SWHOC4 ¹ | 937-SWHOXC4 ¹ | 937-SWNC4 ¹ | DPDT-SNAP Action | |

¹C4 designates a single 3/4” - N.P.T. Conduit Entry ²Break Before Make ³Make Before Break