



Ordering Information

Part Number	Configuration
901-10565	SMA Jack to SMA Quick-Connect Plug

Overview

The SMA Quick-Connect adapter, a straight jack to straight plug configuration, is a precision machined 50 ohm adapter which offers excellent electrical performance through 18 GHz. This adapter dramatically reduces the time necessary for mating and un-mating by eliminating the need to fully thread on the interface. This adapter converts any standard SMA plug test cable into a Quick-Connect cable without compromising the electrical integrity of the assembly. This SMA Quick-Connect adapter is compatible with all previously released threaded SMA jack and plug connectors.

Features and Benefits

- Increases efficiency by reducing time and effort
- No tooling required for mating/un-mating
- Compatible with all threaded SMA connectors
- Converts any standard SMA plug test cable into a Quick-Connect cable

Instructions:

1. With the barrel in the back position, slide the cabled adapter on to the jack receptacle, over the jack threads, by pushing on the back of the knurled body.
2. While gently pressing the knurled body forward, snap the barrel forward to engage the adapter with the threads of the jack connector.
3. Once the barrel is fully snapped forward, turn the indicated knurled body in order to obtain the fully mated interface. A complete mate can be obtained with one full turn or less.
4. Un-mate the adapter by slightly loosening the threads by turning the indicated knurled body. Then pull the barrel into the snapped back position and remove the adapter.

Applications

- Test Equipment
- PCB Test Boards
- Microwave Subsystems
- Base Stations
- Mobile Radios

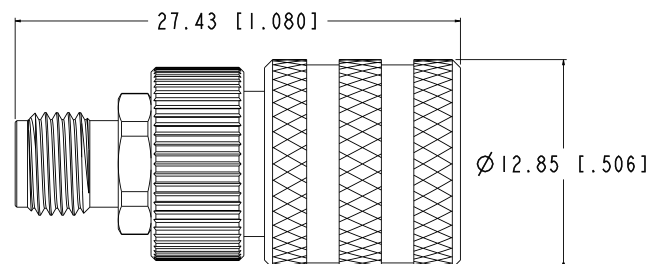

Amphenol RF

Four Old Newtown Road
Danbury, CT 06810

For more information visit www.amphenolrf.com
or call 800.627.7100

Amphenol® RF

Technical Specifications

Electrical

Impedance	50 Ω
Frequency Range	DC - 18 GHz
VSWR (Return Loss)	1.05+0.005*F DC - 18GHz
Dielectric Withstanding Voltage/Insulation	1500 VRMS Min.
Insertion Loss	0.15 dB Max. @6 GHz

Environmental

Temperature Range	-65°C to +165°C
-------------------	-----------------

Mechanical

Mating	Push-Turn Thread On, Pull Off
Durability	500 Cycles Min.

Materials

Body	Brass, Gold Plating
Contact	Beryllium Copper, Gold Plating
Insulator	PTFE

Related Product

ATC-PS Test Cables

20 GHz SMA Phase Stable Cable Assemblies

Ordering Information



SMA Plug to SMA Plug

Part Number	Length (in)	Length (mm)	Insertion Loss (max)
095-902-466-001	24.00	610	1.84 dB
095-902-466-002	36.00	914	2.61 dB
095-902-466-005	39.37	1000	2.84 dB
095-902-466-003	48.00	1219	3.37 dB
095-902-466-004	72.00	1829	4.90 dB



Amphenol RF

Four Old Newtown Road
Danbury, CT 06810

For more information visit www.amphenolrf.com
or call 800.627.7100